



To Reawaken in New Orleans

To study literature is to reawaken an author's words into a new reality: our own. In turning the text over in our own minds, we turn our attention from the understanding that reading alone brings us. We begin to manipulate the text ourselves, reaching in and pulling new meanings, deeper comprehension, from the words.

Our works—whether critical or creative, particular or comprehensive—become fodder for others' reconsideration. And thus begins a new cycle, with that audience turning our ideas over in their minds, manipulating our texts to extract further meaning themselves.

But perhaps most compelling for those of us who study English is that, through conversations with other writers and readers and thinkers, we renew our sense of ourselves, of what it means to love literature and language. At the upcoming 2012 Convention, we reawaken yet again, this time in a forum where our ideas move beyond us, find audience themselves, and return to us reborn, rejuvenated.

Shannin Schroeder
2012 Convention Chair



SIGMA TAU DELTA
INTERNATIONAL ENGLISH HONOR SOCIETY

Acknowledgements

Reviewers

Michel Aaij	Auburn University, Montgomery
Simone Billings	Santa Clara University
Elizabeth Bissette	University of North Carolina, Wilmington
Kathryn Brewer	Stillman College
Melissa Caldwell	Eastern Illinois University
Sarah Clere	Mount Olive College
Dean Cooledge	University of Maryland, Eastern Shore
Robert E. Crafton	Slippery Rock University
Lillian Craton	Lander University
Marybeth Davis	Texas A&M University, Corpus Christi
Sara K. Day	Southern Arkansas University
Marybeth DeMeo	Alvernia University
Blessing Diala-Ogamba	Coppin State University
Becky DiBiasio	Assumption College
Carrie Fitzpatrick	Alvernia University
Hannah Freeman	University of Pikeville
James Guignard	Mansfield University
Christine Hait	Columbia College, South Carolina
Rebecca Hamlett	William Jewell College
Gloria Hochstein	University of Wisconsin, Eau Claire
Henry Hood	Jarvis Christian College
Andrea Ivanov-Craig	Azusa Pacific University
Judith John	Missouri State University
William C. Johnson	Northern Illinois University
Margaret E. Mahoney	College of Notre Dame
Amberly Malkovich	Concord University
Shirley Manigault	Winston-Salem State University
Jamie McDaniel	Pittsburg State University
Matthew Nelson	Francis Marion University
Kathy Nixon	American University of Kuwait
Susan Nyikos	Utah State University
Martha Perkins	Olivet College
Jennifer Peterson	Morningside College
Cherri Randall	University of Pittsburgh, Johnstown
Jane Rose	Purdue University North Central
Peter Scholl	Luther College
Shannin Schroeder	Southern Arkansas University
Erica Scott	Slippery Rock University
Julianne Smith	Pepperdine University
Roger Stanley	Union University
Felicia Steele	The College of New Jersey
Diane Steinberg	The College of New Jersey
Kevin Stemmler	Clarion University
Traci Thomas-Card	University of Wisconsin, Eau Claire
Linda G. Tucker	Southern Arkansas University
Marsha Walker	Johnson C. Smith University
Sidney Watson	Oklahoma Baptist University
Wendy Weaver	Mount Mary College

Convention Organizers

Shannin Schroeder	2012 Convention Chair
Gloria Hochstein	2013 Convention Chair
Traci Thomas-Card	Sponsor Workshop Facilitator
Dave Wendelin	NEHS Director
Sheila Byrd	Sigma Kappa Delta
Karlyn Crowley	Sigma Tau Delta Editor
Epsilon Theta Chapter	Southern Arkansas University

Student Leadership Committee

Alexandra Reznik	Student Advisor
Kelsey Hixson-Bowles	Student Advisor
Amy Woody, SR	Eastern Region
Sarah Faulkner, SR	Far Western Region
Janine Brooks, SR	High Plains Region
Ashlyn Wells, SR	Midwestern Region
Karisa Hernandez, ASR	Midwestern Region
MeKoi William Scott, SR	Southern Region
Allie Martin, ASR	Southern Region
Jolie Hicks, SR	Southwestern Region
Katherine Williams, ASR	Southwestern Region
Deborah Dessaso, AR	Alumni Epsilon Chapter
Lauren Brandeberry, AAR	Alumni Epsilon Chapter

Host Chapter

Alpha Beta Upsilon	Tulane University
--------------------	-------------------

Convention Contributors

Better World Books	Convention Book Sales
Steven Barclay Agency	Name Badge Pouches

Central Office

William C. Johnson	Executive Director
Deb Seyler	Director of Communications and Chapter Development
Dave Wendelin	Director of National English Honor Society (NEHS)
Karen Larsen	Office Manager
Elfi Gabriel and Josh Wilkin	Web Facilitators
Lauren Brandeberry	Project Coordinator

Table of Contents

Convention At-A-Glance	2 - 3
Featured Speakers	4 - 5
Concurrent Sessions	6 - 49
Index of Session Chairs	50
Index of Presenters and Roundtable Participants	51 - 57
Index of Session Moderators	58 - 59
Chapter Sponsor Workshop and Luncheon	60
Student Leadership Workshops	61
Student Leadership Position Descriptions	62
Alumni Leadership Position Descriptions	63
General Business Session and Regional Caucuses	64
2011 Chapter Anniversaries	65 - 67
2011 Sponsor Anniversaries	68 - 69
Board of Directors, Student Leadership, Central Office	70
Where to Eat in NOLA	71 - 72
About New Orleans	73
Convention Twitter Contest	74
Sigma Tau Delta Journals	75
English Honor Societies	76
2013 Convention and Common Reader	77
Hotel Maps	Centerfold
Convention Highlights	Back Cover

Convention At-A-Glance

Wednesday, February 29

- 3:00-8:00** **Registration**
Mardi Gras Foyer, 3rd floor
- 7:00-8:20** **Pre-Convention Literacy Celebration
with Naomi Shihab Nye**
Mardi Gras Ballroom, 3rd floor
- 8:30-9:30** **Naomi Shihab Nye Book Signing for
NEHS Visitors**
Mardi Gras Ballroom, 3rd floor
- The Rectangle* Reading**
Mardi Gras Ballroom, 3rd floor
- 9:30-10:30** **Open Mic**
Mardi Gras Ballroom, 3rd floor

Thursday, March 1

- 7:00-6:00** **Registration**
Acadia Foyer, 3rd floor
- 8:00-9:15** **Concurrent Session A**
Breakout Rooms
- 9:30-10:45** **Concurrent Session B**
Breakout Rooms
- Student Leadership Workshop #1:
English Majors Beyond English**
Carondelet, 3rd floor
- 11:00-12:15** **Concurrent Session C**
Breakout Rooms
- Sponsor Workshop**
Balcony K, 4th floor
- 12:00-9:00** **Outstanding Chapter Displays**
4th floor foyer
- 12:20-1:30** **Lunch (on your own)**
- 1:30-2:45** **Concurrent Session D**
Breakout Rooms
- Workshop with Naomi Shihab Nye**
Acadia, 3rd floor
- 3:00-4:15** **Naomi Shihab Nye Book Signing**
Carondelet, 3rd floor
- Concurrent Session E**
Breakout Rooms
- 4:30-5:20** **Awards Ceremony: Anniversaries,
Academic Awards, and Scholarships**
Acadia/Bissonet, 3rd floor

- 5:20-5:50** **Informal Regional and Alumni Caucuses**
Acadia/Bissonet, 3rd floor
- 5:30-7:00** **Sigma Kappa Delta Meet and Greet**
Meet in Hotel Lobby
- 6:00-7:20** **Dinner (on your own)**
- 7:30-8:50** **Anthony Doerr, Featured Speaker**
Acadia/Bissonet, 3rd floor
- 9:00-10:30** **Dry T-Shirt/Bad Poetry Contests**
Acadia/Bissonet, 3rd floor

Friday, March 2

- 7:00-2:00** **Registration**
Acadia Foyer, 3rd floor
- 7:30-2:00** **Chapter Merchandise Sales**
Acadia Foyer, 3rd floor
- 8:00-9:15** **Concurrent Session F**
Breakout Rooms
- Workshop with Anthony Doerr**
Acadia, 3rd floor
- 9:00-9:00** **Outstanding Chapter Displays**
4th floor foyer
- 9:30-10:45** **Concurrent Session G**
Breakout Rooms
- Student Leadership Workshop #2:
Graduate School How-To**
Carondelet, 3rd floor
- Anthony Doerr Book Signing**
Bissonet, 3rd floor
- 11:00-12:15** **General Business Meeting/
Regional Caucuses**
Acadia/Bissonet, 3rd floor
- Southern Caucus**
Acadia, 3rd floor
- Eastern Caucus**
Carondelet, 3rd floor
- Far Western Caucus**
Balcony N, 4th floor
- High Plains Caucus**
Balcony L, 4th floor
- Midwestern Caucus**
Bissonet, 3rd floor
- Southwestern Caucus**
Balcony J, 4th floor

Convention At-A-Glance

Friday, March 2, continued

- 11:45-1:30** **Sigma Kappa Delta Kraeger Awards Luncheon**
Meet in Hotel Lobby
- 12:20-1:30** **Lunch (on your own)**
- 12:30-1:15** **Regents and Sponsors Luncheon**
La Galerie 3, 2nd floor
- 1:15-2:30** **Regents and Sponsors Guest Speaker Emily Toth**
La Galerie 3, 2nd floor
- 1:45-3:00** **Concurrent Session H**
Breakout Rooms
- 3:15-4:30** **Concurrent Session I**
Breakout Rooms
- Resume Writing Workshop Hosted by Alumni Epsilon**
Carondelet, 3rd floor
- 4:45-5:00** **Alumni Caucus**
Napoleon, 41st floor
- 4:45-6:00** **Student Leadership Workshop #3: Officers Roundtable**
Carondelet, 3rd floor
- 5:00-6:00** **President's Reception for Faculty and Alumni**
Riverview, 41st floor
- 6:00-7:20** **Dinner (on your own)**
- 7:30-8:50** **Natasha Trethewey, Featured Speaker**
Acadia/Bissonet, 3rd floor
- 9:00-10:00** **Host Chapter Event Sponsored by Tulane University**
Carondelet, 3rd floor
- Natasha Trethewey Book Signing**
Acadia, 3rd floor

Saturday, March 3

- 7:00-12:00** **Registration**
Acadia Foyer, 3rd floor
- 7:30-2:00** **Chapter Merchandise Sales**
Acadia Foyer, 3rd floor
- 8:00-9:15** **Concurrent Session J**
Breakout Rooms
- 9:00-12:00** **Outstanding Chapter Displays**
4th floor foyer
- 9:30-10:45** **Concurrent Session K**
Breakout Rooms
- Student Leadership Workshop #4: Building Interchapter Relations**
Carondelet, 3rd floor
- 11:00-12:15** **Concurrent Session L**
Breakout Rooms
- Workshop with Natasha Trethewey**
Acadia, 3rd floor
- Sigma Kappa Delta Faculty Sponsor Meeting**
Audubon, 5th floor
- 12:20-1:30** **Lunch (on your own)**
- 1:45-3:00** **Concurrent Session M**
Breakout Rooms
- Student Leadership Workshop #5: Recruitment and Retention**
Carondelet, 3rd floor
- Songwriting Workshop with Singer/Songwriter Tom Kimmel**
Acadia, 3rd floor
- 3:15-4:30** **Concurrent Session N**
Breakout Rooms
- 5:00-5:45** **Reception Hosted by Student Leadership**
Mardi Gras Ballroom, 3rd floor
- 6:00-8:00** **Red & Black Gala Dinner and Convention Awards**
Bissonet/Carondelet, 3rd floor

Featured Speakers

Naomi Shihab Nye

Wednesday, February 29, 7:00 - 8:20 p.m. (Mardi Gras Ballroom)
Pre-Convention Literacy Celebration (sponsored by NEHS)

Thursday, March 1, 1:30 - 2:45 p.m. (Acadia)
Workshop, followed by a book signing (*Carondelet*)

Naomi Shihab Nye is a Palestinian-American writer, speaker, and educator who has authored or edited more than 30 works and whose works draw from her own heritage and from 37 years of traveling around the world. Her poetry has appeared in such works as *Atlantic*, *Iowa Review*, and *Ploughshares*, and her collections include *Red Suitcase*, *Fuel*, and *You & Yours*, which was a best-selling poetry book for 2006. Nye, who has been a visiting writer for The Michener Center at the University of Texas at Austin and at the University of Hawai'i, also writes works for children and for young adults, among them *A Maze Me: Poems for Girls* and the novel *Habibi*. Her newest volume of poetry, *Transfer*, and a short story collection (*There Is No Long Distance Now*) are forthcoming in winter 2012. Among her awards Nye counts a Lannan Fellowship, a Guggenheim Fellowship, and four Pushcart Prizes, and she has appeared on *NOW with Bill Moyers*.



Anthony Doerr

Thursday, March 1, 7:30 - 8:50 p.m. (Acadia/Bissonet)
Reading

Friday, March 2, 8:00 - 9:15 a.m. (Acadia)
Workshop, followed by a book signing (*Bissonet*)

Anthony Doerr writes short fiction, book reviews, and a regular column for the *Boston Globe*, as well as teaching in the low-residency MFA program at Warren Wilson College. His fiction has been anthologized in such collections as *The Best American Short Stories* and *The Scribner Anthology of Contemporary Short Fiction* and has garnered him numerous prizes, including four O. Henry Prizes, two Pushcart Prizes, and the Rome Prize. Doerr has received a Guggenheim Fellowship and an NEA Fellowship, and his books have been listed among the *New York Times* Notable Books (*The Shell Collector* and *Memory Wall*). *Granta* named him on its 2007 list of 21 Best Young American novelists. In addition to his novel *About Grace*, Doerr has published a creative work of nonfiction called *Four Seasons in Rome: On Twins, Insomnia, and the Biggest Funeral in the History of the World* and two short story collections, *The Shell Collector* and *Memory Wall*.

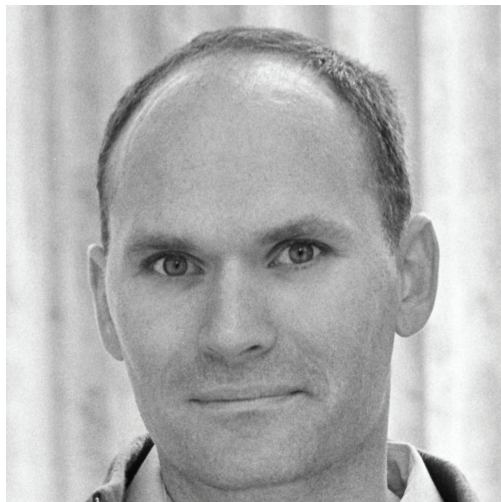



Natasha Trethewey

Friday, March 2, 7:30 - 8:50 p.m. (*Acadia/Bissonet*)

Reading, followed by a book signing

Saturday, March 3, 11:00 a.m. - 12:15 p.m. (*Acadia*)

Workshop

Natasha Trethewey is the Phillis Wheatley Distinguished Chair in Poetry and Professor of English at Emory University. Trethewey's works have appeared in such journals as *Callaloo* and *American Poetry Review*. Her first collection, *Domestic Work*, won numerous awards, including the first Cave Canem poetry prize in 1999. She received the 2007 Pulitzer Prize for her work *Native Guard*, and *Thrall*, her fourth collection of poetry, comes out in 2012. She is also the author of *Beyond Katrina: A Meditation on the Mississippi Gulf Coast*, a collection of creative non-fiction. Her awards and honors include fellowships from the Guggenheim Foundation, the Rockefeller Foundation, and the National Endowment for the Arts; she was named the 2008 Georgia Woman of the Year. Trethewey's second collection, *Bellocq's Ophelia*, is the Common Reader for the 2012 Convention.



SKD Song Writing Workshop

Tom Kimmel

Saturday, March 3, 1:45 - 3:00 p.m. (*Acadia*)

(sponsored by Sigma Kappa Delta)

Singer, songwriter, entertainer, poet and teacher, Tom Kimmel is all of these things and more than their sum. Since 1980 dozens of Tom's compositions have been recorded by a host of major artists, including Linda Ronstadt, Johnny Cash, Joe Cocker, Shawn Colvin, and Randy Travis. They've been featured in films from *Twins* to *Serendipity* and *Runaway Bride*, and in television shows from *Captain Kangaroo* and *Touched By An Angel* to *Dawson's Creek*. An award winning artist in his own right, he has released seven solo albums, published a book of poems, and led songwriting workshops and classes around the country and in Europe.

Concurrent Sessions

Session A: Thursday, March 1, 8:00-9:15 a.m.

A-1. Creative Nonfiction: Sense of Humor Thursday 8:00-9:15 Regent, 4th floor

Moderator: Melissa Caldwell, Eastern Illinois University (IL)

Chair: Kyrie Bair, Baker University (KS)

Kimberly Galovich, Eastern Illinois University (IL): My Big, Fat, Armenian Family

Kelly Grooms, Shawnee State University (OH): Ballad of Beaumont

Jolie Hicks, Southwestern Oklahoma State University (OK): If They Ask, I Will Tell Them

Rachel Robins, Dixie State College of Utah (UT): The Composition of a Lie

A-2. Original Poetry: Inspired Thursday 8:00-9:15 Bacchus, 4th floor

Moderator: Diane Steinberg, The College of New Jersey (NJ)

Chair: Katelyn Richardson, College of Notre Dame of Maryland (MD)

Romeo Garcia, Texas A&M University, Corpus Christi (TX): A Mixed Variety of Poems

Eddie Generazio, Virginia Wesleyan College (VA): The Infantasizing Life!

Shayna Gonsalves, Pace University, New York Campus (NY): fits of rapture (or despair)

Jenna Lanzaro, The College of New Jersey (NJ): The Name Book: Words about Persephone, Persipina, or the Queen of the Underworld

Eugenia Purcar, Pepperdine University (CA): *Helado*: Instant Messages from South America

A-3. Original Fiction: Fictions of Faith Thursday 8:00-9:15 Balcony I, 4th floor

Moderator: Mary Stover, Allen University (SC)

Chair: Kelli Wilson, Ouachita Baptist University (AR)

Anessah Brown, Allen University (SC): The Soul

Danielle Koch, Luther College (IA): A Sermon from Earth

Rebecca Smith, Stephen F. Austin State University (TX): Good Christian

Brian Talbert, Rockhurst University (MO): Faith Alone: Chapter 6

A-4. Social Discourse in Restoration and/or 18th Century British Literature Thursday 8:00-9:15 Balcony J, 4th floor

Moderator: Ken McGraw, Roanoke College (VA)

Chair: Kayla Hare, University of Alabama (AL)

Megan Bruening, Roanoke College (VA): Reawakening Female Control in Courtship

Christopher Hart, Western Michigan University (MI): Latitude and Longitude

Courtney Rooney, Tulane University (LA): The Pervasiveness of Social Discourses in Poems by Robert Herrick, Oliver Goldsmith, and George Crabbe

Hannah Ryan, University of Southern Mississippi, Hattiesburg (MS): "Sufficient to stand but free to fall": Rhetorical Discernment, Liberty, and Civic Salvation in John Milton's *Paradise Lost*

Concurrent Sessions

A-5. Women and British Literature

Thursday 8:00-9:15

Balcony K, 4th floor

Moderator: Rebecca Belcher-Rankin, Olivet Nazarene University (IL)

Chair: Austin Hall, Westfield State College (MA)

Jane Alford, University of Montevallo (AL): The Object Dispossessed

Kayla Beauduy, Western Carolina University (NC): *Orlando*: Woolf's Parody of Essentialism

Sarah Jensen, Olivet Nazarene University (IL): Juliet: Wife or Whore?

Tanya Schmidt, Santa Clara University (CA): Hero's Resistance Against Patriarchal Oppression in *Much Ado About Nothing*

A-6. Far from Home: Literature By and About Expatriates

Thursday 8:00-9:15

Balcony L, 4th floor

Moderator: Christine Hait, Columbia College, South Carolina (SC)

Chair: Leslie Manning, Auburn University, Montgomery (AL)

Keelan Fagan, Columbia College, South Carolina (SC): What, Then, Is an American Expatriate? A Character Analysis of the Male Expatriate in Hemingway and Fitzgerald

Corey Hamilton, University of Central Oklahoma (OK): As the Screw Turns

Justina Salassi, University of Louisiana, Monroe (LA): Naming Without Naming: Gertrude Stein's Poetic Language

Seth Wermager, Liberty University (VA): The Alarming Implications of Newman and Noemie's Analysis of Art

A-7. Latin American Women Writers

Thursday 8:00-9:15

Balcony M, 4th floor

Moderator: Patricia Harkins-Pierre, University of the Virgin Islands (VI)

Chair: Caitlin Larracey, Bridgewater State University (MA)

Casey Boersma, Tulane University (LA): Recalculating Guilt: The Reparation of Lispector's Mathematics Professor

Brian Hartt, The College of New Jersey (NJ): Tall Tales: Meta-Narrative in *Eva Luna*

Katie Smith, Liberty University (VA): Non-Linear Time and Allende's Female Storytellers

A-8. From Building to Rebuilding

Thursday 8:00-9:15

Balcony N, 4th floor

Moderator: Gillian Paku, SUNY, College at Geneseo (NY)

Chair: Kristina Epperson, Minot State University (ND)

John Breerwood, New Mexico Highlands University (NM): Utopian Discourse Reawakens New Orleans After Hurricane Katrina

Jesse Goldberg, SUNY, College at Geneseo (NY): Sacrificial Expenditure: Race and the 2008 Housing Crisis

Stasia Monteiro, SUNY, College at Geneseo (NY): Don't Ask Questions

A-9. Roundtable - Reawaken with *Belloq's Ophelia*

Thursday 8:00-9:15

Bonaparte, 4th floor

Moderator: AmiJo Comeford, Dixie State College of Utah (UT)

Roundtable Participants:

Katie Hulett, Dixie State College (UT)

Jason Jones, Alumni Epsilon Chapter, Dixie State College (UT)

Ryan Rarick, Alumni Epsilon Chapter, Dixie State College (UT)

Abstract: Roundtable participants will facilitate a discussion of the theme of reawakening in *Belloq's Ophelia*. How the reader reawakens to a new, previously untold history; how the protagonist Ophelia reawakens herself; and how the camera is an essential tool for these reawakenings.

Concurrent Sessions

Session B: Thursday, March 1, 9:30-10:45 a.m.

B-1. Creative Nonfiction: Along for the Ride Thursday 9:30-10:45 Regent, 4th floor

Moderator: Joy Moore, Union University (TN)

Chair: Jodi Ierien, University of Texas, San Antonio (TX)

Hayley Burdett, Minnesota State University, Moorhead (MN): MSP

Joshua Garcia, Union University (TN): America

Summer Mosgofian Barry, Dixie State College of Utah (UT): Moving Between Heaven and Hell

Ryan Rarick, Dixie State College of Utah (UT): The Freedom Ride

B-2. Original Poetry: In Relation to Thursday 9:30-10:45 Bacchus, 4th floor

Moderator: Gillian Paku, SUNY, College at Geneseo (NY)

Chair: Michael Murray, John Carroll University (OH)

Joseph Gerlick, Metropolitan State College of Denver (CO): Poem of Androgynous Love

Nancy Lilia Gonzalez Duran, St. Edward's University (TX): Deep Fried Love Poems

Gabrielle Gosset, SUNY, College at Geneseo (NY): Ischemia

Lauren Hall, Marist College (NY): The Self Found in Space of Relationships

Lindsay Young, St. Edward's University (TX): The Start

B-3. Original Fiction: A Humorous Take Thursday 9:30-10:45 Balcony I, 4th floor

Moderator: Andrea Ivanov-Craig, Azusa Pacific University (CA)

Chair: Sheila Lansdale, University of Southern Mississippi Gulf Coast (MS)

Kathrine Biggs, Southwestern Oklahoma State University (OK): Meatloaf's Last Stand

Allison Hamil, University of Alabama (AL): The Closet

Natalie Romero, La Sierra University (CA): Tall, Dark, and Handsome

Erin Shishido, Azusa Pacific University (CA): Catching Smiles

B-4. Anglo Saxon and Medieval British Literature: Thursday 9:30-10:45 Balcony J, 4th floor

Arthur, Arthur!

Moderator: AmiJo Comeford, Dixie State College of Utah (UT)

Chair: Kimberly Shelton, Blue Mountain College (MS)

Brendan Flanagan, Ramapo College of New Jersey (NJ): Decapitation in Medieval Literature

Joseph LeJuine, McNeese State University (LA): The Abusive Lover: Sir Lancelot's and Queen Guinevere's True Relationship

Dana Peterson, Olivet Nazarene University (IL): Lacan in the Wedding of Sir Gawain and Dame Ragnell

Concurrent Sessions

B-5. All in the Family in 19th Century Literature

Thursday 9:30-10:45

Balcony K, 4th floor

Moderator: Judith John, Missouri State University (MO)

Chair: Victoria Unthank, Erskine College (SC)

Evanne Lindley, Pepperdine University (CA): Keeping Our Brothers: Immortality Through Remembrance in *The Brothers Karamazov*

Mandi Reed, Missouri State University (MO): Sibling Incest: Elevating Expressions of Romanticism

Justine Rosen, SUNY, College at Geneseo (NY): Ineffectual Parenting in *Pride and Prejudice*

B-6. Early American Women

Thursday 9:30-10:45

Balcony L, 4th floor

Moderator: Elisa Beshero-Bondar, University of Pittsburgh, Greensburg (PA)

Chair: Kimberly Newsom, Chapman University (CA)

Kathryn Begeja, The College of New Jersey (NJ): Representations of Wilderness in the Narrative of Mrs. Mary Rowlandson

Joseph Saccamago, University of Pittsburgh, Greensburg (PA): Different Worlds: Anne Bradstreet and Sor Juana Ines de la Cruz

Heather Schmottlach, University of Southern Mississippi Gulf Coast (MS): Anne Bradstreet: Finding an Identity as a Puritan Woman and a Poet

B-7. A World of Faith in Literature

Thursday 9:30-10:45

Balcony M, 4th floor

Moderator: Carl Miller, University of Alabama (AL)

Chair: Esther Easley, Harris-Stowe State University (MO)

Stephanie Brumfield, University of Alabama (AL): Pragmatism's Function as a Harmonizer of Contradictions

Tahirah Dean, University of North Texas (TX): Intellect, Religion, and Lust

Caroline Milam, Samford University (AL): Seeing God in a War Zone

Lucas Wilson, Liberty University (VA): To Hell with Sacred Objects

B-8. American Faces, American Spaces

Thursday 9:30-10:45

Balcony N, 4th floor

Moderator: Glenn Steinberg, The College of New Jersey (NJ)

Chair: Amanda Hebson, Westfield State College (MA)

Lauren Gilliard, Northwest Missouri State University (MO): Necessary Fictions

Matt Huston, The College of New Jersey (NJ): (Dis)connected: Friends, "Friends," and Empathetic Communication in the Facebook Era

Kirsten MacKay, University of Alabama (AL): 1950s America Through the Lens of Robert Frank

Greta Schultz, University of Wisconsin, Eau Claire (WI): Buffalo Wild Wings: A Gendered Space Perpetuating Stereotypes

B-9. Original Fiction: Memorable

Thursday 9:30-10:45

Bonaparte, 4th floor

Moderator: Megan Holt, Tulane University (LA)

Chair: Angela Richardson, Northwest Missouri State University (MO)

Beckett Ananda, Broward Community College (FL): Return Policy

Samuel Brown, University of Arkansas, Little Rock (AR): The List on the Desk

Justin Campbell, Chapman University (CA): The Escort

Elizabeth Furey, Tulane University (LA): The Dining Habits of Others

Concurrent Sessions

B-10. Worldview of Love **Thursday 9:30-10:45** **Iberville, 4th floor**

Moderator: Melissa Caldwell, Eastern Illinois University (IL)

Chair: Tamia Easterling, Tennessee State University (TN)

Drew DeVine, Samford University (AL): Emersonianism Happened One Night: Transcendence in Frank Capra's Romantic Comedy

Lisa Dulaney, Eastern Illinois University (IL): Werther's Fatal Love Affair with Literature

Van Le, Collin County Community College (TX): The Power of Love

Rebecca McNulty, The College of New Jersey (NJ): Destroying Social Outliers: The Functional Significance of *Wife Swap* on Middle Class Culture

B-11. Roundtable - Sustaining New Orleans: The Effect of Hurricane Katrina on New Orleans' Contemporary Literary Scene **Thursday 9:30-10:45** **Napoleon, 41st floor**

Moderator: Paul Mahaffey, University of Montevallo (AL)

Roundtable Participants:

Ashley Burge, University of Montevallo (AL)

Jessica Guindon, University of Montevallo (AL)

Heather Hardeman, University of Montevallo (AL)

Jamie King, University of Montevallo (AL)

Jessica Littlejohn, University of Montevallo (AL)

Abstract: This discussion will be organized around the contemporary literary scene in New Orleans and how it has been shaped by Hurricane Katrina. The panelists will be discussing how this literature serves a social purpose that is vital in sustaining the city.

B-12. Roundtable - Observe, Contribute, Teach: Experiences from the English Classroom **Thursday 9:30-10:45** **Bissonet, 3rd floor**

Moderator: Sara Day, Southern Arkansas University (AR)

Roundtable Participants:

Rayna Dawson, Oklahoma Baptist University (OK)

Elleigh Gardner, Southern Arkansas University (AR)

Byron Gilman, Rockhurst University (MO)

Melissa Sue Miller, University of Wisconsin- Eau Claire (WI)

Cassie Sharp, Oklahoma Baptist University (OK)

Abstract: Students from four schools will focus on experiences within English Education and teaching English as a second language. Participants will address topics including writing workshops for traditional and ESL students, practicum or student teaching experiences, and current trends in the English and ESL classroom.

B-13. Student Leadership Workshop: English Majors Beyond English **Thursday 9:30-10:45** **Carondelet, 3rd floor**

Concurrent Sessions

Session C: Thursday, March 1, 11:00-12:15 p.m.

C-1. Creative Nonfiction: Traumatic

Thursday 11:00-12:15

Regent, 4th floor

Moderator: Sara Day, Southern Arkansas University (AR)

Chair: Jill Fennell, Southern Arkansas University (AR)

Heather Creech, Southern Arkansas University (AR): Strength

Lydia Freeman, Bluefield College (VA): The Definition of Shame

Margaret Russell, Marian University (WI): Four

Sarah Titus, St. Norbert College (WI): Why Not to Shut Books in the Freezer

C-2. Original Poetry: A Bitter Pill to Swallow

Thursday 11:00-12:15

Bacchus, 4th floor

Moderator: Andrew Moser, Metropolitan State College of Denver (CO)

Chair: Crystal Lanucha, Westfield State College (MA)

Sharika Comfort, Johnson C. Smith University (NC): Whips and Chains

Sarah Galo, Ramapo College of New Jersey (NJ): I Married My Rapist, A Selection of Poetry

Kasey Lawrence, University of Central Oklahoma (OK): To Be Unbound

Roberto Martinez, Metropolitan State College of Denver (CO): Bitter Ends

Amber Silvers, Southeastern Louisiana University (LA): Night and Silence

C-3. Original Fiction: From Afar

Thursday 11:00-12:15

Balcony I, 4th floor

Moderator: Lillian Schanfield, Barry University (FL)

Chair: Alexis Sullivan, University of Scranton (PA)

Amber Criswell, University of Houston, Clear Lake (TX): Paris in a Bottle

Ellen Eubanks, Ouachita Baptist University (AR): Flotsam

Samiyeh Nasser, Broward Community College (FL): Welcome to Jerchio

Haley Struthers, Barry University (FL): Operation Phantom

C-4. 16th/17th Century British Literature: British Poesy

Thursday 11:00-12:15

Balcony J, 4th floor

Moderator: Marie DiFilippo, Rockhurst University (MO)

Chair: Will Feldman, Minot State University (ND)

Chelsey Brockenbrough, The College of New Jersey (NJ): Society and Death in "On the Death of a fair Infant dying of a Cough" by John Milton

Taylor Sasse, Rockhurst University (MO): Playing Copernicus

Krista Schrock, University of South Florida, Sarasota-Manatee (FL): *Ut Pictura Poesis*: Reflections of Mortality in Metaphysical Poetry

C-5. Sponsor Workshop

Thursday 11:00-12:15

Balcony K, 4th floor

Moderator: Traci Thomas-Card, University of Wisconsin, Eau Claire (WI)

Concurrent Sessions

C-6. Questions of Race in Young America

Thursday 11:00-12:15 Balcony L, 4th floor

Moderator: Linda Tucker, Southern Arkansas University (AR)

Chair: Nancy Love, Lyon College (AR)

Aaron Barger, University of Arkansas, Little Rock (AR): Richard Allen and African Methodist Literary Tradition

Andrew Houghtalen, Sacred Heart University (CT): Themes of Race Encountered in *Moby-Dick*

Kristen Stradt, Western Illinois University (IL): Society and the Environment: The True Origins of Race in *Clotel*

Dana Woodcock, University of Southern Mississippi, Hattiesburg (MS): The Obsession: Whiteness, Blackness, and Captain Ahab

C-7. Orienting Sexuality

Thursday 11:00-12:15 Balcony M, 4th floor

Moderator: Joseph Dimuro, University of California, Los Angeles (CA)

Chair: Jessica Littlejohn, University of Montevallo (AL)

Brian Bellocq, Louisiana Tech University (LA): Male Homoeroticism in *Heart of Darkness* and *Mrs. Dalloway*

Aaron Dickey, University of Nebraska, Kearney (NE): Mortal Combat: (Homo)Sexual Repression in *Dr. Jekyll and Mr. Hyde*

Jordan Gilbert, Oklahoma Baptist University (OK): The Unseen Homosexual: Allan Gray in Tennessee William's *A Streetcar Named Desire*

Travis Lau, University of California, Los Angeles (CA): Re-Membering the Lesbian Erotic: Sensual Empowerment after Cultural Dismemberment

C-8. It's All About the Journey

Thursday 11:00-12:15 Balcony N, 4th floor

Moderator: Beth DeMeo, Alvernia University (PA)

Chair: Brandon McNulty, King's College (PA)

Shannon Ferguson, Franklin Pierce University (NH): The Road to Paris: Paul Berlin's Redemption

Kara Hedge, Springfield College (MA): Self-Discovery and *A Room with a View*: How a Journey Can Help Sort Through the Muddle

Caitlin Phillips, Penn State Abington (PA): *Ulysses*: The Long Road to Publication and the Impact It Left Behind

Rose Selby, Westminster College (PA): Huck's and Joe's Journeys: Identity in Places and "Safe Spaces"

C-9. Creative Nonfiction: Ties That Bind

Thursday 11:00-12:15 Bonaparte, 4th floor

Moderator: Amijo Comeford, Dixie State College of Utah (UT)

Chair: Cody McConnell, Clarion University (PA)

Rachel Correll, Park University (MO): Shades of Gray

Elvina Meyer, St. Edward's University (TX): Almost Lost in the Fall

Whitney Reed, Otterbein College (OH): Sisters Forever

Elaine Wilson-Sharp, Dixie State College of Utah (UT): The Problem with Polygamy

Concurrent Sessions

C-10. Original Fiction: Out of the Ordinary Thursday 11:00-12:15 Iberville, 4th floor
Moderator: Megan Holt, Tulane University (LA)
Chair: Jessica Horn, Blue Mountain College (MS)

Chelsea Johnson, Azusa Pacific University (CA): Hot Potatoes
Michelle Salyga, University of North Carolina, Wilmington (NC): Circus Freak
Shelby Simon, Tulane University (LA): The Devil Is Beating His Wife with Frying Pans

**C-11. Roundtable - Young Adult Saves: Implementing
Young Adult Literature in a High School Curriculum** Thursday 11:00-12:15 Napoleon, 41st floor
Moderator: Dave Wendelin, NEHS Director

Roundtable Participants:

Alyssa Chrisman, Central Michigan University (MI)
Ariana Jordan, Central Michigan University (MI)
Trisha Tonge, Central Michigan University (MI)
Jessie Vought, Central Michigan University (MI)

Abstract: Young adult literature has not been canonized, and many teachers are unsure about how to include it in their curriculum. This panel will inform the audience about how to incorporate young adult literature in the classroom and will invite the audience to share experiences and ask questions.

**C-12. Roundtable - Reawakening and Demanding to be Heard:
Short Stories from Arab Women Writers** Thursday 11:00-12:15 Bissonet, 3rd floor
Moderator: Kathy Nixon, American University of Kuwait (KU)

Roundtable Participants:

Maryam Al Akilli, American University of Kuwait
Ayat Al Bloushi, American University of Kuwait
Razan Farhat, American University of Kuwait
Joshua Williams, American University of Kuwait

Abstract: This roundtable discussion will focus on stories of selected Arab women writers who reflect the voices of women who were once silenced but are now demanding to be heard. These authors voice the vital gender issues and social struggles of contemporary Arab women.

Concurrent Sessions

C-13. Roundtable - Mutant and Proud: Humanistic Politics of the Superhero Minds **Thursday 11:00-12:15** **Carondelet, 3rd floor**

Moderator: Sean Cullen, Alvernia University (PA)

Roundtable Participants:

Jessica Heller, Alvernia University (PA)

Megan McCue, Alvernia University (PA)

Derek Rowe, Alvernia University (PA)

Derek Smith, Alvernia University (PA)

Abstract: This roundtable will reawaken as a courtroom used to provide insurmountable evidence in favor of comics in the classroom. The debate will focus on contemporary issues as presented in Marvel's "Civil War" series while the audience will serve as the jury.

Session D: Thursday, March 1, 1:30-2:45 p.m.

D-1. Creative Nonfiction: Mothers and Fathers **Thursday 1:30-2:45** **Regent, 4th floor**

Moderator: Ty Hawkins, Walsh University (OH)

Chair: Monique Villalobos, California Lutheran University (CA)

Rachael Mt. Pleasant, SUNY, College at Geneseo (NY): Big Dad

Theresa Oliverio, Walsh University (OH): Clarion Reflections

Sonya White, Park University (MO): Realizing Home

D-2. Original Poetry: War and Craft **Thursday 1:30-2:45** **Bacchus, 4th floor**

Moderator: Robert Scott, Ohio Northern University (OH)

Chair: Allegra Barlow, Minnesota State University, Moorhead (MN)

Michael Farley, University of Scranton (PA): Combat Reflections: A Poetic Glimpse of OIF

Brooke King, Saint Leo University (FL): Walking the Main Road

Megan Ryals, Southeastern Louisiana University (LA): The Idea of Beauty and the Monsters Within

Justin Stewart, Ohio Northern University (OH): A Bullet in Love: A Poetry Collection

Jenna Szypulski, University of Pittsburgh, Greensburg (PA): The Dog's a Devil

D-3. Original Fiction: Love Match **Thursday 1:30-2:45** **Balcony I, 4th floor**

Moderator: Kathy Nixon, American University of Kuwait (KU)

Chair: Kelli Wilson, Ouachita Baptist University (AR)

Antonio Byrd, Auburn University, Montgomery (AL): A Short Epic Life

Jessica Horn, Blue Mountain College (MS): Chicken...Chicken...

Al-Akili Maryam, American University of Kuwait (KU): A Kuwaiti Love Story Beyond Expectations

Teresa Sherman-Jones, Northern Michigan University (MI): Always

Concurrent Sessions

D-4. Clothing Optional: Clothes as Character in Literature **Thursday 1:30-2:45** **Balcony J, 4th floor**
Around the World

Moderator: B. Lee Miller, Chadron State College (NE)

Chair: Jessica Littlejohn, University of Montevallo (AL)

Cassandra Addleman, University of Nebraska, Omaha (NE): "What a Strange Power There Is in Clothing": Clothing as Extended Metaphor in *Macbeth*

Claudia Brazle, Oklahoma Christian University (OK): Death by Garment: The Disintegration of Princess Glauke in Euripides' *Medea*

Kristin Chang, University of Wisconsin, Eau Claire (WI): Girl Power(lessness): Male Authorship of Female Cross-Dressing Narratives in Early America

Kaley White, Oklahoma Christian University (OK): Cramped Up and Civilized in *Huckleberry Finn*: Clothing's Function as a Cultural Mask

D-5. Romanticism and/or Early 19th Century British Literature: **Thursday 1:30-2:45** **Balcony K, 4th floor**
Bringing Shelley Back to Life

Moderator: Pamela Buck, Sacred Heart University (CT)

Chair: Gabriella Coro, Barry University (FL)

Benjamin Bradley, Sacred Heart University (CT): It's Alive!: Autonomous Creative Complex in *Frankenstein*

Felicia Carlini, Sacred Heart University (CT): The Search for Human Identity

Aliza Davner, Lycoming College (PA): Edenic Allegory in Mary Shelley's "The Mortal Immortal"

Ian Wolf, Central Michigan University (MI): Genie Would Agree: A Psychological Examination of Mary Shelley's *Frankenstein*

D-6. Southern Struggles **Thursday 1:30-2:45** **Balcony L, 4th floor**

Moderator: Carrie Fitzpatrick, Alvernia University (PA)

Chair: Katherine Nichols, Sacred Heart University (NH)

Jihan Bok, Cedarville University (OH): A Failure to Awaken

Alexandra Gatten, Sacred Heart University (CT): Stagnancy and the Self

Crystal Knappenberger, Winthrop University (SC): A Study of the Misuse of Language in Kate Chopin's *The Awakening*

Andrew Todd, John Carroll University (OH): Inadequacy of "Unreliability": Faulkner's Quentin Compson

D-7. Irish Influences in British Literature **Thursday 1:30-2:45** **Balcony M, 4th floor**

Moderator: Kevin Brown, Lee University (TN)

Chair: Elizabeth Hageman, Thomas More College (KY)

Jonathan Barefield, Central Michigan University (MI): Imperial Elisions in James Joyce's "Counterparts"

Carson Gadd, Southern Utah University (UT): *Differance* in *A Portrait of the Artist as a Young Man*

Laura Pullin, Lee University (TN): Identity in the Irish Short Story

Jon Savage, University of North Texas (TX): Methods and Catalysts of Growth in Joyce's "An Encounter"

Concurrent Sessions

D-8. 20th/21st Century American Literature: Keeping House **Thursday 1:30-2:45** **Balcony N, 4th floor**

Moderator: Brenda Ryan, Northwest Missouri State University (MO)

Chair: Lindsay Hodgens, University of Montevallo (AL)

Randa Delp, Northwest Missouri State University (MO): Sacraments of Unbecoming: Transcendent Loss of Self in Marilynne Robinson's *Housekeeping*

Emily Eddinger, Chatham University (PA): "Dirty Pots in the Sink": The Environment of the Texas and Oklahoma Panhandles in "That Old Ace in the Hole"

Kristen Inman, Northwest Missouri State University (MO): Imperfect Darkness

Celeste Lempke, University of Nebraska, Kearney (NE): Structure in Willa Cather's *The Professor's House*

D-9. Creative Nonfiction: World Tour **Thursday 1:30-2:45** **Bonaparte, 4th floor**

Moderator: Gloria Hochstein, University of Wisconsin, Eau Claire (WI)

Chair: Lacie Thompson, Southwestern Oklahoma State University (OK)

Kristin Carney, Park University (MO): Travel Is Risk

Brittany Champa, Assumption College (MA): Lessons from Ghana

Meredith Molnar, University of Wisconsin, Eau Claire (WI): Home Is a Fractured Memory

Catherine Wanzer, University of Wisconsin, Eau Claire (WI): Orders

Jillian Weiss, Elon University (NC): The Raining

D-10. Original Poetry: Going Without **Thursday 1:30-2:45** **Iberville, 4th floor**

Moderator: Sandra Petrulionis, Penn State Altoona (PA)

Chair: Chelsea Pine, Central Michigan University (MI)

Sarah Abraham, Penn State Altoona (PA): Encounters

Christina Jones, Shawnee State University (OH): Lost and Found

Sarah McDonald, Penn State Altoona (PA): Dissections

Austin Payne, Southeastern Louisiana University (LA): 11:11

Christina Stopka-Rinnert, Mansfield University (PA): Love, Life, and Grief

D-11. Original Fiction: Graveside **Thursday 1:30-2:45** **Napoleon, 41st floor**

Moderator: Roger Stanley, Union University (TN)

Chair: Marcie Ponder, Morningside College (IA)

Oscar Maria, Azusa Pacific University (CA): Do This in Remembrance of Me

Michael O'Malley, Union University (TN): Achilles

Gary Thomas Smith, University of Pikeville (KY): Buried Alive

Sara Stone, The Ohio State University (OH): Coming Home

Concurrent Sessions

D-12. Knowledge and Memory in American Poetry Thursday 1:30-2:45 St. Charles, 41st floor

Moderator: Ashley Bissette Sumerel, University of North Carolina, Wilmington (NC)

Chair: Liz McQuistan, Morningside College (IA)

Gloria Grancea, University of Pittsburgh, Greensburg (PA): The Woman Poet Sor Juana Ines de la Cruz

Sasha Johnson, University of North Carolina, Wilmington (NC): Learning to Embrace Death: Walt Whitman's

Changing Perspectives on Duality, Immortality, and Identity

Eric Klopach, University of Alabama (AL): Memory in Yeats and Lowell

Benjamin Moran, Western Michigan University (MI): The Freedom of 'Not Knowing': A.R. Ammons's "Corsons Inlet" as an Epistemological Meditation

D-13. Roundtable - Disney Villains as Fallen Females Thursday 1:30-2:45 Carondelet, 3rd floor

Moderator: Nancy Tuten, Columbia College, South Carolina (SC)

Roundtable Participants:

Sarah Martin, Columbia College (SC)

Chelsea Rhodes, Columbia College (SC)

DeAnna Rich, Columbia College (SC)

Olivia Rose, Columbia College (SC)

Abstract: This roundtable discussion will focus on female villains in well-known Disney films. Participants will explore these characters' awakening, which often involves removal from the pedestal women characters are placed upon in a patriarchal society. Audience members will consider what role the "fallen woman" plays in popular texts.

D-14. Naomi Shihab Nye Workshop Thursday 1:30-2:45 Acadia, 3rd floor

Session E: Thursday, March 1, 3:00-4:15 p.m.

E-1. Creative Nonfiction: Bildungsroman Thursday 3:00-4:15 Regent, 4th floor

Moderator: Lillian Schanfield, Barry University (FL)

Chair: Kelly Cernetich, University of Pittsburgh, Johnstown (PA)

Jordan Adkins, University of Pikeville (KY): The Deep End

Rachael Belmore, Northern Michigan University (MI): Reflections

Michelle Iberg, Barry University (FL): Peeling Pennies

Jamee Larson, Minnesota State University, Moorhead (MN): Pretty Good, Pretty Good

E-2. Original Poetry: Natural Occurrences Thursday 3:00-4:15 Bacchus, 4th floor

Moderator: Amy Sonheim, Ouachita Baptist University (AR)

Chair: Tawni Turcotte, Franklin Pierce University (NH)

Nancy Correro, McNeese State University (LA): Melancholy in Nature

Joseph Gamble, University of Alabama (AL): Awake: Supplication

Agnes Hapka, University of Rio Grande (OH): Seasons in Time and Space

Sean Rayburn, Mercer University (GA): Southern Weather: A Collection of Verses

Marissa Thornberry, Ouachita Baptist University (AR): Chronicle of Seasons

Concurrent Sessions

E-3. Original Fiction: Small Town Thursday 3:00-4:15 Balcony I, 4th floor

Moderator: Jodi Wagner, Marian University (WI)

Chair: Desirae Gostlin, Columbia College, South Carolina (SC)

Matt Baker, Oklahoma Baptist University (OK): The Tip Jar

Byron Gilman, Rockhurst University (MO): Procedure

Gretchen Ottmers, St. Edward's University (TX): The Old Man and the Chair

Emily Whyms, Marian University (WI): 8 Seconds

**E-4. Anglo Saxon and Medieval British Literature:
The Power of Words** Thursday 3:00-4:15 Balcony J, 4th floor

Moderator: Mike Land, Assumption College (MA)

Chair: Kimberly Shelton, Blue Mountain College (MS)

Kelsey Frobisher, Oklahoma Christian University (OK): Authority and Experience in the *Canterbury Tales*

Stephanie Giguere, Assumption College (MA): Images, Song, and Language in Chaucer's Prioress's Tale

Matthew Kemp, Auburn University, Montgomery (AL): It Is Never Word for Word: An Examination of Editorial Choices and Consequences in "Deor"

Kaci McCourt, University of Louisiana, Monroe (LA): The Spoken Monster: Grendel as Irredeemable

E-5. Jane Eyre and British Femininity Thursday 3:00-4:15 Balcony K, 4th floor

Moderator: Taylor Madaffari, Elon University (IL)

Chair: Victoria Unthank, Erskine College (SC)

Sarah Faulkner, Chapman University (CA): Nature and Steel: How Rochester Enters Jane's World

Kelly Herrick, Elon University (NC): Rochester's Choice: British Ideals of Women in *Jane Eyre*

Stacy Long, Blue Mountain College (MS): Stern God and Saving Grace: Jane Eyre's Trial of Passion and Principle

Catherine Michaelsen, The College of New Jersey (NJ): Deconstructing Sexuality in *Jane Eyre*

E-6. Hawthorne, Emerson, and the Puritan Origins of America Thursday 3:00-4:15 Balcony L, 4th floor

Moderator: Luis Iglesias, University of Southern Mississippi, Hattiesburg (MS)

Chair: Justin Greer, Southeastern Louisiana University (LA)

Alejandro Garrido, University of North Texas (TX): That One Congenial Friend

Blakely Owens, University of Southern Mississippi, Hattiesburg (MS): City of the Soul: Emerson's Answer to the Puritan Problem

James Schlag, Southern Arkansas University (AR): Fantasy vs Reality: The Failure of Romance in *The Blithedale Romance* and *Madame Bovary*

Shalicia Wilson, Williams Baptist College (AR): Hawthorne's Piercing Correspondence

Concurrent Sessions

E-7. Discovering Shakespeare Thursday 3:00-4:15 Balcony M, 4th floor

Moderator: Judith Clark, Stephens College (MO)

Chair: Matthew Schwager, Montana State University, Bozeman (MT)

Laura Davis, Stephen F. Austin State University (TX): Reawakening Shakespearean Pedagogy

Trisha Haber, Dixie State College of Utah (UT): Anything Girls Can Do, Boys Can Do Better: Shakespeare's *Twelfth Night* and Fickman's *She's the Man*

William Porter, SUNY, College at Geneseo (NY): A Moral Defense of Poetry

Olivia Senecal, Chapman University (CA): A Cinematic Shakespeare for the Visual Masses

E-8. Contemporary Poetry by American Women Thursday 3:00-4:15 Balcony N, 4th floor

Moderator: Carrie Fitzpatrick, Alvernia University (PA)

Chair: Jessica Baker, The College of New Jersey (NJ)

Trina Drotar, California State University, Sacramento (CA): The Erosion of the Poetic Tradition in Marianne Moore's "The Fish"

Jeff Harrison, The College of New Jersey (NJ): "I am, I am, I am": Constructing Sylvia Plath's Self-Identity Through Her Work

Samantha Killmeyer, Westminster College (PA): Denise Levertov: Defining Woman

Bradley Phillips, Walsh University (OH): Aesthetic Philosophy in Amy Lowell's "Red Slippers"

E-9. Creative Nonfiction: Memoir Thursday 3:00-4:15 Bonaparte, 4th floor

Moderator: Beth DeMeo, Alvernia University (PA)

Chair: Allison Greer, The College of New Jersey (NJ)

Daniella Burke, Lipscomb University (TN): Cleaving Open

Katie Leskinen, Cardinal Stritch University (WI): On Engagement Rings

Lauren Roberts, Rockhurst University (MO): Hanging Blood

Michael Wagner, Alvernia University (PA): Good-Bye

E-10. Problematizing Young Adult Literature Thursday 3:00-4:15 Iberville, 4th floor

Moderator: Sara Day, Southern Arkansas University (AR)

Chair: Sarah Schrupp, University of Wisconsin, Eau Claire (WI)

Courtney Blankenship, Concord University (WV): Alcoholism in Sherman Alexie's *Reservation Blues* and *The Absolutely True Diary of a Part-Time Indian*

Shaye Champ, University of Nebraska, Kearney (NE): Teens in Revolt: Exploring Teen Violence in Suzanne Collin's *The Hunger Games*

Whitney Davis, Kansas State University (KS): Dystopia for All

Katherine Spruill, Elon University (NC): Portrayals of Education in British and American Boarding School Stories

Concurrent Sessions

E-11. Original Fiction: Out of Time

Thursday 3:00-4:15

Napoleon, 41st floor

Moderator: Sherrell Settlemires, Blue Mountain College (MS)

Chair: Chase Shanafelt, Morningside College (IA)

Anna Blake, Washington & Jefferson College (PA): *Surviving Today*

Kylie Kinley, Kansas State University (KS): *The Aviatrix*

Paul Pursell, Park University (MO): *Satori 1*

Anna Russell, Blue Mountain College (MS): *Counterclockwise*

Selina Souza, University of Louisiana, Monroe (LA): *Waiting for the Tide to Change*

E-12. Middle Eastern Literature and Film

Thursday 3:00-4:15

St. Charles, 41st floor

Moderator: Kathy Nixon, American University of Kuwait (KU)

Chair: Amanda Hebson, Westfield State College (MA)

Bridie MacDonald, Central Michigan University (MI): *Reawakening the Existence of Women in the Middle East*

Jennifer Marks, Florida Gulf Coast University (FL): *Humanism in Color: The Visions of Majid Majidi in Baran*

Elizabeth Surbeck, Eastern Illinois University (IL): *Comics for Children?*

Bradley Wierbowski, University of Scranton (PA): *Narrative's Politically Transformative Power: Mahfouz's Arabian Nights and Days*

E-13. Roundtable - Fangs and Funds: Class System in Vampire Tales

Thursday 3:00-4:15

Bissonet, 3rd floor

Moderator: Winter Elliott, Brenau University (GA)

Roundtable Participants:

Laura Bolling, Brenau University (GA)

Eleanor Fowler, Brenau University (GA)

Kacey Janes, Brenau University (GA)

Monique Wimby, Brenau University (GA)

Abstract: This roundtable will discuss economy and social class in the pop culture phenomenons *Twilight* and *Buffy the Vampire Slayer*. Nineteenth century works, such as *Dracula* and *Carmilla*, advance ideas of vampire prosperity and separate social hierarchies that have reawakened in modern vampire texts and reflect modern problems of wealth and class.

E-14. Naomi Shihab Nye Book Signing

Thursday 3:00-4:15

Carondelet, 3rd floor

Concurrent Sessions

Session F: Friday, March 1, 8:00-9:15 a.m.

F-1. Creative Nonfiction: Off the Record

Friday 8:00-9:15

Regent, 4th floor

Moderator: Robert Crafton, Slippery Rock University (PA)

Chair: Kayla Haas, Oklahoma Christian University (OK)

Lisa Howard, College of Notre Dame of Maryland (MD): How to Be a Phone-sex Girl

Mary Kristen Layne, Furman University (SC): Going Off Book

Kelly Miesko, Slippery Rock University (PA): At the Tennis Center

Lacie Thompson, Southwestern Oklahoma State University (OK): The MM Revolt

F-2. Original Poetry: Manmade

Friday 8:00-9:15

Bacchus, 4th floor

Moderator: Jen Peterson, Morningside College (IA)

Chair: Matthew Kemp, Auburn University, Montgomery (AL)

Michele Andersen-Heroux, Metropolitan State College of Denver (CO): Pause: A Collection of Transitions

Brennan Girdler, University of Evansville (IN): Crude Machine

Shannon McLean, Southern Utah University (UT): Transportation

Kelci Teut, Morningside College (IA): Portraits

Jennifer Whalen, Northern Kentucky University (KY): Please Respond, My Sculptor of Grace

F-3. Original Fiction: Self-Inflicted

Friday 8:00-9:15

Balcony I, 4th floor

Moderator: Peter Scholl, Luther College (IA)

Chair: Grace Makley, Northern Michigan University (MI)

Alexander Daley, California Lutheran University (CA): Checkmate: A Suicide Note

Bethany Kohl, Ouachita Baptist University (AR): He Cannot Hear You

Lauren Nielsen, Luther College (IA): The Door

Katie Sartor, Lee University (TN): Echoes

F-4. 16th/17th Century British Literature: Milton Found

Friday 8:00-9:15

Balcony J, 4th floor

Moderator: William C. Johnson, Sigma Tau Delta Executive Director

Chair: Derek Warden, Louisiana Tech University (LA)

Douglas Dennon, University of Alabama (AL): "Virtue may be assail'd but never hurt": Spiritual Maturity as Physical Autonomy in *Comus*

Kim Harrer, Metropolitan State College of Denver (CO): Cosmic Awakening in John Milton's *Paradise Lost*

Blaine Salzman, University of South Florida, Sarasota-Manatee (FL): Alchemy in *Paradise Lost*

Concurrent Sessions

F-9. Money Makes the Literary World Go 'Round

Friday 8:00-9:15

Bonaparte, 4th floor

Moderator: Rebecca Murry, Southeastern Louisiana University (LA)

Chair: Tamia Easterling, Tennessee State University (TN)

Samantha Kendrick, William Jewell College (MO): Objectification and Social Progress in Rossetti's "Goblin Market"

Jens Paasen, St. Norbert College (WI): Disney's *Pocahontas* and Consumerism in a Natural Disguise

Ashley Williams, Southeastern Louisiana University (LA): Zombies: The Mirror Image of a Postmodern, Consumer-Based Society

F-10. World Literature: Ovid

Friday 8:00-9:15

Iberville, 4th floor

Moderator: Melissa Caldwell, Eastern Illinois University (IL)

Chair: Bridie MacDonald, Central Michigan University (MI)

Meredith Edwards, Furman University (SC): Orpheus' Songs: Narrations of Desire and Deliberation

John McGill, University of Scranton (PA): Polyxena's Physical Courage in Ovid's *Metamorphoses*

Jacob Sandman, University of Nebraska, Kearney (NE): Gender and Sexuality in Ovid's *Metamorphoses*

Alexis Sullivan, University of Scranton (PA): Orpheus' Rhetorically Successful Plea in Book 10 of Ovid's *Metamorphoses*

F-11. Evolving Narratives

Friday 8:00-9:15

Napoleon, 41st floor

Moderator: Marybeth Davis, Liberty University (VA)

Chair: Danielle Rose, Freed-Hardeman University (TN)

Kimberly Eskin, Ramapo College of New Jersey (NJ): The Senselessness of Life in Genet's *The Balcony*

Dorcas Lam, Liberty University (VA): Loss for Words: The Inadequacy of Language in *As I Lay Dying*

Shauntazia Shorter, Tennessee State University (TN): Reawakening Cultural Pride: The "Surge" for Humanity in Patrick Chamoiseau's "The Old Man Slave and the Mastiff"

Edward Szeman, Winthrop University (SC): Digital Evolution of Narratives: Awakening Traditional Narrative Forms Through New Media

F-12. Roundtable - Ergodic Literature:

Friday 8:00-9:15

St. Charles, 41st floor

Reader Authority and Collaboration

Moderator: Leigh Camacho Rourks, Southeastern Louisiana University (LA)

Roundtable Participants:

Megan Abigail Hughes, University of Pittsburgh at Greensburg (PA)

Megha Pai, University of Pittsburgh at Greensburg (PA)

Austin Payne, Southeastern Louisiana (LA)

Natalie Rich, Southeastern Louisiana (LA)

Sally Strain, University of Pittsburgh at Greensburg (PA)

Abstract: Students and faculty from two chapters will explore how, in the interaction of game environments, readers become agents who dynamically shape the text. Players, as interactive authors, share imaginative space in which text production generates community. Discussion will include multiple forms of ergodic texts including RPGs, poems, hypertext, and graphic narratives.

Concurrent Sessions

F-13. Roundtable - The Big Easy Reawakened: Friday 8:00-9:15 Carondelet, 3rd floor
Stories from the History Channel

Moderator: Elizabeth Willingham, Calhoun Community College (AL)

Abstract: Dr. Randy Cross will share his experiences as a commentator for a recent History Channel documentary about the Deep South, *You Don't Know Dixie*.

F-14. Anthony Doerr Workshop Friday 8:00-9:15 Acadia, 3rd floor

Session G: Friday, March 2, 9:30-10:45 a.m.

G-1. Creative Nonfiction: What's in Writing Friday 9:30-10:45 Regent, 4th floor

Moderator: Karlyn Crowley, St. Norbert College (WI)

Chair: Daniella Burke, Lipscomb University (TN)

Zita Cambra, Bridgewater State University (MA): Snapshots from a Life

Tamara Sager, King's College (PA): Three Most Powerful Words

Leslie Shapy, St. Norbert College (WI): Re-Awakening My American Hero

Sarah Stromer, Saint Leo University (FL): The Review

G-2. Original Poetry: Deep Water Friday 9:30-10:45 Bacchus, 4th floor

Moderator: Glen Brewster, Westfield State College (MA)

Chair: Will Feldman, Minot State University (ND)

Emma Fick, University of Alabama (AL): Underwater Games

Kara Knickerbocker, Westminster College (PA): The Art of Baptizing

Erika Lundgren, Westfield State College (MA): Drowning

Emily Scott, Western Michigan University (MI): "Bones" and "Blue House on Bass Lake"

Brandon Taylor, Auburn University, Montgomery (AL): Endymion

G-3. Original Fiction: Youthful Fiction Friday 9:30-10:45 Balcony I, 4th floor

Moderator: Courtney Bennett, University of Montevallo (AL)

Chair: Jeremy Flynn, Saint Vincent College (PA)

Janice Clawson, Stephens College (MO): Snow

Jesse Cospers, University of Montevallo (AL): The Tan Crayon (An Excerpt)

Shelly Fox, Texas A&M University, Corpus Christi (TX): The Boy Who Could Squint

Chelsea Pine, Central Michigan University (MI): Troop 089

Concurrent Sessions

G-4. British Anglo-Saxon and Medieval in the Mix

Friday 9:30-10:45

Balcony J, 4th floor

Moderator: Christina Brown, Mercyhurst College (PA)

Chair: Monique Villalobos, California Lutheran University (CA)

Jessica Higginbotham, Northern Michigan University (MI): "The Seafarer": A Tale of Two-Exiles

Rebecca Marsh, St. Martin's University (WA): Una as the Virgin Mary

Kimberly Newsom, Chapman University (CA): *The Book of Margery Kempe*: A Medieval Madonna's Invention of Self

Chelsea Schermerhorn, Mercyhurst College (PA): The Separation of Two Worlds

G-5. Character and Faith Around the World

Friday 9:30-10:45

Balcony K, 4th floor

Moderator: Bruce Stevenson, California Lutheran University (CA)

Chair: Marcie Ponder, Morningside College (IA)

Nicole Bouchard, Northwest Nazarene University (ID): The Tide Will Rise Again: Faith in "Dover Beach"

Emma Kanagaki, California Lutheran University (CA): Identifying a Character's Continuity in Ian McEwan's *Atonement*

Mackenzie Oberndorfer, Lee University (TN): Pip the Pocket

Rachel Robins, Dixie State College of Utah (UT): Aboriginal Life-Writing: Doris Pilkington's Demonstration of a Postcolonial Hybrid Genre in *Rabbit-Proof Fence*

G-6. Dickinson and 19th Century American Literature

Friday 9:30-10:45

Balcony L, 4th floor

Moderator: Lexey Bartlett, Fort Hays State University (KS)

Chair: Amanda Shaheen, University of Pittsburgh, Johnstown (PA)

Sara Kissell, Washington & Jefferson College (PA): Emily Dickinson's Painted Poem

Lena Paslov, Sacred Heart University (CT): Emily Dickinson: Poetry, God, and Mental Illness

Michelle Webb, Fort Hays State University (KS): Afterlife: An Impossible Possibility

Lacey Young, Auburn University, Montgomery (AL): Poetry in Nature: Dickinson's Transcendent Animals

G-7. 20th/21st Century British Literature: Speaking the Truth

Friday 9:30-10:45

Balcony M, 4th floor

Moderator: Rhonda Armstrong, Augusta State University (GA)

Chair: Jed McCoy, Morningside College (IA)

Daniel Dominowski, Augusta State University (GA): T.S. Eliot's Hysterical Speaker

Christopher Izor, University of Alabama (AL): Form Breaks Content in Hardy's "In Times of 'the Breaking of Nations'"

Caitlin Maher, SUNY, College at Geneseo (NY): The Reawakening of Max Weber in D.H. Lawrence's *Women in Love*

Danielle Myers, University of Southern Mississippi Gulf Coast (MS): Masking the Truth: Modernist Poems Revealing the Government's Intentions

Concurrent Sessions

G-8. Common Reader, *Bellocq's Ophelia*: Camera Obscuring **Friday 9:30-10:45** **Balcony N, 4th floor**
Moderator: Peter Scholl, Luther College (IA)
Chair: Amanda Mitchell, Western Kentucky University (KY)

Allyson Batis, Luther College (IA): The Frame
Paige Davis, Tulane University (LA): A Snapshot in Time: Reawakening to the Color in *Bellocq's Ophelia*
Kari Elizabeth Heideman, Tulane University (LA): Reawakening in *Bellocq's Ophelia*
Tabitha Lowery, Southern Arkansas University (AR): Do Not Frame Me: An Explication of *Bellocq's Ophelia*

G-9. Creative Nonfiction: Shall We Dance? **Friday 9:30-10:45** **Bonaparte, 4th floor**
Moderator: George Dorrill, Southeastern Louisiana University (LA)
Chair: Jodi Ierien, University of Texas, San Antonio (TX)

Robert Durborow, Southern Utah University (UT): At the Feet of the Master
Sarah McEllhenney, Cedarville University (OH): On Not Dancing
Anthony Melf, King's College (PA): Running with Purpose
Rachel Swords, Southeastern Louisiana University (LA): Dedicated to a Dancer: Excerpts from the Diary of Natalie Clifford Barney

G-10. Original Poetry: In Time and Place **Friday 9:30-10:45** **Iberville, 4th floor**
Moderator: Julianne Smith, Pepperdine University (CA)
Chair: Rosemarie O'Connor, Western Kentucky University (KY)

Laura Hernandez, Oklahoma Christian University (OK): Recollections of Summer
Stephanie Nelson, Pepperdine University (CA): Reflections of Time
John Watkins, Lee University (TN): The Prevalence of Those Gray Flakes Falling
Maria Weeks, Marian University (WI): Summertime Ponderings

G-11. Original Fiction: The Dark Side **Friday 9:30-10:45** **Napoleon, 41st floor**
Moderator: Gloria Hochstein, University of Wisconsin, Eau Claire (WI)
Chair: Brandi Pugh, University of Pikeville (KY)

Caitlin Bittner, University of Wisconsin, Eau Claire (WI): The Purple Notebook
Kendra Kravig, La Sierra University (CA): The Afterlife
Andrew Moser, Metropolitan State College of Denver (CO): Voodoo Doll Therapy
Kiah Watson, Northern Michigan University (MI): To Burn a Witch

G-12. Women in Possession in World Literature **Friday 9:30-10:45** **St. Charles, 41st floor**
Moderator: Sheri Midkiff, Williams Baptist College (AR)
Chair: Leah Rajchel, Cardinal Stritch University (WI)

Francesca Baratta, Ramapo College of New Jersey (NJ): Female Sexuality and Insanity: Atwood's *Alias Grace*
Sabrina Bryson, Williams Baptist College (AR): The Downward Descent of *Madame Bovary*
Caroline Harbin, Samford University (AL): One Woman's Possession
Matthew Wiest, Baker University (KS): Emma Did Not Know How to Waltz

Concurrent Sessions

G-13. Student Leadership Workshop: Grad School How-To	Friday 9:30-10:45	Carondelet, 3rd floor
G-14. Anthony Doerr Book Signing	Friday 9:30-10:45	Bissonet, 3rd floor

Session H: Friday, March 2, 1:45-3:00 p.m.

H-1. Creative Nonfiction: Diagnoses	Friday 1:45-3:00	Regent, 4th floor
-------------------------------------	------------------	-------------------

Moderator: Damon Franke, University of Southern Mississippi Gulf Coast (MS)
Chair: Tyler Keal, Baker University (KS)

Shannon Austin, College of Notre Dame of Maryland (MD): like a tree in a forest, falling
Tahirah Dean, University of North Texas (TX): Lost
Kaitlin Hartman, Northwest Missouri State University (MO): A Lump
Mollie Uthe, Thomas More College (KY): No Title

H-2. Original Poetry: Above All This	Friday 1:45-3:00	Bacchus, 4th floor
--------------------------------------	------------------	--------------------

Moderator: Karlyn Crowley, St. Norbert College (WI)
Chair: Erica Roper, University of Central Oklahoma (OK)

Gloria Adams-Hanley, St. Edward's University (TX): Fingertips
Angela Gartner, Saint Vincent College (PA): Memory Undone
Jennifer McCurdy, Mercyhurst College (PA): Exposure
Brenna Monahan, Northwest Nazarene University (ID): Memories of a Small Town Girl: A Collection of Original Poetry
Kristin Sauer, Thomas More College (KY): Feel the Rush

H-3. Original Fiction: Light at the End	Friday 1:45-3:00	Balcony I, 4th floor
---	------------------	----------------------

Moderator: Andrew Moser, Metropolitan State College of Denver (CO)
Chair: Antonio Byrd, Auburn University, Montgomery (AL)

Eli Miles, Shorter University (GA): The Terminal
Mark Reagan, Metropolitan State College of Denver (CO): Meridian
Jon Sadler, Missouri Southern State University, Joplin (MO): The Bomb
Richard Teel, Santa Clara University (CA): The Smell of Ending Silence

Concurrent Sessions

H-4. Fate and Fortune: Early Literature

Friday 1:45-3:00

Balcony J, 4th floor

Moderator: Walker Rutledge, Western Kentucky University (KY)

Chair: Cady Jackson, Oklahoma Christian University (OK)

Shawna Felkins, Western Kentucky University (KY): Modern American Women and the *Aeneid*

Shelby Hunt, Chapman University (CA): Scholarly Paper on Virgil's *Aeneid* and Homer's *Odyssey*

Erika Larsen, Dixie State College of Utah (UT): Shame or Chivalry?: Analyzing the Knights in the Arthurian Round Table

Caitlin Schneider, Assumption College (MA): Fortune and Her Wheel in Medieval Literature

H-5. Heaven and Hell in World Literature

Friday 1:45-3:00

Balcony K, 4th floor

Moderator: Mark Cirino, University of Evansville (IN)

Chair: Kayla Haas, Oklahoma Christian University (OK)

Christopher Cook, Southeastern Louisiana University (LA): The *Divina Commedia* – A Bridge Between Astrology and Christianity

Danielle Dederer, Lee University (TN): From Glory to Glory: Eliot's Move to Godlessness

Klara Nichter, University Of Evansville (IN): Gogol's Inferno

Whitney Williams, Union University (TN): Grace in Grief: Hopkins' Affirmation of Christian Beliefs in a Terrible Sonnet

H-6. Language Matters

Friday 1:45-3:00

Balcony L, 4th floor

Moderator: Chad Schrock, Lee University (TN)

Chair: Allison Greer, The College of New Jersey (NJ)

Neil Cooney, Lee University (TN): Texting: New Language for the New Medium

Chelsea Harrell, Blue Mountain College (MS): Slang: What Is It? Where Does It Come From? How Does It Spread?

Brittany Norman, Midwestern State University (TX): Cultural Influences on 'Bad' Language

Lauren Wood, Minot State University (ND): Noah Webster: The Patriot Behind the American Dictionary

H-7. Common Reader: Down and Out in *Belloc's Ophelia*

Friday 1:45-3:00

Balcony N, 4th floor

Moderator: Michel Aaij, Auburn University, Montgomery (AL)

Chair: Tabitha Lowery, Southern Arkansas University (AR)

Lindsey Applegarth, Midwestern State University (TX): What's a Dog-man?

Anessah Brown, Allen University (SC): Picturing Ophelia

Christina Garner, Auburn University, Montgomery (AL): Hope of Alchemy: Light in *Belloc's Ophelia*

Cammy Sray, Cedarville University (OH): "Train Yourself Not to Look Back": Ophelia Exoticized, Fetishized, and Othered under Homi Bhabha's "Regime of Visibility"

H-8. Practices and Pedagogy in English

Friday 1:45-3:00

Bonaparte, 4th floor

Moderator: Dave Wendelin, NEHS Director

Chair: Elleigh Gardner, Southern Arkansas University (AR)

Deborah Dessaso, University of the District of Columbia (DC): (W)hat (T)he (L)ingua (F)ranca Is Happening to Writing?

Donald Dilliplane, Loyola Marymount University (CA): The Literary Process of a Neo-Platonist

Sara Mulcahy, Bridgewater State University (MA): Pedagogies of English as a Second-Language (ESL)

Concurrent Sessions

H-9. Original Poetry: The Object Is the Thing Friday 1:45-3:00 Iberville, 4th floor
Moderator: Shannin Schroeder, Southern Arkansas University (AR)
Chair: Heather Creech, Southern Arkansas University (AR)

Kelsey Boone, Samford University (AL): Consciousness Colored Yellow
Rodney Foster, Park University (MO): Glimpses: A Collection of Poems
Daniel Kasper, Southern Arkansas University (AR): All There Is of Texas Is
Parker Roth, Baker University (KS): This Is Just to Say

H-10. Original Fiction: In the Picture Friday 1:45-3:00 Napoleon, 41st floor
Moderator: Brenda Ryan, Northwest Missouri State University (MO)
Chair: Esther Easley, Harris-Stowe State University (MO)

Carson Gadd, Southern Utah University (UT): Beneath the Water of the Moon
Breanna Holmes, Montana State University, Bozeman (MT): Fish
Hui Sian Tan, John Carroll University (OH): Whispers
Mandi Wahlenmaier, Northwest Missouri State University (MO): A Scraggly Photographer on a Train

H-11. Race and Young Adult Lit Friday 1:45-3:00 St. Charles, 41st floor
Moderator: Sherrell Settlemires, Blue Mountain College (MS)
Chair: Sarah Schrupp, University of Wisconsin, Eau Claire (WI)

Bethany Biesinger, Saint Vincent College (PA): Wizarding Woes
Tarus Crayton, Blue Mountain College (MS): Mildred Taylor - Discovering an Answer to Racism
Deannah Johnson, University of Arkansas, Little Rock (AR): "Bound Together by Reason and Amity": The Misuses of Science in M.T. Anderson's *The Astonishing Life of Octavian Nothing*
Laura Thacker, Kansas State University (KS): Truth Shielding Lies in *The Indian in the Cupboard*

H-12. Roundtable - Reawaken Your Curiosity: Friday 1:45-3:00 Bissonet, 3rd floor
Bellocq's Ophelia as a Model for Intertextuality
Moderator: Sandra Mayfield, University of Central Oklahoma (OK)

Roundtable Participants:

Heather Etelemaki, Kansas State University (KS)
Sarah Faulkner, Chapman University (CA)
Kelsey Hixson-Bowles, Kansas State University (KS)
Jessica Reyes, Kansas State University (KS)

Abstract: This interactive roundtable will reawaken curiosity by discussing how artists such as Trethewey use multiple texts to inform their work. Through individual, small group, and large group work, roundtable participants and audience will reflect on texts they encounter daily and will practice synthesizing texts and forming meaningful observations.

Concurrent Sessions

Session I: Friday, March 2, 3:15-4:30 p.m.

I-1. Creative Nonfiction: Food for Thought Friday 3:15-4:30 Regent, 4th floor

Moderator: Ericka Hoagland, Stephen F. Austin State University (TX)

Chair: Lauren Graziano, Clarion University (PA)

Tasha Cardwell, Park University (MO): Dating Kansas City

Katie Patterson-Hulett, Dixie State College of Utah (UT): Lessons in Wheat

Erin Sullivan, Assumption College (MA): Get Lost

Casie Trotter, Oklahoma Baptist University (OK): Community Coffee

I-2. Original Poetry: Dream-like State Friday 3:15-4:30 Bacchus, 4th floor

Moderator: Christopher Genre, Southeastern Louisiana University (LA)

Chair: Patrick Bryant, Winthrop University (SC)

Joseph Davis, Minot State University (ND): Thoughts of Awakening

Katherine Doss, University of Alabama, Huntsville (AL): When Night Come

Edward Szeman, Winthrop University (SC): Standing on Your Feet, I See Clearly Your Eyes

Scott Warkentien, Park University (MO): The Dream Weaver Bard

I-3. Original Fiction: Lost and Found Friday 3:15-4:30 Balcony I, 4th floor

Moderator: Rebecca Belcher-Rankin, Olivet Nazarene University (IL)

Chair: Crystal Lanucha, Westfield State College (MA)

Brooke Burney, Missouri Southern State University, Joplin (MO): The Regular

Britney Marko, Olivet Nazarene University (IL): Laughing

Meggan O'Neil, Pepperdine University (CA): Like a Boy

Angela Richardson, Northwest Missouri State University (MO): The Deacon

Sam Sam, University of Dubuque (IA): The Replacement

I-4. 16th/17th Century British Literature: Shakespeare Redux Friday 3:15-4:30 Balcony J, 4th floor

Moderator: Ty Hawkins, Walsh University (OH)

Chair: Aaron Dickey, University of Nebraska, Kearney (NE)

Kourtni Dingler, Samford University (AL): "More Matter for a May Morning:" The Tragic *Twelfth Night*

Steven Fregeau, Walsh University (OH): "Good" Enough for Kissing: The Text of *Hamlet*

Ian Hollenbaugh, Western Michigan University (MI): "That Going Shall Be Used with Feet": Rendering *King Lear* in Old English Meter

Caitlin Larracey, Bridgewater State University (MA): The Occult and Humanism in *The Tempest*

Concurrent Sessions

I-5. Theoretical Approaches to Jane Austen Friday 3:15-4:30 Balcony K, 4th floor
Moderator: Bruce Stevenson, California Lutheran University (CA)
Chair: Alexandra Bohannon, University of Central Oklahoma (OK)

Wren Cherney, California Lutheran University (CA): Syntagmatic Continuity in *Pride and Prejudice*
Matthew Gorgans, Mercer University (GA): Pride and Postmodernism: Gender in Literary Mash-ups
Patricia Long, Bowie State University (MD): Modified Slavery: *Mansfield Park* as an Allegory for Slavery
Christina Stopka-Rinnert, Mansfield University (PA): Teachers and Students in Jane Austen's *Emma* and *Persuasion*

I-6. Feminine or Feminist? 19th Century American Literature Friday 3:15-4:30 Balcony L, 4th floor
Moderator: Simone Billings, Santa Clara University (CA)
Chair: Jessica Baker, The College of New Jersey (NJ)

Janet Ake, University of Central Oklahoma (OK): Feminism and "The Yellow Wallpaper"
Amber Courtney, University of Alabama, Birmingham (AL): Imperial Feminism: Prejudice Culture Substantiated through Literature and Rhetoric
Joseph Forte, Santa Clara University (CA): Edgar Allen Poe: Feminist Hero or Sexist Humbert?
Rodney Foster, Park University (MO): Deconstructing the Faith of Young Goodman Brown

I-7. Vampires Take a Bite Out of Literature Friday 3:15-4:30 Balcony M, 4th floor
Moderator: Ken McGraw, Roanoke College (VA)
Chair: Kimberly Nania, Sacred Heart University (CT)

Ashley Aliengena, Roger Williams University (RI): The Persistent Other: Islam and Victorian Vampires
Maggie Christ, Roanoke College (VA): Reawakening Victorian Women: Reproductive Deviation in Bram Stoker's *Dracula*
Lauren Fowler, Concord University (WV): Children of the Night: *Dracula's* Influence on the Modern Vampire
Bess Klander, Concord University (WV): Bella Swan: Two Steps Backward for Feminism

I-8. 20th/21st Century American Novels Friday 3:15-4:30 Balcony N, 4th floor
Moderator: Felicia Steele, The College of New Jersey (NJ)
Chair: Barbara Wilson-Battles, Shawnee State University (OH)

Allie Martin, Freed-Hardeman University (TN): Father-Son Dynamic Used by Peter Taylor
John McCormack, The College of New Jersey (NJ): Education and Unseen Influence: The Deconstruction of "New" and "Old" Schools in *The Great Gatsby*
Brandon McNulty, King's College (PA): Examining Diction in "A City of Churches"

I-9. Moral Questions in World Literature Friday 3:15-4:30 Bonaparte, 4th floor
Moderator: Dorothy Robbins, Louisiana Tech University (LA)
Chair: Liz McQuistan, Morningside College (IA)

Amy Buck, Augusta State University (GA): Moral Perfectionism in Dostoevsky's *The Eternal Husband*
Kristin Farquharson, Louisiana Tech University (LA): Assigning Blame in *Chronicle of a Death Foretold*
Jamie King, University of Montevallo (AL): Uncanny Plant Growth: The Effect of the Atomic Bomb on Plant Life in Masuji Ibuse's *Black Rain*
Margo Moore, Oklahoma Christian University (OK): A Modest or an Indecent Proposal?

Concurrent Sessions

I-10. Original Poetry: Back Home

Friday 3:15-4:30

Iberville, 4th floor

Moderator: Rebecca Hess, La Sierra University (CA)

Chair: Kyrie Bair, Baker University (KS)

Margaret Bush, Liberty University (VA): Somewhere Home: Poems of Place

Jill Fennell, Southern Arkansas University (AR): Here and There

Marguerite Sargent, Chatham University (PA): A Woman's Home

Christopher Sonzogni, Elon University (NC): Home, or Something That Feels Like It

Patrick York, La Sierra University (CA): Inland Awoken: A Collection of Three Poems

I-11. Original Fiction: Risk Taking

Friday 3:15-4:30

Napoleon, 41st floor

Moderator: Traci Thomas-Card, University of Wisconsin, Eau Claire (WI)

Chair: Sheila Lansdale, University of Southern Mississippi Gulf Coast (MS)

Robert Bixler, Alma College (MI): Wire Trap

Rachel Jones, College of Notre Dame of Maryland (MD): Between the Branches, I Watch the Wind Blow

Christopher Miller, Western Michigan University (MI): Bellum Invictum

Justin Zyla, University of Nebraska, Kearney (NE): Unglorified Nirvana

I-12. Roundtable - Reawakening Hope: Reintroducing Literacy

Friday 3:15-4:30

St. Charles, 41st floor

Moderator: Andrew Moser, Metropolitan State College of Denver (CO)

Roundtable Participants:

Joseph Gerlick, Metropolitan State College of Denver (CO)

Britney Anne Leddy, Metropolitan State College of Denver (CO)

Celeste Lempke, University of Nebraska at Kearney (NE)

Roberto Martinez, Metropolitan State College of Denver (CO)

Sarah Schrupp, University of Wisconsin-Eau Claire (WI)

Jessica Snavlin, Portland State University (OR)

Abstract: This multi-chapter roundtable will focus on service projects which have created new readers and reawakened a love of reading in American children and/or adults: Comic Book Classroom, Ooligan Press, Saturdays at the Frank House, and other literacy projects. Audience members will be encouraged to share their own experiences and/or opportunities and ideas for chapter literacy projects.

Concurrent Sessions

I-13. Roundtable - *Bellocq's Ophelia: Re-Imagining History* Friday 3:15-4:30 Bissonet, 3rd floor
Moderator: Carrie Fitzpatrick, Alvernia University (PA)

Roundtable Participants:

Carly Glasmyre, Alvernia University (PA)
Maria Locicero, Alvernia University (PA)
Megan McCue, Alvernia University (PA)
JD Sellgren, Alumni Epsilon, Alvernia University (PA)
Michael Wagner, Alvernia University (PA)

Abstract: Using multimedia prompts of Natasha Tretheway's text and Ernest Bellocq's photography, roundtable participants will engage the audience in a discussion of the process of reconstructing historical fact through the use of creative fiction, looking in particular at racial and gender struggles.

I-14. Resume Writing Workshop Friday 3:15-4:30 Carondelet, 3rd floor
Sponsored by Alumni Epsilon Chapter
Moderator: Deborah Dessaso, University of the District of California, Washington DC

Session J: Saturday, March 3, 8:00-9:15 a.m.

J-1. Creative Nonfiction: Reflect Saturday 8:00-9:15 Regent, 4th floor
Moderator: Robert Scott, Ohio Northern University (OH)
Chair: Colin Whitworth, University of Alabama (AL)

Leah Kulikowski, Northern Michigan University (MI): The Last Resort
Shauna Neshek, Northern Michigan University (MI): The Waterfall
Joanna Persson, Ouachita Baptist University (AR): Just Enough
Renee Sammet, Ohio Northern University (OH): The Estates
Caitlin Scanlon, University of Pittsburgh, Johnstown (PA): The Floods of My Ancestors

J-2. Original Poetry: What Comes with Age Saturday 8:00-9:15 Bacchus, 4th floor
Moderator: Mark Cirino, University of Evansville (IN)
Chair: Kelly Cernetich, University of Pittsburgh, Johnstown (PA)

Kristin Dollar, Furman University (SC): Bildungsroman
Lindsey Durham, Lipscomb University (TN): Gunpowder and Candy
Stephanie Smith, Samford University (AL): Potential
Miranda Stinson, University Of Evansville (IN): Six Poems on Youth and Age
Rachel Walker, University of Rio Grande (OH): Young and Dumb

Concurrent Sessions

J-3. Original Fiction: Dream State **Saturday 8:00-9:15** **Balcony I, 4th floor**

Moderator: Raymond Ventre, Northern Michigan University (MI)

Chair: Robert Pannell, Missouri Valley College (MO)

Crystal Carver, Shawnee State University (OH): I Celebrate Myself: A Piece Inspired by the Novels of Four Young Adult Authors

Jenna Dawkins, Elon University (NC): Color Wonderful

Casey Kennedy, Westminster College (PA): Falling Down Stairs

Kaitlin Kregel, Northern Michigan University (MI): The Dream of a Woman

Grace Makley, Northern Michigan University (MI): Absolut

J-4. Roles Women Play **Saturday 8:00-9:15** **Balcony J, 4th floor**

Moderator: Glenn Steinberg, The College of New Jersey (NJ)

Chair: Danielle Rose, Freed-Hardeman University (TN)

Tiffany Carpenter, Saint Leo University (FL): The Role of the “Female Pen” in *Oroonoko*

Mariko Curran, The College of New Jersey (NJ): Not Just a Naysayer: The Layers of a Nigh-Sayer in 1600s London

Cayla Eagon, Winthrop University (SC): Narratological Projections in Behn’s *Oroonoko*

Noel Yucuis, Augusta State University (GA): First Class Human Beings: The Role of Women in Moral Perfectionism

J-5. Victorian and/or Later 19th Century **Saturday 8:00-9:15** **Balcony K, 4th floor**

British Literature: Pained Literature

Moderator: Kelly Battles, Maryville College (TN)

Chair: Kimberly Nania, Sacred Heart University (CT)

Morgan Hawk, Maryville College (TN): The Bloody Truth of Sherlock Holmes

Morgan Jackson-Flowers, University of Alabama (AL): The Enjoyment of Another’s Pain: Bertha’s Torment of Jane in *Jane Eyre*

Eugenia Purcar, Pepperdine University (CA): The Racism of Vampirism: Varney the Vampyre and Victorian Prejudice

Natalie Updike, University Of Evansville (IN): Torture, Testing, and Teaching: The Awakening of Sympathies in *Black Beauty* and *The Island of Dr. Moreau*

J-6. Important Names in 19th Century American Literature **Saturday 8:00-9:15** **Balcony L, 4th floor**

Moderator: Diane Scholl, Luther College (IA)

Chair: Michael Gincel, Saint Leo University (FL)

Gretchen Barkhuff, SUNY, College at Geneseo (NY): “Don’t You Know Me?”: Understanding Melville’s Question to America

Kaela Gedda, St. Norbert College (WI): Charlotte Perkins Gilman’s “The Yellow Wallpaper”: Writing to Serve

Tonya Tienter, Luther College (IA): *Huckleberry Finn*: Uncle Sam’s Calculated Betrayal

Rose Marie Wong, University of Scranton (PA): Fancy and Reason in Washington Irving’s “The Legend of Sleepy Hollow”

Concurrent Sessions

- J-7. Take on Drama** **Saturday 8:00-9:15** **Balcony M, 4th floor**
Moderator: Sheri Midkiff, Williams Baptist College (AR)
Chair: Amanda Mitchell, Western Kentucky University (KY)
- Kelsey Boone**, Samford University (AL): Searching for the Self in *The Cocktail Party*
Candy Finigan, Williams Baptist College (AR): Letty and Marcia: Living with Loneliness
Erika Patterson, Winthrop University (SC): *Murder in the Cathedral*: Delving into the Mind of Eliot Through a Psychoanalytic Study of Becket
Natasha Snyder, East Tennessee State University (TN): Character and Narrative Voice in *Aunt Dan and Lemon*
- J-8. Death Comes to 20th Century America** **Saturday 8:00-9:15** **Balcony N, 4th floor**
Moderator: Michel Aaij, Auburn University, Montgomery (AL)
Chair: Elizabeth Hageman, Thomas More College (KY)
- Flannery Crump**, Missouri Valley College (MO): Internalized Misogyny and the Dichotomy of Women's Roles in Flannery O'Connor's "Good Country People"
Sarah Fredericks, Auburn University, Montgomery (AL): The Rosy Glasses of Romanticism: Death and Murder in *The Adventures of Tom Sawyer*
Stephanie Healy, Park University (MO): American Dream Lost
Jessica Wilson, University of North Carolina, Wilmington (NC): Separating the Quick from the Dead: The Apocalyptic Trickster Figure in Flannery O'Connor's "Good Country People"
- J-9. Peering in on Critical Theory** **Saturday 8:00-9:15** **Bonaparte, 4th floor**
Moderator: Dorothy Robbins, Louisiana Tech University (LA)
Chair: Nicole Hazard, Pace University (NY)
- Tyler Easterbrook**, University of Pittsburgh, Johnstown (PA): Panphobia: Some Thoughts on Literary Theory
Jared Seymour, Central Michigan University (MI): Symbolic Exchange, Death, and the Posthuman Project
August Smith, Western Michigan University (MI): Will the Real T Cooper Please Stand Up?
Christina Thompson, Louisiana Tech University (LA): The Panoptic Gaze of Kafka's *The Trial*
- J-10. Original Poetry: With Ophelia and Edna** **Saturday 8:00-9:15** **Iberville, 4th floor**
Near New Orleans
Moderator: Christopher Genre, Southeastern Louisiana University (LA)
Chair: Paige Davis, Tulane University (LA)
- Marci Davis**, Portland State University (OR): Storyville Suite, an Ode to *Bellocq's Ophelia*
Ernestina Edoziem, University of Indianapolis (IN): Dear Ophelia
Genean Granger, Northern Michigan University (MI): Beyond Bellocq's Lens
Carly Trepagnier, Southeastern Louisiana University (LA): Grand Isle

Concurrent Sessions

J-11. A Deeper South: Indian and African Literature **Saturday 8:00-9:15** **Napoleon, 41st floor**

Moderator: Shelley Puhak, College of Notre Dame of Maryland (MD)

Chair: Lindsay Hodgens, University of Montevallo (AL)

Nicole Ciulla, St. Mary's University, Minnesota (MN): Author Responsibility and Narrative Value: Coetzee's Michael K as Question

Cara Corsaro, College of Notre Dame of Maryland (MD): Forgiveness Against All Odds

Heather Gerrish, Eastern Illinois University (IL): Language in the Rainbow Nation

Samantha Stokes, Sacred Heart University (CT): Inside the History House

J-12. Roundtable - Service Learning **Saturday 8:00-9:15** **St. Charles, 41st floor**
Reawakens Our Sense of Ourselves

Moderator: Simone Billings, Santa Clara University (CA)

Roundtable Participants:

Joseph Forte, Santa Clara University (CA)

Michael Lasley, Santa Clara University (CA)

Tanya Schmidt, Santa Clara University (CA)

Richard Teel, Santa Clara University (CA)

Abstract: Service learning often involves listening to other people tell their stories. Such active listening of oral literature can "renew our sense of ourselves, of what it means to love literature and language." Faculty and students will facilitate the sharing of varied experiences with service learning in which listening to others may "reawaken an author's words into a new reality: our own."

J-13. Roundtable - Reawakening the Value of English **Saturday 8:00-9:15** **Bissonet, 3rd floor**
and the Humanities in Higher Education

Moderator: John Zubizarreta, Columbia College, South Carolina (SC)

Roundtable Participants:

Keelan Fagan, Columbia College (SC)

Desirae Gostlin, Columbia College (SC)

Lilit Makaryan, Columbia College (SC)

Sarah Martin, Columbia College (SC)

Chelsea Rhodes, Columbia College (SC)

Abstract: This roundtable addresses the erosion of the humanities as priorities in higher education today and will offer testimonies of the power and utility of deep learning in humanities disciplines. The session is not for the quiet or faint of heart: audience members should come prepared for lively, interactive conversation to reawaken and reaffirm our passions in English.

Concurrent Sessions

Session K: Saturday, March 3, 9:30-10:45 a.m.

K-1. Creative Nonfiction: Forgiveness and Forgetfulness Saturday 9:30-10:45 Regent, 4th floor
Moderator: Vicki Cleveland, Allen University (SC)
Chair: Erica Roper, University of Central Oklahoma (OK)

Autumn Cahill, Rockhurst University (MO): Losing My Religion
Mariah Molnar, University of Wisconsin, Eau Claire (WI): Uncle August's Red Beard and Other Stories
Darnell Valentine, Allen University (SC): Forgiveness on 12th Street
Valerie Wooten, Augusta State University (GA): Learning to Forgive

K-2. Original Poetry: After Life Saturday 9:30-10:45 Bacchus, 4th floor
Moderator: Dana Aspinall, Alma College (MI)
Chair: Wren Cherney, California Lutheran University (CA)

John Benes, Alma College (MI): Fictional Aftermath
Courtney Bennett, University of Montevallo (AL): Godknowswhere: A Cladistic Narrative
Caleigh Cornell, University of North Carolina, Wilmington (NC): Eventually We'll Sing in Heaven
William Tierney, Mount Olive College (NC): Four Pessimistic Observations
Michael Winston, University of North Texas (TX): Permanence

K-3. Original Fiction: Fantastic Literature Saturday 9:30-10:45 Balcony I, 4th floor
Moderator: Kathy Nixon, American University of Kuwait (KU)
Chair: Desirae Gostlin, Columbia College, South Carolina (SC)

Matthew Schwager, Montana State University, Bozeman (MT): The Fourth-of-July Barbecue in Post-Apocalyptic America
Joshua Williams, American University of Kuwait (KU): Paranormality, Inc. - Mission Zero
Bethany Wood, Lee University (TN): Eternal Blossom
Jacinto Zambrano, St. Edward's University (TX): Famine's Books

K-4. What Makes a Man in Shakespeare? Saturday 9:30-10:45 Balcony J, 4th floor
Moderator: Courtney Bennett, University of Montevallo (AL)
Chair: Hillary Russell, University of Alabama (AL)

Alexandra Bohannon, University of Central Oklahoma (OK): Not Your Average Pubcrawler: Falstaff as a Manipulator
Mary-Catherine Breed, Pace University, New York Campus (NY): Shakespeare's Absent Fathers as Colonizers
Rachel Landers, University of Montevallo (AL): "Is Age by Any Other Name Still So Sweet?"
Sydnee Wagner, University of North Texas (TX): "True Jack Falstaff": The Fashioning of a Courtier within *Henry IV*

Concurrent Sessions

K-9. Original Drama/Screenplay: Curtains Up on Original Drama

Saturday 9:30-10:45

Bonaparte, 4th floor

Moderator: Kevin Brown, Lee University (TN)

Chair: Michael Gincel, Saint Leo University (FL)

Audrey Gearhart, Western Kentucky University (KY): On the Walls of Jericho

Kathryn O'Brien, Western Michigan University (MI): The Candelabra

Callie Smith, Lee University (TN): Pinholes in the Sky

K-10. Once Upon a Time

Saturday 9:30-10:45

Iberville, 4th floor

Moderator: Micah Dean Hicks, Florida State University (FL)

Chair: Mary Naiad Lopez, Barry University (FL)

Jessica Brown, Indiana University of Pennsylvania (PA): Of Princes, Princesses, Symbols, and Light Dashes of Feminism

Katelyn Bruffy, The College of New Jersey (NJ): Anne Elliot's Cinderella Story

Jennifer DuBois, University of Central Oklahoma (OK): Mother Goose to Disney: The Progression of the Fairy Tale

Megan Power, Westminster College (PA): Little Red: Feminist through the Ages

K-11. Roundtable - I Have a Secret That Everybody Knows: Reality Television and Popular Reading

Saturday 9:30-10:45

Bissonet, 3rd floor

Moderator: Arlan Hess, Washington & Jefferson College (PA)

Roundtable Participants:

Rebecca Hendricks, Washington and Jefferson College (PA)

Sara Kissel, Washington and Jefferson College (PA)

Katie Pagano, University of Pittsburgh at Greensburg (PA)

Julia Thomas, Washington and Jefferson College (PA)

Abstract: This roundtable explores the relationship between literature and television as popular forms of entertainment. While television viewers and readers have traditionally been characterized differently, recent trends suggest an overlap in their preferences. We will discuss current trends in entertainment, the forces driving these trends and the future effects of these patterns.

K-12. Roundtable - Where Truth Ends and Fiction Begins

Saturday 9:30-10:45

Napoleon, 41st floor

Moderator: Bill Davis, Notre Dame of Maryland University (MD)

Roundtable Participants:

Allegra Barlow, Minnesota State University Moorhead (MN)

Lisa Howard, College of Notre Dame of Maryland (MD)

Jamee Larson, Minnesota State University Moorhead (MN)

Shelly Puhak, College of Notre Dame of Maryland (MD)

Abstract: Roundtable participants from two chapters will discuss the question of where the lines should be drawn between truth and fiction in the Creative Nonfiction genre. Audience members will be encouraged to help define the genre as they share their views and raise questions to be explored during the session.

Hotel Maps

2ND FLOOR

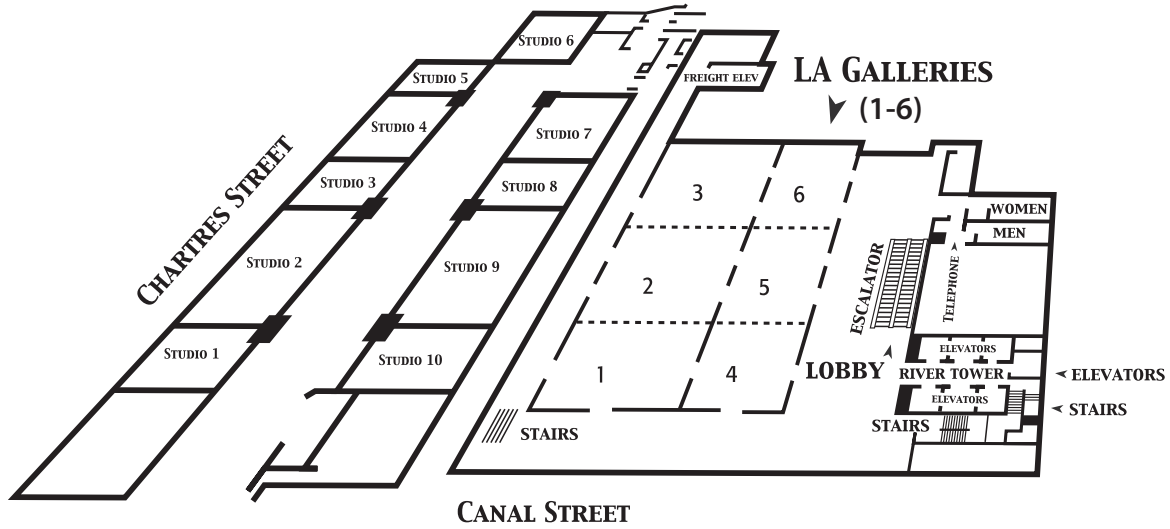

3RD FLOOR

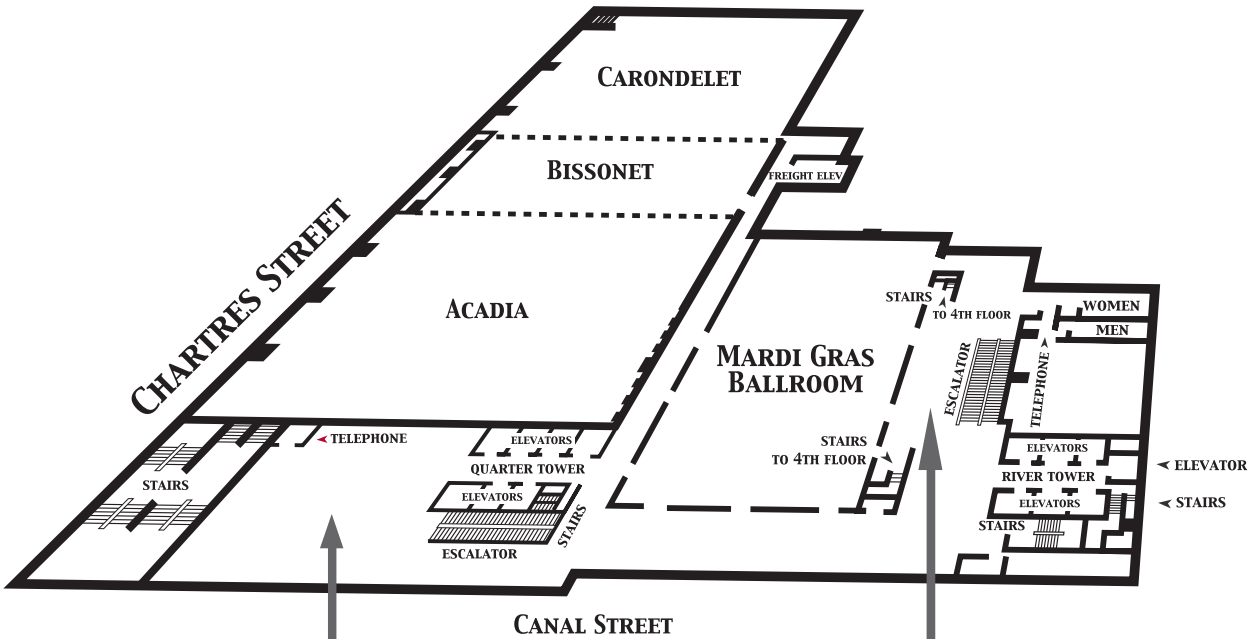

Registration & Better World Books
3/1 - 3/3
Chapter Merchandise Sales
3/2 & 3/3

Registration & Better World Books
2/29

4TH FLOOR

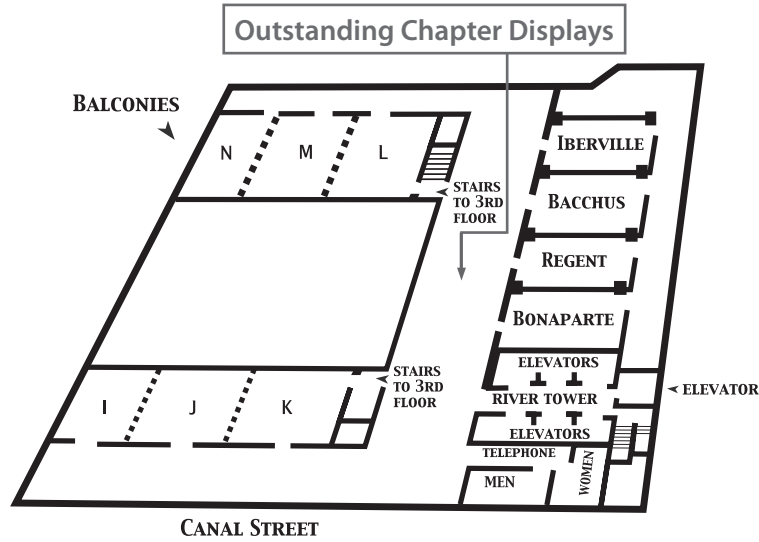

ROOMS	FLOOR
Acadia.....	3
Audubon.....	5
Bacchus.....	4
Balconies I - N.....	4
Bissonet.....	3
Bonaparte.....	4
Carondelet.....	3
Iberville.....	4
La Galeries 4 - 6.....	2
Lafayette.....	41
Napoleon.....	41
Regent.....	4
Riverview.....	41
St. Charles.....	41

5TH FLOOR

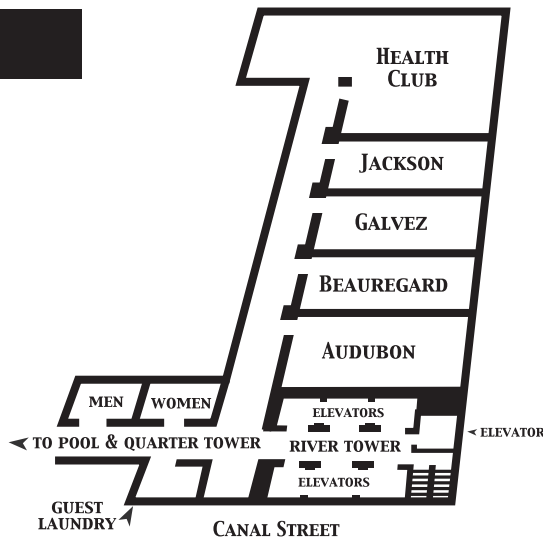

41ST FLOOR

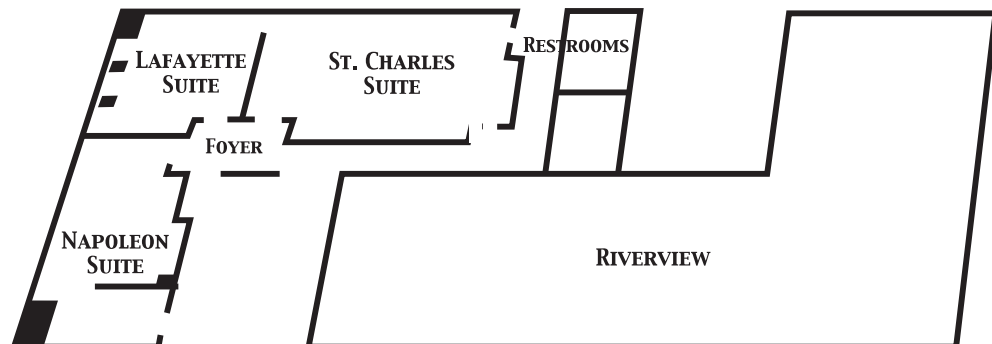

Concurrent Sessions

K-13. Roundtable - Buying and Selling the Body with Words **Saturday 9:30-10:45** **St. Charles, 41st floor**
Moderator: Peter Scholl, Luther College (IA)

Roundtable Participants:

Allison Marie Croat, Luther College (IA)
Antonia Lliteras Espinosa, Luther College (IA)
Danielle Koch, Luther College (IA)
Hannah Louise Lund, Luther College (IA)
Tonya Ann Tienter, Luther College (IA)

Abstract: In *Bellocoq's Ophelia*, Ophelia's humanity has several levels. This roundtable will explore whether history, plot, and the artist's agenda intend to sell or free the human body. Audience members are invited to decide if at any or all of these levels, the body is rendered a product -a nonliving economic asset.

K-14. Student Leadership Workshop: **Saturday 9:30-10:45** **Carondelet, 3rd floor**
Building Interchapter Relations

Session L: Saturday, March 3, 11:00-12:15 pm

L-1. Creative Nonfiction: Freedom **Saturday 11:00-12:15** **Regent, 4th floor**
Moderator: Kevin Stemmler, Clarion University (PA)
Chair: Tyler Keal, Baker University (KS)

Amber Graves, St. Martin's University (WA): Seeking Independence Day
Lauren Graziano, Clarion University (PA): Falling in Loath with a Boy
Adriana Montenegro, St. Edward's University (TX): Bird of Paradise
Natasha Morgan, Western Illinois University (IL): The Price of Freedom

L-2. Original Poetry: Pen to Paper **Saturday 11:00-12:15** **Bacchus, 4th floor**
Moderator: Robert Crafton, Slippery Rock University (PA)
Chair: Christa Hedman, University of Southern Mississippi Gulf Coast (MS)

Andrew Blake, Auburn University, Montgomery (AL): The Mothering Word/Fragments of a Last July
Keegan Bradford, Liberty University (VA): Standing Completely Still
Hannah Lund, Luther College (IA): "Dandelion," "A Word"
Dylan Phillips, Winthrop University (SC): Lost Words: A Selection of Poetry
Ashley Ranck, Slippery Rock University (PA): To Write What Is True and to Right What Is Wrong

Concurrent Sessions

L-3. Original Fiction: Dreaming of Children Saturday 11:00-12:15 Balcony I, 4th floor
Moderator: Raymond Ventre, Northern Michigan University (MI)
Chair: Shaye Champ, University of Nebraska, Kearney (NE)

Jason Curlin, Ouachita Baptist University (AR): Under the Covers: A Child's Tale
Jacqueline Kirley, Thomas More College (KY): Baby Teeth
Miah Saunders, High Point University (NC): Daydreams of a One-Eyed Monster
Max Wojciechowski, Northern Michigan University (MI): Bedtime Story

**L-4. 16th/17th Century British Literature:
The Method in Shakespeare's Madness** Saturday 11:00-12:15 Balcony J, 4th floor
Moderator: Kevin Brown, Lee University (TN)
Chair: Phillip Harvey, University of Central Oklahoma (OK)

Elizabeth Barber, SUNY, College at Geneseo (NY): "Y" are much deceived": Edgar's Dover Cliffs and Reality and Imagination in *King Lear*
Kari Bowles, Emporia State University (KS): Truth through Artifice in Shakespearean Romance
Brittany Sines, Lee University (TN): Men Drove Ophelia Mad
Mariah Varner, Lee University (TN): The Method to Ophelia's Madness

L-5. Austen Writes Women Saturday 11:00-12:15 Balcony K, 4th floor
Moderator: Hannah Freeman, University of Pikeville (KY)
Chair: Mary Naiad Lopez, Barry University (FL)

Jennifer Charles, University of Pikeville (KY): Female Novelists and Feminine Intellect
Jamie Primeau, The College of New Jersey (NJ): Harriet as a creation of Emma and Austen
Emily Spanjers, University of Wisconsin, Eau Claire (WI): Space, Character, and Gender in *Pride and Prejudice*
Jacob Swanson, Western Michigan University (MI): Anne's Redemption in Austen's *Persuasion*

L-6. Law and Conflict in 19th Century America Saturday 11:00-12:15 Balcony L, 4th floor
Moderator: Timothy Helwig, Western Illinois University (IL)
Chair: Derek Warden, Louisiana Tech University (LA)

Brittany Barrie, Western Illinois University (IL): Fredrick Douglass and William Wells Brown Deconstructing
Sarah Evans, University of Scranton (PA): The Lawyer's Conflict in Herman Melville's "Bartleby, the Scrivener, A Story of Wall-Street"
Zach Gall, The College of New Jersey (NJ): Respect the (White)man's Law: Male Agency in *Son of the Wolf*
Robin Miller, California State University, Fullerton (CA): Olla Podrida: Transcendentalist Dissent in Harriet Beecher Stowe's *Uncle Tom's Cabin*

Concurrent Sessions

L-7. The Literary Diagnosis **Saturday 11:00-12:15** **Balcony M, 4th floor**

Moderator: Sarah Dangelantonio, Franklin Pierce University (NH)

Chair: Kristina Epperson, Minot State University (ND)

Sara Hunt, Chapman University (CA): Unreliability, Fear, Dread, and The Uncanny

Laura Milanak, Westminster College (PA) (PA): Paranoid Schizophrenia in Gruen's *Water for Elephants*

Ryan Rivard, Marist College (NY): Psychotic Window: An Extreme Close-Up on Marion Crane and Marie Samuels

Tawni Turcotte, Franklin Pierce University (NH): Psychiatry: *The Bell Jar* and *One Flew Over the Cuckoo's Nest*

L-8. 20th/21st Century American Literature: **Saturday 11:00-12:15** **Balcony N, 4th floor**

Short Stories in Women's Hands

Moderator: Cynthia Murillo, Tennessee State University (TN)

Chair: Jonathan Barefield, Central Michigan University (MI)

Lilit Makaryan, Columbia College, South Carolina (SC): Susan Glaspell's "A Jury of Her Peers" Revisited

Justine Nixon, Sam Houston State University (TX): The Triumph of the "No Name Woman"

Lauren VanderLind, Northern Michigan University (MI): Jouisance and Pleasure in Alice Munro

Becky Woodruff, Otterbein College (OH): "Random Underlinings"?: The Truth in Detail in Edith Wharton's "Roman Fever"

L-9. 20th/21st Century American Literature: Hemingway **Saturday 11:00-12:15** **Bonaparte, 4th floor**

Moderator: Sandra Petrulionus, Penn State Altoona (PA)

Chair: Kayla Hare, University of Alabama (AL)

Nadia Barksdale, University of Alabama (AL): "Nada" and the Hemingway Code

Julia Catalano, Ithaca College (NY): "Darling, let's not talk rot": Interactive Cultures in Hemingway's *The Sun Also Rises*

Erin Horning, Penn State Altoona (PA): Lacan and Hemingway

Isabel Silva, King's College (PA): Crafting Language: Hemingway's "Hills Like White Elephants"

L-10. Original Poetry: Stitched Together **Saturday 11:00-12:15** **Iberville, 4th floor**

Moderator: Sarah Vogt, Thomas More College (KY)

Chair: Ashlee Bernhardt, Minnesota State University, Moorhead (MN)

Patrick Bryant, Winthrop University (SC): Rummage

Ellie Douglass, St. Edward's University (TX): Little Cup

Caitlin Drouillard, Thomas More College (KY): Poetry Pieces

Deihlia Flett, Broward College (FL): On Meeting a Stranger I Knew at Tine

Katie Pagano, University of Pittsburgh, Greensburg (PA): Tight Weaving and Other Agitations

Concurrent Sessions

- L-11. Questions of Identity in 20th/21st Century** **Saturday 11:00-12:15** **Napoleon, 41st floor**
American Literature
Moderator: William Dynes, University of Indianapolis (IN)
Chair: Cody McConnell, Clarion University (PA)
Rachel Carmody, Franklin Pierce University (NH): Oppressing the I Out of Bobby
Zheng Fang, University of Indianapolis (IN): Hibernation, the Rebirth
Missy Wallace, Louisiana Tech University (LA): “He is Born Again and Not of Woman”: The Womb and Rebirth in *All the King’s Men*
Samantha Zimbler, The College of New Jersey (NJ): “An Appalling Love”: Differential Consciousness and Agnes’ Syncretic Identity
- L-12. Roundtable - Teaching Taboo: Tackling Sensitive** **Saturday 11:00-12:15** **St. Charles, 41st floor**
Classroom Issues in the Midst of the Bible Belt
Moderator: Sherri Craig, Southeastern Louisiana University (LA)
Roundtable Participants:
Brandon Bender, Southeastern Louisiana University (LA)
Christopher Cook, Southeastern Louisiana University (LA)
Christopher Genre, Southeastern Louisiana University (LA)
Rebecca Murry, Southeastern Louisiana University (LA)
Abstract: The university classrooms in rural Louisiana and other states ensconced in the Bible Belt often face difficulties in the classroom with censorship, self censorship, faith-based argument, and topics outside personal comfort zones. This panel will explore how to turn uncomfortable classroom roadblocks into teachable moments.
- L-13. Roundtable - U.S. Disaster Literature:** **Saturday 11:00-12:15** **Bissonet, 3rd floor**
Natural, Economic, and Emotional
Moderator: Sidney Watson, Oklahoma Baptist University (OK)
Roundtable Participants:
Patricia Dalini, Northeastern Illinois University (IL)
Kristina Garcia, Northeastern Illinois University (IL)
Aaron Leiva, Northeastern Illinois University (IL)
Abstract: This roundtable will engage the audience in a lively discussion about the importance of discussing and analyzing literature that depicts natural and economic disasters. Such literature draws attention to national catastrophes, becoming the impetus for disaster relief, as well helping those indirectly affected to empathize.
- L-14. Natasha Trethewey Workshop** **Saturday 11:00-12:15** **Acadia, 3rd floor**
- L-15. Sigma Kappa Delta Faculty Sponsor Meeting** **Saturday 11:00-12:15** **Audubon, 5th floor**

Concurrent Sessions

Session M: Saturday, March 3, 1:45-3:00 pm

M-1. Creative Nonfiction: From Beginning to End Saturday 1:45-3:00 Regent, 4th floor

Moderator: Chad Schrock, Lee University (TN)

Chair: Zita Cambra, Bridgewater State University (MA)

Lance Buchanan, Lee University (TN): Footloose

Stephanie Lehman, Westminster College (PA): All Endings Are Also Beginnings

Melanie Pawlikowski, Fort Lewis College (CO): Metamorphosis

Rachael Shockey, Marist College (NY): I'll Tell You What's in a Name

M-2. Original Poetry: Study of Nature Saturday 1:45-3:00 Bacchus, 4th floor

Moderator: Megan Holt, Tulane University (LA)

Chair: Amy Buck, Augusta State University (GA)

Cody Greene, Elon University (NC): Life Science: How to Study Your Lab Partner

Katherine Hines, Tulane University (LA): Animal Logic

Andrea D. Merry, University of Rio Grande (OH): Bio-Chemistry within Poetry

Jessica Thelen, Westfield State College (MA): Secrets of the Mind

M-3. Original Fiction: GLBT Saturday 1:45-3:00 Balcony I, 4th floor

Moderator: Jessica Snavlin, Metropolitan State College of Denver (Alumna)

Chair: Nicole Hazard, Pace University (NY)

Katrina Cavarno, Chapman University (CA): Gravity

Holly Combs, Loyola University, New Orleans (LA): Her Secondhand Smoke

Kristen Inman, Northwest Missouri State University (MO): Nothing More Than

Lauren Santaniello, Ramapo College of New Jersey (NJ): The Final Account of Anna Benson

**M-4. Gender Roles in Anglo Saxon
and Medieval British Literature** Saturday 1:45-3:00 Balcony J, 4th floor

Moderator: James Matthews, Fairmont State University (WV)

Chair: Leah Rajchel, Cardinal Stritch University (WI)

Shasta Gibson, Fairmont State University (WV): Magic Makes Right: Husband-Testing in the Middle Ages

Lillian Grappe, Louisiana Tech University (LA): The Wife of Bath: a Tragic Caricature of Women

Richelle Peryea, Lincoln Memorial University (TN): Crossing the Gender Line: Arcite's Doom Foretold

Amy Weaver, Lycoming College (PA): The Power of the Chaste Woman: Female Emancipation in Anglo-Saxon England
Through "Just Say No"

Concurrent Sessions

M-5. An Unreal World of Literature

Saturday 1:45-3:00

Balcony K, 4th floor

Moderator: Doug Sonheim, Ouachita Baptist University (AR)

Chair: Phillip Harvey, University of Central Oklahoma (OK)

Emily Davis, Ouachita Baptist University (AR): Ruins, Rings, and Redemption: Morality in Middle Earth

Blake London, Southern Utah University (UT): The Heroic Snape: Exploring a Hidden Protagonist of Harry Potter

Courtney Mantz, Minot State University (ND): A Parallel of Political Conformity in Ray Bradbury's *The Martian Chronicles*

Katherine Williams, Arkansas Tech University (AR): The Infernal Identity Machines of Dr. Hoffman

M-6. 19th Century American Literature:

Saturday 1:45-3:00

Balcony L, 4th floor

Obsession and Guilt in Poe

Moderator: Timothy Helwig, Western Illinois University (IL)

Chair: Katherine Nichols, Sacred Heart University (NH)

Vivian Givhan, University of Alabama (AL): "Que tous ses dents etaient des idees": Egaeus's Determination to Reassert Male Power

Ethan Knight, Western Illinois University (IL): Manifestations of Guilt: 19th Century Homosexuality in Edgar Allan Poe's "The Black Cat"

Robert Pannell, Missouri Valley College (MO): The Arabesque and the Sublime In Edgar Allan Poe's "The Fall of the House of Usher" and "Metzengerstien"

Kimberly Smith, University of West Georgia (GA): Where I Go to Forget: "Ulalume"

M-7. Turn Up the Music

Saturday 1:45-3:00

Balcony M, 4th floor

Moderator: Larry Dennis, Clarion University (PA)

Chair: Austin Hall, Westfield State College (MA)

Kirk Barrett, University of North Carolina, Wilmington (NC): "Then He Was a She"

Danielle Dahlkoetter, Morningside College (IA): What's in a Song?

Brittany Morgan, Franklin Pierce University (NH): Improvising for Identity: The Role of Jazz in *Invisible Man*

Amanda Turnbull, Clarion University (PA): Portrayal of America through the Music of John Mellencamp

M-8. Space and Grace in Toni Morrison

Saturday 1:45-3:00

Balcony N, 4th floor

Moderator: Linda Tucker, Southern Arkansas University (AR)

Chair: Amanda Shaheen, University of Pittsburgh, Johnstown (PA)

Patrick Boyd, Louisiana Tech University (LA): Panoptic Paradoxes: Control and Captivity in Morrison's *Beloved*

Elizabeth Gershon, McKendree University (IL): Cut Off from Grace: Failure of Spiritual Segregation in *Paradise*

Emma Gratton-Fisher, Chatham University (PA): "Locked in a love that wore everyone out": Crime in Toni Morrison's *Beloved*

Daniel Kasper, Southern Arkansas University (AR): "She moved him": Postmodern Manhood and the Space of the Male in Toni Morrison's *Beloved*

Concurrent Sessions

M-9. Marx the Spot **Saturday 1:45-3:00** **Bonaparte, 4th floor**

Moderator: Robert Crafton, Slippery Rock University (PA)

Chair: Justin Greer, Southeastern Louisiana University (LA)

Marie Henrich, Slippery Rock University (PA): Lukewarm in Literary Theory

Arkeeda Jones, Bennett College for Women (NC): Marxism and the Metamorphosis

Lauren Laird, Slippery Rock University (PA): Marx and Althusser: Theories Applied to “Know Your Enemy”

M-10. East Meets West **Saturday 1:45-3:00** **Iberville, 4th floor**

Moderator: Laurie MacDiarmid, St. Norbert College (WI)

Chair: Francesca Baratta, Ramapo College of New Jersey (NJ)

Kristopher Bennelfield, Calhoun Community College (AL): Reawakening Romanticism in Herman Hesse’s *Siddhartha*

Joseph Noble, Saint Vincent College (PA): The Sun Rises in the East: Herman Melville’s Prediction of the Japanese Challenge to American Hegemony in the Pacific

Gretchen Panzer, St. Norbert College (WI): Gender and Power in Salman Rushdie’s *Midnight’s Children*: The Implications of “The Widow”

Teresa Sherman-Jones, Northern Michigan University (MI): Breaking Through the Silence: Writing as a Means of Giving and Claiming Voice

M-11. Original Fiction: There’s No Place Like... **Saturday 1:45-3:00** **Napoleon, 41st floor**

Moderator: Judith John, Missouri State University (MO)

Chair: Anna Blake, Washington & Jefferson College (PA)

Madelyn Gates, Western Kentucky University (KY): Of Willow and Ash

Rob Pickering, Missouri State University (MO): Chicken Dinner

Mike Thies, University of Wisconsin, Eau Claire (WI): Ivory

M-12. Roundtable - *Twilight*: Sublime or Ridiculous? **Saturday 1:45-3:00** **St. Charles, 41st floor**

Moderator: Elisa Beshero-Bondar, University of Pittsburgh, Greensburg (PA) and
Kevin Stemmler, Clarion University (PA)

Roundtable Participants:

Ann Deibert, Clarion University (PA)

Tessa Gilles, Clarion University (PA)

Gloria Grancea, University of Pittsburgh at Greensburg (PA)

Marquis Lewis, Clarion University (PA)

Sarah O’Neil, University of Pittsburgh at Greensburg (PA)

Gayle Temple, University of Pittsburgh at Greensburg (PA)

Abstract: This roundtable joins two chapters to evaluate the popular *Twilight* series of novels by Stephanie Meyers. The discussion will evaluate *Twilight*’s potential for long-term literary significance, its treatment of the sublime and its approach to the Gothic literary tradition, as well as its benefits or disadvantages for young readers.

Concurrent Sessions

N-5. Ideal Victorians

Saturday 3:15-4:30

Balcony K, 4th floor

Moderator: Glen Brewster, Westfield State College (MA)

Chair: Ashley Aliengena, Roger Williams University (MA)

Laura Kizior, North Central College (IL): Teaching and Transformation in *Vice Versa* and *The Prince and the Pauper*

Mary Kizior, North Central College (IL): *Treasure Island*: Reawakening the Victorian Moral Code

Luanne Spence, St. Norbert College (WI): Exploring Religious Uncertainty in MacDonald's "The Golden Key"

Amy Woody, Westfield State College (MA): Great Maternal Expectations: Dickens' Challenge of the Victorian Maternal Ideal

N-6. 19th Century American Literature: *The Coquette*

Saturday 3:15-4:30

Balcony L, 4th floor

Moderator: Laurie MacDiarmid, St. Norbert College (WI)

Chair: Nancy Love, Lyon College (AR)

Stephanie Harrelson, Coker College (SC): Accepting Responsibility in *The Coquette*

Hailee Kizima, Minot State University (ND): *The Coquette*: A Feminist Reading

Hannah Schmitt, St. Norbert College (WI): Girl Talk: Female Friendships in *The Coquette*

N-7. The Magic in the Machine

Saturday 3:15-4:30

Balcony M, 4th floor

Moderator: Julianne Smith, Pepperdine University (CA)

Chair: Allegra Barlow, Minnesota State University, Moorhead (MN)

Lauren Benke, Chapman University (CA): The Voice of the Clock: Auden's Portrayal of Time

Montserrat Luna, Pepperdine University (CA): Rápido Corren Los Trenes: The Role of Trains in *One Hundred Years of Solitude* and *Anna Karenina*

Serena Tenison, University of Louisiana, Monroe (LA): Laura Mulvey's Visual Pleasure Applied to Duigan's Production of *Wide Sargasso Sea*

Devin White, Lee University (TN): Cinema, Paradise, and Nostalgia

N-8. 20th/21st Century American Literature: Shaking Traditions

Saturday 3:15-4:30

Balcony N, 4th floor

Moderator: Traci Thomas-Card, University of Wisconsin, Eau Claire (WI)

Chair: Leslie Manning, Auburn University, Montgomery (AL)

Maria Conti, Walsh University (OH): Frost's Poetry: Blurring Bounds of Modernism

Megan Dowell, Olivet Nazarene University (IL): Trust from Tribulation

Lauren Glenn, Freed-Hardeman University (TN): Separation Illustrates Unity

Melissa Miller, University of Wisconsin, Eau Claire (WI): Complicating the Traditional Narrative: *Peyton Place* and the Myth of Victory Culture

N-9. Original Fiction: Lost in Water

Saturday 3:15-4:30

Bonaparte, 4th floor

Moderator: Marie DiFilippo, Rockhurst University (MO)

Chair: Michael Murray, John Carroll University (OH)

Zechariah Brewer, Southeastern Louisiana University (LA): Floods and Foxes

Joshua Garcia, Union University (TN): Mother Ocean Son

Alexa Johnson, Elon University (NC): Swimming Without Rest

Cameron Summers, Rockhurst University (MO): Swimming Hole

Brandon Taylor, Auburn University, Montgomery (AL): Cold River

Concurrent Sessions

N-10. Original Poetry: Without a Compass

Saturday 3:15-4:30

Iberville, 4th floor

Moderator: John Pennington, St. Norbert College (WI)

Chair: Jacinto Zambrano, St. Edward's University (TX)

Christopher Bernstorff, Lycoming College (PA): Move

Jordan Godfrey, Oklahoma Baptist University (OK): Diary of a Vagabond

Zachary Heine, St. Edward's University (TX): Feet at the Door

Joshua Prestin, Northwest Nazarene University (ID): Selected Poems and Musings

Emily Webb, SUNY, College at Geneseo (NY): Rambling Through Life

N-11. Roundtable - Better Students or Better People?

Saturday 3:15-4:30

Napoleon, 41st floor

The Role of Ethics in a University Education

Moderator: Marybeth Davis, Liberty University (VA)

Roundtable Participants

Keegan Bradford, Liberty University (VA)

Bridie MacDonald, Central Michigan University (MI)

Katie Smith, Liberty University (VA)

Lucas Wilson, Liberty University (VA)

Ian Wolfe, Central Michigan University (MI)

Abstract: Since its inception, the university has attempted to articulate boundaries between intellectual and moral education. This discussion will draw upon experiences of students from both a private liberal arts and a public state university to endeavor an explanation of the extent to which ethics belong in a university education.

N-12. Roundtable - The New Orleans Writing Marathon:

Saturday 3:15-4:30

St. Charles, 41st floor

Chapter Ideas

Moderator: George Dorrill, Southeastern Louisiana University (LA)

Roundtable Participants:

Christopher Cook, Southeastern Louisiana University (LA)

Sherri Craig, Southeastern Louisiana University (LA)

Justin Greer, Southeastern Louisiana University (LA)

Leigh Rourks, Southeastern Louisiana University (LA)

Abstract: Students, alumni, and faculty co-sponsors will describe the New Orleans Writing Marathon and how chapters may adapt it to their own needs. All panelists have led or participated in writing marathons, and, schedule permitting, propose to lead a New Orleans Writing Marathon immediately after the roundtable.

Index: Session Chairs

- Aliengena, Ashley (Roger Williams University, MA): N-5
Baker, Jessica (The College of New Jersey, NJ): E-8, I-6
Baratta, Francesca (Ramapo College of New Jersey, NJ): M-10
Barefield, Jonathan (Central Michigan University, MI): L-8
Barlow, Allegra (Minnesota State University Moorhead, MN): D-2, N-7
Bernhardt, Ashlee (Minnesota State University Moorhead, MN): L-10, N-3
Bair, Kyrie (Baker University, KS): A-1, I-10
Blake, Anna (Washington & Jefferson College, PA): M-11
Bohannon, Alexandra (University of Central Oklahoma, OK): I-5
Bruffy, Katelyn (The College of New Jersey, NJ): N-4
Bryant, Patrick (Winthrop University, SC): I-2
Buck, Amy (Augusta State University, GA): M-2
Burke, Daniella (Lipscomb University, TN): G-1
Byrd, Antonio (Auburn University Montgomery, AL): H-3
Cambra, Zita (Bridgewater State University, MA): M-1
Cernetich, Kelly (University of Pittsburgh Johnstown, PA): E-1, J-2
Champ, Shaye (University of Nebraska Kearney, NE): L-3
Cherney, Wren (California Lutheran University, CA): K-2
Coro, Gabriella (Barry University, FL): D-5, F-5
Creech, Heather (Southern Arkansas University, AR): H-9
Davis, Paige (Tulane University, LA): J-10
Dickey, Aaron (University of Nebraska Kearney, NE): I-4
Durborow, Robert (Southern Utah University, UT): N-2
Easley, Esther (Harris-Stowe State University, MO): B-7, H-10
Easterling, Tamia (Tennessee State University, TN): B-10, F-9
Epperson, Kristina (Minot State University, ND): A-8, L-7
Feldman, Will (Minot State University, ND): C-4, G-2
Fennell, Jill (Southern Arkansas University, AR): C-1
Flynn, Jeremy (Saint Vincent College, PA): G-3, K-5
Gardner, Elleigh (Southern Arkansas University, AR): H-8
Gincel, Michael (Saint Leo University, FL): J-6, K-9
Gostlin, Desirae (Columbia College South Carolina, SC): E-3, K-3
Graziano, Lauren (Clarion University, PA): I-1
Greer, Allison (The College of New Jersey, NJ): E-9, H-6
Greer, Justin (Southeastern Louisiana University, LA): E-6, M-9
Haas, Kayla (Oklahoma Christian University, OK): F-1, H-5
Hageman, Elizabeth (Thomas More College, KY): D-7, J-8
Hall, Austin (Westfield State College, MA): A-5, M-7
Hare, Kayla (University of Alabama, AL): A-4, L-9
Harvey, Phillip (University of Central Oklahoma, OK): L-4, M-5
Hazard, Nicole (Pace University, NY): J-9, M-3
Hebson, Amanda (Westfield State College, MA): B-8, E-12
Hedman, Christa (University of Southern Mississippi Gulf Coast, MS): L-2
Hodgens, Lindsay (University of Montevallo, AL): D-8, J-11
Horn, Jessica (Blue Mountain College, MS): C-10
Ierien, Jodi (University of Texas San Antonio, TX): B-1, G-9
Jackson, Cady (Oklahoma Christian University, OK): F-7, H-4
Keal, Tyler (Baker University, KS): H-1, L-1
Kemp, Matthew (Auburn University Montgomery, AL): F-2
Lansdale, Sheila (University of Southern Mississippi Gulf Coast, MS): B-3, I-11
Lanucha, Crystal (Westfield State College, MA): C-2, I-3
Larracey, Caitlin (Bridgewater State University, MA): A-7
Littlejohn, Jessica (University of Montevallo, AL): C-7, D-4
Love, Nancy (Lyon College, AR): C-6, N-6
Lowery, Tabitha (Southern Arkansas University, AR): H-7
MacDonald, Bridie (Central Michigan University, MI): F-10
Makley, Grace (Northern Michigan University, MI): F-3
Manning, Leslie (Auburn University Montgomery, AL): A-6, N-8
McConnell, Cody (Clarion University, PA): C-9, L-11
McCoy, Jed (Morningside College, MA): F-8
McGee, Daniel (Alma College, MI): K-8
McNulty, Brandon (King's College, PA): C-8
McQuistan, Liz (Morningside College, IA): D-12, I-9
Mitchell, Amanda (Western Kentucky University, KY): G-8, J-7
Murray, Michael (John Carroll University, OH): B-2, N-9
Naiad Lopez, Mary (Barry University, FL): K-10, L-5
Nania, Kimberly (Sacred Heart University, CT): I-7, J-5
Newsom, Kimberly (Chapman University, CA): B-6
Nichols, Katherine (Sacred Heart University, NH): D-6, M-6
O'Connor, Rosemarie (Western Kentucky University, KY): G-10
Pannell, Robert (Missouri Valley College, MO): J-3
Pine, Chelsea (Central Michigan University, MI): D-10
Ponder, Marci (Morningside College, IA): G-5, D-11
Pugh, Brandi (University of Pikeville, KY): G-11, K-7
Rajchel, Leah (Cardinal Stritch University, WI): G-12, M-4
Richardson, Angela (Northwest Missouri State University, MO): B-9
Richardson, Katelyn (College of Notre Dame of Maryland, MD): A-2, K-6
Roper, Erica (University of Central Oklahoma, OK): H-2, K-1
Rose, Danielle (Freed-Hardeman University, TN): F-11, J-4
Russell, Hillary (University of Alabama, AL): F-6, K-4
Schrupp, Sarah (University of Wisconsin Eau Claire, WI): E-10, H-11
Schwager, Matthew (Montana State University Bozeman, MT): E-7
Shaheen, Amanda (University of Pittsburgh Johnstown, PA): G-6, M-8
Shanafelt, Chase (Morningside College, IA): E-11
Shelton, Kimberly (Blue Mountain College, MS): B-4, E-4
Sullivan, Alexis (University of Scranton, PA): C-3
Thompson, Lacie (Southwestern Oklahoma State University, OK): D-9
Turcotte, Tawni (Franklin Pierce University, NH): E-2
Turnbull, Amanda (Clarion University, PA): N-1
Unthank, Victoria (Erskine College, SC): B-5, E-5
Villalobos, Monique (California Lutheran University, CA): D-1, G-4
Warden, Derek (Louisiana Tech University, LA): F-4, L-6
Whitworth, Colin (University of Alabama, AL): J-1
Wilson, Kelli (Ouachita Baptist University, AR): A-3, D-3
Wilson-Battles, Barbara (Shawnee State University, OH): I-8
Zambrano, Jacinto (St. Edward's University, TX): N-10

Index: Presenters and Roundtable Participants

- Abraham, Sarah (Penn State Altoona, PA): D-10
Adamczyk, Jessie (LaGrange College, GA): N-2
Adams-Hanley, Gloria (St. Edward's University, TX): H-2
Addleman, Cassandra (University of Nebraska, Omaha, NE): D-4
Adkins, Jordan (University of Pikeville, KY): E-1
Ake, Janet (University of Central Oklahoma, OK): I-6
Al Akilli, Maryam (American University of Kuwait, Kuwait): C-12
Al Bloushi, Ayat (American University of Kuwait, Kuwait): C-12
Aleksandrovich, Alice (University of New Haven, CT): F-7
Alford, Jane (University of Montevallo, AL): A-5
Aliengena, Ashley (Roger Williams University, RI): I-7
Ananda, Beckett (Broward Community College, FL): B-9
Andersen-Heroux, Michele (Metropolitan State College of Denver, CO): F-2
Anderson, Jonathan (University of Nebraska, Kearney, NE): K-7
Applegarth, Lindsey (Midwestern State University, TX): H-7
Austin, Shannon (College of Notre Dame of Maryland, MD): H-1
Bailey, Lauren (California State University, Fullerton, CA): F-5
Baker, Matt (Oklahoma Baptist University, OK): E-3
Baratta, Francesca (Ramapo College of New Jersey, NJ): G-12
Barber, Elizabeth (SUNY, College at Geneseo, NY): L-4
Barefield, Jonathan (Central Michigan University, MI): D-7
Barger, Aaron (University of Arkansas, Little Rock, AR): C-6
Barkhuff, Gretchen (SUNY, College at Geneseo, NY): J-6
Barksdale, Nadia (University of Alabama, AL): L-9
Barlow, Allegra (Minnesota State University, Moorhead, MN): K-12
Barrett, Kirk (University of North Carolina, Wilmington, NC): M-7
Barrie, Brittany (Western Illinois University, IL): L-6
Batis, Allyson (Luther College, IA): G-8
Beauduy, Kayla (Western Carolina University, NC): A-5
Begeja, Kathryn (The College of New Jersey, NJ): B-6
Bellocq, Brian (Louisiana Tech University, LA): C-7
Belmore, Rachael (Northern Michigan University, MI): E-1
Bender, Brandon (Southeastern Louisiana University, LA): L-12
Benes, John (Alma College, MI): K-2
Benke, Lauren (Chapman University, CA): N-7
Bennefield, Kristopher (Calhoun Community College, AL): M-10
Bennett, Courtney (University of Montevallo, AL): K-2
Bernstorff, Christopher (Lycoming College, PA): N-10
Biesinger, Bethany (Saint Vincent College, PA): H-11
Biggs, Hannah (Otterbein College, OH): N-4
Biggs, Kathrine (Southwestern Oklahoma State University, OK): B-3
Birkenfeld, Katie (Rockhurst University, MO): K-5
Bittner, Caitlin (University of Wisconsin, Eau Claire, WI): G-11
Bixler, Robert (Alma College, MI): I-11
Blake, Andrew (Auburn University, Montgomery, AL): L-2
Blake, Anna (Washington & Jefferson College, PA): E-11
Blankenship, Courtney (Concord University, WV): E-10
Boersma, Casey (Tulane University, LA): A-7
Bohannon, Alexandra (University of Central Oklahoma, OK): K-4
Bok, Jihan (Cedarville University, OH): D-6
Bolling, Laura (Brenau University, GA): E-13
Boone, Kelsey (Samford University, AL): H-9, J-7
Bouchard, Nicole (Northwest Nazarene University, ID): G-5
Bowles, Kari (Emporia State University, KS): L-4
Boyd, Patrick (Louisiana Tech University, LA): M-8
Bradford, Keegan (Liberty University, VA): L-2, N-11
Bradley, Benjamin (Sacred Heart University, CT): D-5
Branstetter, Melissa (Liberty University, VA): K-6
Brazle, Claudia (Oklahoma Christian University, OK): D-4
Breed, Mary-Catherine (Pace University, New York Campus, NY): K-4
Breerwood, John (New Mexico Highlands University, NM): A-8
Brewer, Zechariah (Southeastern Louisiana University, LA): N-9
Brockenbrough, Chelsey (The College of New Jersey, NJ): C-4
Brown, Anessah (Allen University, SC): A-3, H7
Brown, Jessica (Indiana University of Pennsylvania, PA): K-10
Brown, Samuel (University of Arkansas, Little Rock, AR): B-9
Bruening, Megan (Roanoke College, VA): A-4
Bruffy, Katelyn (The College of New Jersey, NJ): K-10
Brumfield, Stephanie (University of Alabama, AL): B-7
Bryant, Patrick (Winthrop University, SC): L-10
Bryson, Sabrina (Williams Baptist College, AR): G-12
Buchanan, Lance (Lee University, TN): M-1
Buck, Amy (Augusta State University, GA): I-9
Burdett, Hayley (Minnesota State University, Moorhead, MN): B-1
Burge, Ashley (University of Montevallo, AL): B-11
Burke, Daniella (Lipscomb University, TN): E-9
Burney, Brooke (Missouri Southern State University, Joplin, MO): I-3
Bush, Margaret (Liberty University, VA): I-10
Byrd, Antonio (Auburn University, Montgomery, AL): D-3
Cahill, Autumn (Rockhurst University, MO): K-1
Cambra, Zita (Bridgewater State University, MA): G-1
Campbell, Justin (Chapman University, CA): B-9
Cantu, Michelle (St. Edward's University, TX): N-2
Cardwell, Tasha (Park University, MO): I-1
Carlini, Felicia (Sacred Heart University, CT): D-5
Carmody, Rachel (Franklin Pierce University, NH): L-11
Carnegie, Kayla (Freed-Hardeman University, TN): F-6
Carney, Kristin (Park University, MO): D-9
Carpenter, Tiffany (Saint Leo University, FL): J-4
Carver, Crystal (Shawnee State University, OH): J-3
Catalano, Julia (Ithaca College, NY): L-9
Cavarno, Katrina (Chapman University, CA): M-3
Champ, Shaye (University of Nebraska, Kearney, NE): E-10
Champa, Brittany (Assumption College, MA): D-9
Chang, Kristin (University of Wisconsin, Eau Claire, WI): D-4
Charles, Jennifer (University of Pikeville, KY): L-5
Cherney, Wren (California Lutheran University, CA): I-5
Chrisman, Alyssa (Central Michigan University, MI): C-11
Christ, Maggie (Roanoke College, VA): I-7
Ciulla, Nicole (St. Mary's University, Minnesota, MN): J-11
Clawson, Janice (Stephens College, MO): G-3
Cline, Jennifer (Azusa Pacific University, CA): K-6

Index: Presenters and Roundable Participants

- Cole, Emily (Mansfield University, PA): F-8
Collier, Gretchen (Minot State University, ND): K-6
Combs, Holly (Loyola University, New Orleans, LA): M-3
Comfort, Sharika (Johnson C. Smith University, NC): C-2
Conti, Maria (Walsh University, OH): N-8
Cook, Caitlin (Park University, MO): K-5
Cook, Christopher (Southeastern Louisiana University, LA): H-5, L-12, N-12
Cooney, Neil (Lee University, TN): H-6
Copeland, Sarah (Chatham University, PA): F-8
Cordella, Matthew (SUNY, College at Geneseo, NY): N-4
Cornell, Caleigh (University of North Carolina, Wilmington, NC): K-2
Correll, Rachel (Park University, MO): C-9
Correro, Nancy (McNeese State University, LA): E-2
Corsaro, Cara (College of Notre Dame of Maryland, MD): J-11
Cosper, Jesse (University of Montevallo, AL): G-3
Courtney, Amber (University of Alabama, Birmingham, AL): I-6
Craig, Sherri (Southeastern Louisiana University, LA): N-12
Cranford, Christopher (Augusta State University, GA): D-7
Crayton, Tarus (Blue Mountain College, MS): H-11
Creech, Heather (Southern Arkansas University, AR): C-1
Criswell, Amber (University of Houston, Clear Lake, TX): C-3
Croat, Allison Marie (Luther College, IA): K-13
Cross, Randy (Calhoun Community College, AL): F-13
Crump, Flannery (Missouri Valley College, MO): J-8
Cuomo, Alicia (The College of New Jersey, NJ): N-2
Curlin, Jason (Ouachita Baptist University, AR): L-3
Curran, Mariko (The College of New Jersey, NJ): J-4
Dahlkoetter, Danielle (Morningside College, IA): M-7
Daley, Alexander (California Lutheran University, CA): F-3
Dalini, Patricia (Northeastern Illinois University, IL): L-13
Davis, Daniel (University of North Carolina, Pembroke, NC): F-5
Davis, Emily (Ouachita Baptist University, AR): M-5
Davis, Joseph (Minot State University, ND): I-2
Davis, Laura (Stephen F. Austin State University, TX): E-7
Davis, Marci (Portland State University, OR): J-10
Davis, Paige (Tulane University, LA): G-8
Davis, Whitney (Kansas State University, KS): E-10
Davner, Aliza (Lycoming College, PA): D-5
Dawkins, Jenna (Elon University, NC): J-3
Dawson, Rayna (Oklahoma Baptist University, OK): B-12
Dean, Tahirah (University of North Texas, TX): B-7, H-1
Dederer, Danielle (Lee University, TN): H-5
Deibert, Ann (Clarion University, PA): M-12
Delp, Randa (Northwest Missouri State University, MO): D-8
Dennan, Douglas (University of Alabama, AL): F-4
Dessaso, Deborah (University of the District of Columbia, DC): H-8
DeVine, Drew (Samford University, AL): B-10
Dickey, Aaron (University of Nebraska, Kearney, NE): C-7
Dilliplane, Donald (Loyola Marymount University, CA): H-8
Dingler, Kourtnei (Samford University, AL): I-4
Dollar, Kristin (Furman University, SC): J-2
Dominowski, Daniel (Augusta State University, GA): G-7
Doss, Katherine (University of Alabama, Huntsville, AL): I-2
Douglass, Ellie (St. Edward's University, TX): L-10
Dowell, Megan (Olivet Nazarene University, IL): N-8
Drotar, Trina (California State University, Sacramento, CA): E-8
Drouillard, Caitlin (Thomas More College, KY): L-10
DuBois, Jennifer (University of Central Oklahoma, OK): K-10
Dulaney, Lisa (Eastern Illinois University, IL): B-10
Durborow, Robert (Southern Utah University, UT): G-9
Durham, Lindsey (Lipscomb University, TN): J-2
Eagon, Cayla (Winthrop University, SC): J-4
Easterbrook, Tyler (University of Pittsburgh, Johnstown, PA): J-9
Eddinger, Emily (Chatham University, PA): D-8
Edoziem, Ernestina (University of Indianapolis, IN): J-10
Edwards, Meredith (Furman University, SC): F-10
Eskin, Kimberly (Ramapo College of New Jersey, NJ): F-11
Espinosa, Antonia Lliteras (Luther College, IA): K-13
Etelamaki, Heather (Kansas State University, KS): H-12
Eubanks, Ellen (Ouachita Baptist University, AR): C-3
Evans, Sarah (University of Scranton, PA): L-6
Fagan, Keelan (Columbia College, South Carolina, SC): A-6, J-13
Fang, Zheng (University of Indianapolis, IN): L-11
Farhat, Razan (American University of Kuwait, Kuwait): C-12
Farley, Michael (University of Scranton, PA): D-2
Farquharson, Kristin (Louisiana Tech University, LA): I-9
Faulkner, Sarah (Chapman University, CA): E-5, H-12
Felkins, Shawna (Western Kentucky University, KY): H-4
Fennell, Jill (Southern Arkansas University, AR): I-10
Ferguson, Shannon (Franklin Pierce University, NH): C-8
Fick, Emma (University of Alabama, AL): G-2
Finigan, Candye (Williams Baptist College, AR): J-7
Flanagan, Brendan (Ramapo College of New Jersey, NJ): B-4
Flett, Deihlia (Broward Community College, FL): L-10
Forte, Joseph (Santa Clara University, CA): I-6, J-12
Foster, Rodney (Park University, MO): H-9, I-6
Fowler, Eleanor (Brenau University, GA): E-13
Fowler, Lauren (Concord University, WV): I-7
Fox, Shelly (Texas A&M University, Corpus Christi, TX): G-3
Fredericks, Sarah (Auburn University, Montgomery, AL): J-8
Freeman, Lydia (Bluefield College, VA): C-1
Fregeau, Steven (Walsh University, OH): I-4
Frobisher, Kelsey (Oklahoma Christian University, OK): E-4
Furey, Elizabeth (Tulane University, LA): B-9
Gadd, Carson (Southern Utah University, UT): D-7, H-10
Gall, Zach (The College of New Jersey, NJ): L-6
Galo, Sarah (Ramapo College of New Jersey, NJ): C-2
Galovich, Kimberly (Eastern Illinois University, IL): A-1
Gamble, Joseph (University of Alabama, AL): E-2
Garcia, Joshua (Union University, TN): B-1, N-9
Garcia, Kristina (Northeastern Illinois University, IL): L-13
Garcia, Romeo (Texas A&M University, Corpus Christi, TX): A-2

Index: Presenters and Roundtable Participants

- Gardner, Elleigh (Southern Arkansas University, AR): B-12
Garner, Christina (Auburn University, Montgomery, AL): H-7
Garrido, Alejandro (University of North Texas, TX): E-6
Gartner, Angela (Saint Vincent College, PA): H-2
Gates, Madelyn (Western Kentucky University, KY): M-11
Gatten, Alexandra (Sacred Heart University, CT): D-6
Gearhart, Audrey (Western Kentucky University, KY): K-9
Gedda, Kaela (St. Norbert College, WI): J-6
Generazio, Eddie (Virginia Wesleyan College, VA): A-2
Genre, Christopher (Southeastern Louisiana University, LA): L-12
Gerlick, Joseph (Metropolitan State College of Denver, CO): B-2, I-12
Gerrish, Heather (Eastern Illinois University, IL): J-11
Gershon, Elizabeth (McKendree University, IL): M-8
Gibson, Shasta (Fairmont State University, WV): M-4
Gift, Rachel (Walsh University, OH): K-8
Giguere, Stephanie (Assumption College, MA): E-4
Gilbert, Jordan (Oklahoma Baptist University, OK): C-7
Gilles, Tessa (Clarion University, PA): M-12
Gilliard, Lauren (Northwest Missouri State University, MO): B-8
Gilman, Byron (Rockhurst University, MO): E-3, B-12
Girdler, Brennan (University Of Evansville, IN): F-2
Givhan, Vivian (University of Alabama, AL): M-6
Glasmyre, Carly (Alvernia University, PA): I-13
Glenn, Lauren (Freed-Hardeman University, TN): N-8
Godfrey, Jordan (Oklahoma Baptist University, OK): N-10
Goldberg, Jesse (SUNY, College at Geneseo, NY): A-8
Gonsalves, Shayna (Pace University, New York Campus, NY): A-2
Gonzalez Duran, Nancy Lilia (St. Edward's University, TX): B-2
Gorgans, Matthew (Mercer University, GA): I-5
Gosset, Gabrielle (SUNY, College at Geneseo, NY): B-2
Gostlin, Desirae (Columbia College, South Carolina, SC): J-13
Grancea, Gloria (University of Pittsburgh, Greensburg, PA): D-12, M-12
Granger, Genean (Northern Michigan University, MI): J-10
Grappe, Lillian (Louisiana Tech University, LA): M-4
Gratton-Fisher, Emma (Chatham University, PA): M-8
Graves, Amber (St. Martin's University, WA): L-1
Gray, Tonya (Blue Mountain College, MS): C-10
Graziano, Lauren (Clarion University, PA): L-1
Greene, Cody (Elon University, NC): M-2
Greer, Justin (Southeastern Louisiana University, LA): N-12
Grooms, Kelly (Shawnee State University, OH): A-1
Guindon, Jessica (University of Montevallo, AL): B-11
Haber, Trisha (Dixie State College of Utah, UT): E-7
Hall, Lauren (Marist College, NY): B-2
Hamil, Allison (University of Alabama, AL): B-3
Hamilton, Corey (University of Central Oklahoma, OK): A-6
Hanson, Stephen (Duquesne University, PA): F-7
Hapka, Agnes (University of Rio Grande, OH): E-2
Harbin, Caroline (Samford University, AL): G-12
Hardeman, Heather (University of Montevallo, AL): B-11
Harrell, Chelsea (Blue Mountain College, MS): H-6
Harrelson, Stephanie (Coker College, SC): N-6
Harrer, Kim (Metropolitan State College of Denver, CO): F-4
Harrison, Jeff (The College of New Jersey, NJ): E-8
Hart, Christopher (Western Michigan University, MI): A-4
Hartman, Kaitlin (Northwest Missouri State University, MO): H-1
Hartman, Alvernia (Alvernia University, PA): C-13
Hartt, Brian (The College of New Jersey, NJ): A-7
Hawk, Morgan (Maryville College, TN): J-5
Healy, Stephanie (Park University, MO): J-8
Hedge, Kara (Springfield College, MA): C-8
Heideman, Kari Elizabeth (Tulane University, LA): G-8
Heine, Zachary (St. Edward's University, TX): N-10
Heller, Jessica (Alvernia University, PA): C-13
Hendricks, Rebecca (Washington & Jefferson College, PA): K-11
Henrich, Marie (Slippery Rock University, PA): M-9
Hernandez, Laura (Oklahoma Christian University, OK): G-10
Herrick, Kelly (Elon University, NC): E-5
Hicks, Jolie (Southwestern Oklahoma State University, OK): A-1
Higginbotham, Jessica (Northern Michigan University, MI): G-4
Hill, Jonyetta (Augusta State University, GA): K-6
Hines, Katherine (Tulane University, LA): M-2
Hixson-Bowles, Kelsey (Kansas State University, KS): H-12
Hollenbaugh, Ian (Western Michigan University, MI): I-4
Holmes, Breanna (Montana State University, Bozeman, MT): H-10
Horn, Jessica (Blue Mountain College, MS): D-3
Horning, Erin (Penn State Altoona, PA): L-9
Houghtalen, Andrew (Sacred Heart University, CT): C-6
Howard, Lisa (College of Notre Dame of Maryland, MD): F-1, K-12
Howell, Brittani (Mercer University, GA): K-7
Hughes, Megan Abigail (University of Pittsburg at Greensburg, PA): F-12
Hulett, Katie (Dixie State College of Utah, UT): A-9
Hunt, Sara (Chapman University, CA): L-7, N-3
Hunt, Shelby (Chapman University, CA): H-4
Hurler, Jennifer (The College of New Jersey, NJ): K-9
Huston, Matt (The College of New Jersey, NJ): B-8
Iberg, Michelle (Barry University, FL): E-1
Inman, Kristen (Northwest Missouri State University, MO): D-8, M-3
Izor, Christopher (University of Alabama, AL): G-7
Jackson, Bethany (Oklahoma Baptist University, OK): K-7
Jackson-Flowers, Morgan (University of Alabama, AL): J-5
Jameson, Skylar (SUNY, College at Geneseo, NY): I-8
Janes, Kacey (Brenau University, GA): E-13
Jensen, Sarah (Olivet Nazarene University, IL): A-5
Johnson, Alexa (Elon University, NC): N-9
Johnson, Chelsea (Azusa Pacific University, CA): C-10
Johnson, Deannah (University of Arkansas, Little Rock, AR): H-11
Johnson, Heather (Augusta State University, GA): I-6
Johnson, Sasha (University of North Carolina, Wilmington, NC): D-12
Jones, Arkeeda (Bennett College for Women, NC): M-9
Jones, Christina (Shawnee State University, OH): D-10
Jones, Jason (Dixie State College of Utah, UT): A-9

Index: Presenters and Roundtable Participants

- Jones, Rachel (College of Notre Dame of Maryland, MD): I-11
Jordan, Ariana (Central Michigan University, MI): C-11
Kanagaki, Emma (California Lutheran University, CA): G-5
Kasper, Daniel (Southern Arkansas University, AR): H-9, M-8
Kemp, Matthew (Auburn University, Montgomery, AL): E-4
Kendrick, Samantha (William Jewell College, MO): F-9
Kennedy, Casey (Westminster College (PA), PA): J-3
Killmeyer, Samantha (Westminster College (PA), PA): E-8
King, Brooke (Saint Leo University, FL): D-2
King, Jamie (University of Montevallo, AL): B-11, I-9
Kinley, Kylie (Kansas State University, KS): E-11
Kirley, Jacqueline (Thomas More College, KY): L-3
Kissell, Sara (Washington & Jefferson College, PA): G-6, K-11
Kittleson, Allison (Minot State University, ND): F-6
Kizima, Hailee (Minot State University, ND): N-6
Kizior, Laura (North Central College, IL): N-5
Kizior, Mary (North Central College, IL): N-5
Klander, Bess (Concord University, WV): I-7
Klopach, Eric (University of Alabama, AL): D-12
Knappenberger, Crystal (Winthrop University, SC): D-6
Knickerbocker, Kara (Westminster College (PA), PA): G-2
Knight, Ethan (Western Illinois University, IL): M-6
Koch, Danielle (Luther College, IA): A-3, K-13
Kohl, Bethany (Ouachita Baptist University, AR): F-3
Kravig, Kendra (La Sierra University, CA): G-11
Krengel, Kaitlin (Northern Michigan University, MI): J-3
Krueger, Shannon (Minot State University, ND): F-7
Kulikowski, Leah (Northern Michigan University, MI): J-1
Laird, Lauren (Slippery Rock University, PA): M-9
Lam, Dorcas (Liberty University, VA): F-11
Landers, Rachel (University of Montevallo, AL): K-4
Lane, Cheryl (Harris-Stowe State University, MO): N-1
Lanzaro, Jenna (The College of New Jersey, NJ): K-8
Lanzaro, Jenna (The College of New Jersey, NJ): A-2
Larracey, Caitlin (Bridgewater State University, MA): I-4
Larsen, Erika (Dixie State College of Utah, UT): H-4
Larson, Jamee (Minnesota State University, Moorhead, MN): E-1, K-12
Lasley, Michael (Santa Clara University, CA): J-12
Lau, Travis (University of California, Los Angeles, CA): C-7
Lawrence, Kasey (University of Central Oklahoma, OK): C-2
Layne, Mary Kristen (Furman University, SC): F-1
Le, Van (Collin County Community College, TX): B-10
Leddy, Brittany (Metropolitan State College of Denver, CO): K-8, I-12
Lehman, Stephanie (Westminster College (PA), PA): M-1
Leiva, Aaron (Northeastern Illinois University, IL): L-13
LeJuine, Joseph (McNeese State University, LA): B-4
Lempke, Celeste (University of Nebraska, Kearney, NE): D-8, I-12
Leskinen, Katie (Cardinal Stritch University, WI): E-9
Lewis, Marquis (Clarion University, PA): M-12
Light, Brooke (Liberty University, VA): F-8
Lindley, Evanne (Pepperdine University, CA): B-5
Littlejohn, Jessica (University of Montevallo, AL): B-11
Locicero, Maria (Alvernia University, PA): I-13
London, Blake (Southern Utah University, UT): M-5
Long, Patricia (Bowie State University, MD): I-5
Long, Stacy (Blue Mountain College, MS): E-5
Lowery, Tabitha (Southern Arkansas University, AR): G-8
Luizzi, Elizabeth (California Lutheran University, CA): I-5
Luna, Montserrat (Pepperdine University, CA): N-7
Lund, Hannah (Luther College, IA): K-13, L-2
Lundgren, Erika (Westfield State College, MA): G-2
MacDonald, Bridie (Central Michigan University, MI): E-12, N-11
MacKay, Kirsten (University of Alabama, AL): B-8
Maher, Caitlin (SUNY, College at Geneseo, NY): G-7
Makaryan, Lilit (Columbia College, South Carolina, SC): J-13, L-8
Makley, Grace (Northern Michigan University, MI): J-3
Mantz, Courtney (Minot State University, ND): M-5
Maria, Oscar (Azusa Pacific University, CA): D-11
Marko, Britney (Olivet Nazarene University, IL): I-3
Marks, Jennifer (Florida Gulf Coast University, FL): E-12
Marsh, Rebecca (St. Martin's University, WA): G-4
Martin, Allie (Freed-Hardeman University, TN): I-8
Martin, Sarah (Columbia College, South Carolina, SC): D-13, J-13
Martinez, Roberto (Metropolitan State College of Denver, CO): C-2, I-12
Maryam, Al-Akili (American University of Kuwait, Kuwait): D-3
May, Rachel (Augusta State University, GA): C-4
McCormack, John (The College of New Jersey, NJ): I-8
McCourt, Kaci (University of Louisiana, Monroe, LA): E-4
McCue, Megan (Alvernia University, PA): C-13, I-13
McCurdy, Jennifer (Mercyhurst College, PA): H-2
McDonald, Sarah (Penn State Altoona, PA): D-10
McEllhenney, Sarah (Cedarville University, OH): G-9
McGee, Daniel (Alma College, MI): F-6
McGill, John (University of Scranton, PA): F-10
McLean, Shannon (Southern Utah University, UT): F-2
McNulty, Brandon (King's College, PA): I-8
McNulty, Rebecca (The College of New Jersey, NJ): B-10
Melf, Anthony (King's College, PA): G-9
Merry, Andrea D. (University of Rio Grande, OH): M-2
Meyer, Elvina (St. Edward's University, TX): C-9
Michaelson, Catherine (The College of New Jersey, NJ): E-5
Miesko, Kelly (Slippery Rock University, PA): F-1
Milam, Caroline (Samford University, AL): B-7
Milanak, Laura (Westminster College (PA), PA): L-7
Miles, Eli (Shorter University, GA): H-3
Miles, Majesta (Southern Arkansas University, AR): N-1
Miller, Ashley (University of Central Oklahoma, OK): N-4
Miller, Christopher (Western Michigan University, MI): I-11
Miller, David (LaGrange College, GA): F-8
Miller, Melissa (University of Wisconsin, Eau Claire, WI): B-12, N-8
Miller, Robin (California State University, Fullerton, CA): L-6
Molnar, Mariah (University of Wisconsin, Eau Claire, WI): K-1

Index: Presenters and Roundtable Participants

- Molnar, Meredith (University of Wisconsin, Eau Claire, WI): D-9
Monahan, Brenna (Northwest Nazarene University, ID): H-2
Monteiro, Stasia (SUNY, College at Geneseo, NY): A-8
Montenegro, Adriana (St. Edward's University, TX): L-1
Moore, Margo (Oklahoma Christian University, OK): I-9
Moran, Benjamin (Western Michigan University, MI): D-12
Morgan, Brittany (Franklin Pierce University, NH): M-7
Morgan, Natasha (Western Illinois University, IL): L-1
Moser, Andrew (Metropolitan State College of Denver, CO): G-11
Moskofian Barry, Summer (Dixie State College of Utah, UT): B-1
Mt. Pleasant, Rachael (SUNY, College at Geneseo, NY): D-1
Mulcahy, Sara (Bridgewater State University, MA): H-8
Murphy, Jennifer (Chatham University, PA): N-3
Murry, Rebecca (Southeastern Louisiana University, LA): L-12
Myers, Danielle (University of Southern Mississippi Gulf Coast, MS): G-7
Nasser, Samiyeh (Broward Community College, FL): C-3
Nelson, Stephanie (Pepperdine University, CA): G-10
Neshek, Shauna (Northern Michigan University, MI): J-1
Newsom, Kimberly (Chapman University, CA): G-4
Nichter, Klara (University Of Evansville, IN): H-5
Nielsen, Lauren (Luther College, IA): F-3
Nixon, Justine (Sam Houston State University, TX): L-8
Noble, Joseph (Saint Vincent College, PA): M-10
Norman, Brittany (Midwestern State University, TX): H-6
Norris, Kaley (Southern Illinois University, IL): N-4
O'Brien, Kathryn (Western Michigan University, MI): K-9
O'Malley, Michael (Union University, TN): D-11
O'Neil, Meggan (Pepperdine University, CA): I-3
O'Neil, Sarah (University of Pittsburg at Greensburg, PA): M-12
Oberndorfer, Mackenzie (Lee University, TN): G-5
Oliverio, Theresa (Walsh University, OH): D-1
Olmstead, Emily (SUNY, College at Geneseo, NY): B-6
Ottmers, Gretchen (St. Edward's University, TX): E-3
Owens, Blakely (University of Southern Mississippi, Hattiesburg, MS): E-6
Paasen, Jens (St. Norbert College, WI): F-9
Pagano, Katie (University of Pittsburgh, Greensburg, PA): K-11, L-10
Pai, Megha (University of Pittsburgh, Greensburg, PA): F-12
Pannell, Robert (Missouri Valley College, MO): M-6
Panzer, Gretchen (St. Norbert College, WI): M-10
Paslov, Lena (Sacred Heart University, CT): G-6
Patterson, Erika (Winthrop University, SC): J-7
Patterson-Hulett, Katie (Dixie State College of Utah, UT): I-1
Pawlikowski, Melanie (Fort Lewis College, CO): M-1
Payne, Austin (Southeastern Louisiana University, LA): D-10, F-12
Persson, Joanna (Ouachita Baptist University, AR): J-1
Peryea, Richelle (Lincoln Memorial University, TN): M-4
Peterson, Dana (Olivet Nazarene University, IL): B-4
Phillips, Bradley (Walsh University, OH): E-8
Phillips, Caitlin (Penn State Abington, PA): C-8
Phillips, Dylan (Winthrop University, SC): L-2
Pickering, Rob (Missouri State University, MO): M-11
Pickering, Tracy (Northern Michigan University, MI): N-1
Pine, Chelsea (Central Michigan University, MI): G-3
Porter, William (SUNY, College at Geneseo, NY): E-7
Power, Megan (Westminster College (PA), PA): K-10
Prestin, Joshua (Northwest Nazarene University, ID): N-10
Primeau, Jamie (The College of New Jersey, NJ): L-5
Prince, Michael (Metropolitan State College of Denver, CO): N-3
Puhak, Shelly (College of Notre Dame of Maryland, MD): K-12
Pullin, Laura (Lee University, TN): D-7
Purcar, Eugenia (Pepperdine University, CA): A-2, J-5
Pursell, Paul (Park University, MO): E-11
Ranck, Ashley (Slippery Rock University, PA): L-2
Rarick, Ryan (Dixie State College of Utah, UT): A-9, B-1
Rayburn, Sean (Mercer University, GA): E-2
Reagan, Mark (Metropolitan State College of Denver, CO): H-3
Reed, Mandi (Missouri State University, MO): B-5
Reed, Whitney (Otterbein College, OH): C-9
Reyes, Jessica (Kansas State University, KS): H-12
Rhodes, Chelsea (Columbia College, South Carolina, SC): D-13, J-13
Rich, DeAnna (Columbia College, South Carolina, SC): D-13
Rich, Natalie (Southeastern Louisiana University, LA): F-12
Richardson, Angela (Northwest Missouri State University, MO): I-3
Richardson, Kirk (Walsh University, OH): N-1
Rivard, Ryan (Marist College, NY): L-7
Roberts, Lauren (Rockhurst University, MO): E-9
Robins, Rachel (Dixie State College of Utah, UT): A-1, G-5
Romero, Natalie (La Sierra University, CA): B-3
Rooney, Courtney (Tulane University, LA): A-4
Rose, Olivia (Columbia College, South Carolina, SC): D-13
Rosen, Justine (SUNY, College at Geneseo, NY): B-5
Roth, Parker (Baker University, KS): H-9
Rouchon, Mechelle (Southeastern Louisiana University, LA): I-2
Rourks, Leigh (Southeastern Louisiana University, LA): N-12
Rowe, Derek (Alvernia University, PA): C-13
Russell, Anna (Blue Mountain College, MS): E-11
Russell, Margaret (Marian University, WI): C-1
Ryals, Megan (Southeastern Louisiana University, LA): D-2
Ryan, Hannah (University of Southern Mississippi, Hattiesburg, MS): A-4
Saccamago, Joseph (University of Pittsburgh, Greensburg, PA): B-6
Sadler, Jon (Missouri Southern State University, Joplin, MO): H-3
Sager, Tamara (King's College, PA): G-1
Salassi, Justina (University of Louisiana, Monroe, LA): A-6
Salyga, Michelle (University of North Carolina, Wilmington, NC): C-10
Salzman, Blaine (University of South Florida, Sarasota-Manatee, FL): F-4
Sam, Sam (University of Dubuque, IA): I-3
Sammet, Renee (Ohio Northern University, OH): J-1
Sandman, Jacob (University of Nebraska, Kearney, NE): F-10
Santaniello, Lauren (Ramapo College of New Jersey, NJ): M-3
Sargent, Marguerite (Chatham University, PA): I-10
Sartor, Katie (Lee University, TN): F-3
Sasse, Taylor (Rockhurst University, MO): C-4

Index: Presenters and Roundtable Participants

- Sauer, Kristin (Thomas More College, KY): H-2
Saunders, Miah (High Point University, NC): L-3
Savage, Jon (University of North Texas, TX): D-7
Scanlon, Caitlin (University of Pittsburgh, Johnstown, PA): J-1
Schermerhorn, Chelsea (Mercyhurst College, PA): G-4
Schlag, James (Southern Arkansas University, AR): E-6
Schmidt, Tanya (Santa Clara University, CA): A-5, J-12
Schmitt, Hannah (St. Norbert College, WI): N-6
Schmottlach, Heather (University of Southern Mississippi Gulf Coast, MS): B-6
Schneider, Caitlin (Assumption College, MA): H-4
Schrock, Krista (University of South Florida, Sarasota-Manatee, FL): C-4
Schrupp, Sarah (University of Wisconsin, Eau Claire, WI): I-12
Schultz, Greta (University of Wisconsin, Eau Claire, WI): B-8
Schwager, Matthew (Montana State University, Bozeman, MT): K-3
Scott, Emily (Western Michigan University, MI): G-2
Selby, Rose (Westminster College (PA), PA): C-8
Sellgren, JD (Alumni Epsilon, Alvernia University (PA)): I-13
Senecal, Olivia (Chapman University, CA): E-7
Seymour, Jared (Central Michigan University, MI): J-9
Shapy, Leslie (St. Norbert College, WI): G-1
Sharp, Cassie (Oklahoma Baptist University, OK): B-12
Sherman-Jones, Teresa (Northern Michigan University, MI): D-3, M-10
Shishido, Erin (Azusa Pacific University, CA): B-3
Shockey, Rachael (Marist College, NY): M-1
Shook, Kyle (Mercer University, GA): F-6
Short, Dielle (Ouachita Baptist University, AR): K-7
Shorter, Shauntazia (Tennessee State University, TN): F-11
Silva, Isabel (King's College, PA): L-9
Silvers, Amber (Southeastern Louisiana University, LA): C-2
Simmons, Shea (Mercer University, GA): F-5
Simon, Shelby (Tulane University, LA): C-10
Sines, Brittany (Lee University, TN): L-4
Smith, Angelina (Mercyhurst College, PA): K-8
Smith, August (Western Michigan University, MI): J-9
Smith, Callie (Lee University, TN): K-9
Smith, Derek (Alvernia University, PA): C-13
Smith, Gary Thomas (University of Pikeville, KY): D-11
Smith, Katie (Liberty University, VA): A-7, N-11
Smith, Kimberly (University of West Georgia, GA): M-6
Smith, Rebecca (Stephen F. Austin State University, TX): A-3
Smith, Stephanie (Samford University, AL): J-2
Snavlin, Jessica (Portland State University, OR): I-12
Snyder, Natasha (East Tennessee State University, TN): J-7
Sonzogni, Christopher (Elon University, NC): I-10
Souza, Selina (University of Louisiana, Monroe, LA): E-11
Spanjers, Emily (University of Wisconsin, Eau Claire, WI): L-5
Spence, Luanne (St. Norbert College, WI): N-5
Spruill, Katherine (Elon University, NC): E-10
Sray, Cammy (Cedarville University, OH): H-7
Stewart, Justin (Ohio Northern University, OH): D-2
Stinson, Miranda (University Of Evansville, IN): J-2
Stivers, Kimberly (The College of New Jersey, NJ): F-5
Stokes, Samantha (Sacred Heart University, CT): J-11
Stone, Sara (The Ohio State University, OH): D-11
Stopka-Rinnert, Christina (Mansfield University, PA): D-10, I-5
Stradt, Kristen (Western Illinois University, IL): C-6
Strain, Sally (University of Pittsburgh at Greensburg, PA): F-12
Stromer, Sarah (Saint Leo University, FL): G-1
Struthers, Haley (Barry University, FL): C-3
Sullivan, Alexis (University of Scranton, PA): F-10
Sullivan, Erin (Assumption College, MA): I-1
Sullivan, Lauren (Stephen F. Austin State University, TX): N-2
Summers, Cameron (Rockhurst University, MO): N-9
Surbeck, Elizabeth (Eastern Illinois University, IL): E-12
Swanson, Jacob (Western Michigan University, MI): L-5
Swords, Rachel (Southeastern Louisiana University, LA): G-9
Szeman, Edward (Winthrop University, SC): F-11, I-2
Szyplowski, Jenna (University of Pittsburgh, Greensburg, PA): D-2
Talbert, Brian (Rockhurst University, MO): A-3
Tan, Hui Sian (John Carroll University, OH): H-10
Taylor, Brandon (Auburn University, Montgomery, AL): G-2, N-9
Teel, Richard (Santa Clara University, CA): H-3, J-12
Temple, Gayle (University of Pittsburgh, Greensburg, PA): K-5, M-12
Tenison, Serena (University of Louisiana, Monroe, LA): N-7
Teut, Kelci (Morningside College, IA): F-2
Thacker, Laura (Kansas State University, KS): H-11
Thelen, Jessica (Westfield State College, MA): M-2
Thies, Mike (University of Wisconsin, Eau Claire, WI): M-11
Thomas, Julia (Washington & Jefferson College, PA): K-11
Thomas, Steven (Samford University, AL): N-3
Thompson, Christina (Louisiana Tech University, LA): J-9
Thompson, Lacie (Southwestern Oklahoma State University, OK): F-1
Thornberry, Marissa (Ouachita Baptist University, AR): E-2
Tienter, Tonya (Luther College, IA): J-6, K-13
Tierney, William (Mount Olive College, NC): K-2
Titus, Sarah (St. Norbert College, WI): C-1
Todd, Andrew (John Carroll University, OH): D-6
Tonge, Trisha (Central Michigan University, MI): C-11
Trepagnier, Carly (Southeastern Louisiana University, LA): J-10
Trotter, Casie (Oklahoma Baptist University, OK): I-1
Turcotte, Tawni (Franklin Pierce University, NH): L-7
Turnbull, Amanda (Clarion University, PA): M-7
Urdike, Natalie (University Of Evansville, IN): J-5
Uthe, Mollie (Thomas More College, KY): H-1
Valentine, Darnell (Allen University, SC): K-1
VanderLind, Lauren (Northern Michigan University, MI): L-8
Varner, Mariah (Lee University, TN): L-4
Vought, Jessie (Central Michigan University, MI): C-11
Wagner, Michael (Alvernia University, PA): E-9, I-13
Wagner, Sydnee (University of North Texas, TX): K-4
Wahlenmaier, Mandi (Northwest Missouri State University, MO): H-10
Walker, Rachel (University of Rio Grande, OH): J-2

Index: Presenters and Roundtable Participants

Wallace, Missy (Louisiana Tech University, LA): L-11
Wanzer, Catherine (University of Wisconsin, Eau Claire, WI): D-9
Warkentien, Scott (Park University, MO): L-2
Watkins, John (Lee University, TN): G-10
Watson, Kiah (Northern Michigan University, MI): G-11
Weaver, Amy (Lycoming College, PA): M-4
Webb, Emily (SUNY, College at Geneseo, NY): N-10
Webb, Michelle (Fort Hays State University, KS): G-6
Weeks, Maria (Marian University, WI): G-10
Weiss, Jillian (Elon University, NC): D-9
Wermager, Seth (Liberty University, VA): A-6
Whalen, Jennifer (Northern Kentucky University, KY): F-2
White, Devin (Lee University, TN): N-7
White, Kaley (Oklahoma Christian University, OK): D-4
White, Sonya (Park University, MO): D-1
Whitworth, Colin (University of Alabama, AL): N-2
Whyms, Emily (Marian University, WI): E-3
Wierbowski, Bradley (University of Scranton, PA): E-12
Wiest, Matthew (Baker University, KS): G-12
Williams, Ashley (Southeastern Louisiana University, LA): F-9
Williams, Joshua (American University of Kuwait, Kuwait): C-12, K-3
Williams, Katherine (Arkansas Tech University, AR): M-5
Williams, Whitney (Union University, TN): H-5
Wilson, Christina (Southern Arkansas University, AR): D-1
Wilson, Jessica (University of North Carolina, Wilmington, NC): J-8
Wilson, Lucas (Liberty University, VA): B-7, N-11
Wilson, Shalicia (Williams Baptist College, AR): E-6
Wilson-Sharp, Elaine (Dixie State College of Utah, UT): C-9
Wimby, Monique (Brenau University, GA): E-13
Winston, Michael (University of North Texas, TX): K-2
Wojciechowski, Max (Northern Michigan University, MI): L-3
Wolf, Ian (Central Michigan University, MI): D-5, N-11
Wong, Rose Marie (University of Scranton, PA): J-6
Wood, Bethany (Lee University, TN): K-3
Wood, Lauren (Minot State University, ND): H-6
Woodcock, Dana (University of Southern Mississippi, Hattiesburg, MS): C-6
Woodruff, Becky (Otterbein College, OH): L-8
Woody, Amy (Westfield State College, MA): N-5
Wooten, Valerie (Augusta State University, GA): K-1
York, Patrick (La Sierra University, CA): I-10
Young, Andrew (Samford University, AL): F-7
Young, Lacey (Auburn University, Montgomery, AL): G-6
Young, Lindsay (St. Edward's University, TX): B-2
Yucuis, Noel (Augusta State University, GA): J-4
Zambrano, Jacinto (St. Edward's University, TX): K-3
Zenz, Alex (Northwest Missouri State University, MO): K-5
Zimble, Samantha (The College of New Jersey, NJ): L-11
Zyla, Justin (University of Nebraska, Kearney, NE): I-11

Index: Session Moderators

- Aaij, Michel (Auburn University Montgomery, AL): H-7, J-8
Armstrong, Rhonda (Augusta State University, GA): G-7, K-6
Aspinall, Dana (Alma College, MI): F-6, K-2
Bartlett, Lexey (Fort Hays State, University, KS): G-6
Battles, Kelly (Maryville College, TN): J-5
Belcher-Rankin, Rebecca (Olivet Nazarene University, IL): A-5, I-3
Bennett, Courtney (University of Montevallo, AL): G-3, K-4
Beshero-Bondar, Elisa (University of Pittsburgh Greensburg, PA): B-6, M-12
Billings, Simone (Santa Clara University, CA): I-6, J-12
Bissette Sumerel, Ashley (University of North Carolina Wilmington, NC): D-12
Brewster, Glen (Westfield State College, MA): G-2, N-5
Brown, Christina (Mercyhurst College, PA): G-4
Brown, Kevin (Lee University, TN): D-7, K-9, L-4
Buck, Pamela (Sacred Heart University, CT): D-5
Caldwell, Melissa (Eastern Illinois University, IL): A-1, B-10, F-10
Camacho Rourks, Leigh (Southeastern Louisiana, University, LA): F-12
Cirino, Mark (University of Evansville, IN): H-5, J-2
Clark, Judith (Stephens College, MO): E-7, F-5
Cleveland, Vicki (Allen University, SC): K-1
Comeford, AmiJo (Dixie State College of Utah, UT): A-9, B-4, C-9
Crafton, Robert (Slippery Rock University, PA): F-1, L-2, M-9
Craig, Sherri (Southeastern Louisiana State University, LA): L-12
Crowley, Karlyn (St. Norbert College, WI): G-1, H-2
Cullen, Sean (Alvernia University, PA): C-13
Dangelantonio, Sarah (Franklin Pierce University, NH): L-7
Davis, Bill (Notre Dame Maryland University, MD): K-12
Davis, Marybeth (Liberty University, VA): F-11, N-11
Day, Sara (Southern Arkansas University, AR): B-12, C-1, E-10
DeMeo, Beth (Alvernia University, PA): C-8, E-9
Dennis, Larry (Clarion University, PA): M-7
Dessaso, Deborah (University of the District of Columbia, Wash. DC): I-14
DiFilippo, Marie (Rockhurst University, MO): C-4, N-9
Dimuro, Joseph (University of California Los Angeles, CA): C-7
Dorrill, George (Southeastern Louisiana University, LA): G-9, N-12
Dynes, William (University of Indianapolis, IN): L-11
Elliott, Winter (Brenau University, GA): E-13
Fitzpatrick, Carrie (Alvernia University, PA): D-6, E-8, I-13
Franke, Damon (University of Southern, Mississippi Gulf Coast, MS): H-1
Freeman, Hannah (University of Pikeville, KY): L-5
Gaydosik, Victoria (Southwestern Oklahoma University, OK): N-4
Genre, Christopher (Southeastern Louisiana University, LA): I-2, J-10
Gratton-Fisher, Emma (Chatham University, PA): F-8, N-3
Hait, Christine (Columbia College South Carolina, SC): A-6
Harkins-Pierre, Patricia (University of the Virgin Islands, VI): A-7
Hawkins, Ty (Walsh University, OH): D-1, I-4
Helwig, Timothy (Western Illinois University, IL): L-6, M-6
Hess, Arlan (Washington & Jefferson College, PA): K-11
Hess, Rebecca (La Sierra University, CA): I-10
Hicks, Micah Dean (Florida State University, FL): K-10
Hoagland, Ericka (Stephen F. Austin State University, TX): I-1, N-2
Hochstein, Gloria (University of Wisconsin Eau Claire, WI): D-9, G-11
Holt, Megan (Tulane University, LA): B-9, C-10, M-2
Iglesias, Luis (University of Southern Mississippi Hattiesburg, MS): E-6
Ivanov-Craig, Andrea (Azusa Pacific University, CA): B-3
John, Judith (Missouri State University, MO): B-5, M-11
Johnson, William C. (Sigma Tau, Delta Executive Director): F-4
Kerrigan, John (Rockhurst University, MO): K-5
Land, Mike (Assumption College, MA): E-4
Miller, Lee B. (Chadron State College, NE): D-4
Lowery, Tabitha (Southern Arkansas University, AR): H-9, M-8
MacDiarmid, Laurie (St. Norbert College, WI): M-10, N-6
Madaffari, Taylor (Elon University, IL): E-5
Mahaffey, Paul (University of Montevallo, AL): B-11
Matthews, James (Fairmont State University, WV): M-4
Mayfield, Sandra (University of Central Oklahoma, OK): H-12
McGraw, Ken (Roanoke College, VA): A-4, I-7
Midkiff, Sheri (Williams Baptist College, AR): G-12, J-7
Miller, Carl (University of Alabama, AL): B-7
Moore, Joy (Union University, TN): B-1
Moser, Andrew (Metropolitan State College of Denver, CO): C-2, H-3, I-12
Murillo, Cynthia (Tennessee State University, TN): L-8
Murry, Rebecca (Southeastern Louisiana University, LA): F-9
Nixon, Kathy (American University of Kuwait, KU): C-12, D-3, E-12, K-3
Paku, Gillian (SUNY College at Geneseo, NY): B-2, A-8
Pennington, John (St. Norbert College, WI): N-10
Peterson, Jen (Morningside College, IA): F-2
Petrulionis, Sandra (Penn State Altoona, PA): D-10, L-9
Puhak, Shelley (College of Notre Dame of Maryland, MD): J-11
Robbins, Dorothy (Louisiana Tech University, LA): I-9, J-9
Russo, Diane (University of New, Haven, CT): F-7
Rutledge, Walker (Western Kentucky University, KY): H-4
Ryan, Brenda (Northwest Missouri State University, MO): D-8, H-10
Schanfield, Lillian (Barry University, FL): C-3, E-1
Scholl, Diane (Luther College, IA): J-6
Scholl, Peter (Luther College, IA): F-3, G-8, K-13
Schrock, Chad (Lee University, TN): H-6, M-1
Schroeder, Shannin (Southern Arkansas University, AR): N-1
Scott, Robert (Ohio Northern University, OH): D-2, J-1
Settlemyres, Sherrell (Blue Mountain College, MS): E-11, H-11
Smith, Julianne (Pepperdine University, CA): G-10, N-7
Snavlin, Jessica (Metropolitan State College of Denver Alumna): M-3
Sonheim, Amy (Ouachita Baptist University, AR): E-2
Sonheim, Doug (Ouachita Baptist University, AR): M-5
Stanley, Roger (Union University, TN): D-11
Steele, Felicia (The College of New Jersey, NJ): I-8
Steinberg, Diane (The College of New Jersey, NJ): A-2, K-8
Steinberg, Glenn (The College of New Jersey, NJ): B-8, J-4
Stemmler, Kevin (Clarion University, PA): L-1, M-12
Stevenson, Bruce (California Lutheran University, CA): G-5, I-5
Stover, Mary (Allen University, SC): A-3
Thomas-Card, Traci (University of Wisconsin Eau Claire, WI): C-5, I-11, N-8
Tucker, Linda (Southern Arkansas University, AR): C-6, M-8

Index: Session Moderators

Tuten, Nancy (Columbia College South Carolina, SC): D-13
Ventre, Raymond (Northern Michigan University, MI): J-3, L-3
Vogt, Sarah (Thomas More College, KY): L-10
Wagner, Jodi (Marian University, WI): E-3
Watson, Sidney (Oklahoma Baptist University, OK): K-7, L-13
Wendelin, Dave (NEHS Director): C-11, H-8
Willingham, Elizabeth (Calhoun Community College, AL): F-13
Zubizarreta, John (Columbia College South Carolina, SC): J-13

Can books teach the world to read?

Room to Read

WORLD FUND
www.worldfund.org

Invisible Children.com

National Center for Family Literacy

BOOKS FOR AFRICA

We are working on it.

 **BetterWorldBooks®**
WWW.BETTERWORLDBOOKS.COM

Chapter Sponsor Workshop and Luncheon

Chapter Sponsor Workshop

Thursday, March 1, 11:00 - 12:15 p.m. (Balcony K, 4th floor)

Sponsors are invited to attend the 2012 Chapter Sponsor Workshop, "Reawakening Our Roles as Chapter Sponsors!" This year's workshop provides sponsors with the opportunity to obtain important chapter resources and to ask questions specific to their chapter's needs, and features a roundtable session to contribute ideas for the chapter sponsor's handbook and to plan cross-chapter events.

Regents and Sponsors Luncheon

Friday, March 2, 12:30 - 1:15 p.m. (La Galerie 3rd floor)

Sponsors attending the convention are invited to attend the Regents and Sponsors Luncheon, hosted by the Regents of Sigma Tau Delta. This is an opportunity to meet the Regents, meet other Sponsors, share ideas, and learn about opportunities offered to Sponsors and students. In addition, this year's luncheon will feature special guest speaker, Emily Toth, author of the Ms. Mentor column in *The Chronicle of Higher Education*.

Luncheon Guest Speaker: Emily Toth

A Professor of English and Women's Studies at Louisiana State University. Emily Toth, a Pulitzer Prize nominee, has published extensively on Kate Chopin since the late 1970s, including the influential biography *Unweiling Kate Chopin and Kate Chopin's Private Papers*. She is also founder and editor of *Regionalism and the Female Imagination* (formerly the *Kate Chopin Newsletter*). Toth's other books include *Inside Peyton Place: The Life of Grace Metalious*, *Ms. Mentor's Impeccable Advice for Women in Academia*, and *Ms. Mentor's New and Ever More Impeccable Advice for Women and Men in Academia*. Her Ms. Mentor advice column has been appearing in the *Chronicle of Higher Education* for more than a decade.



Student Leadership Workshops

Are you interested in learning more about the highly valued transferable skills you've acquired as a critical thinker and writer? Are you preparing to apply for graduate school and wonder what exactly a personal statement is? Would you like to share your successful and not-so-successful ways to retain and recruit members? Are you stumped on how to connect with other chapters in your region?

Leadership workshops are presented by Sigma Tau Delta Student Advisors (SAs), Student Representatives (SRs), Associate Student Representatives (ASRs), and Alumni Representatives (ARs).

Workshop 1: “English Majors Beyond English”

Thursday, March 1, 9:30 a.m. (Carondelet, 3rd floor)

Meet with current student leadership to discuss your anxieties about deciding on a career path, learn from participants who studied English and went into different fields, and brainstorm with participants on potential futures for English majors.

Ashlyn Wells, SR, Janine Brooks, SR, Deborah Dessaso, AR

Workshop 2: “Graduate School How-To”

Friday, March 2, 9:30 a.m. (Carondelet, 3rd floor)

Regardless of where you find yourself in the application process, from choosing schools, to writing a personal statement and writing sample, to already being in graduate school, this workshop is for you. Join our collaborative discussion on the anxieties and successes of graduate school.

Joseph Asbury, ASR, Allie Martin, ASR, MeKoi Scott, SR

Workshop 3: “Officers Roundtable”

Friday, March 2, 4:45 p.m. (Carondelet, 3rd floor)

Current and potential student leaders can attend this workshop to discuss various topics and concerns as well as connect with chapters within and outside of your region. This workshop is broad for a reason~ we want to hear what your needs and concerns are.

Alexandra Reznik, SA, and Kelsey Hixson-Bowles, SA

Workshop 4: “Building Interchapter Relations”

Saturday, March 3, 9:30 a.m. (Carondelet, 3rd floor)

Collaborating with chapters, especially when chapters are logistically far and funding is increasingly difficult to maintain, can pose a real challenge. In this workshop we will be discussing how chapters can effectively use more innovative ways to connect.

Sarah Faulkner, SR, Jolie Hicks, SR, Katherine Williams, ASR

Workshop 5: “Recruitment and Retention”

Saturday, March 3, 1:45 p.m. (Carondelet, 3rd floor)

Participating chapters will work collaboratively to create a “chapter mission” in order to explain to potential members what your chapter hopes to accomplish. We will be exchanging ideas on recruiting and retention practices that have been successful and what has not worked.

Amy Woody, SR, Karissa Hernandez, ASR, Nick Miller, ASR

Student Leadership Position Descriptions

Student Representative (SR)

A Student Representative (SR) shall be a student elected by the student members of his/her region to perform the following duties:

Regional Duties

1. Solicit input from members in the region regarding Society policies and activities.
2. Respond to concerns of students within region.
3. Regularly contribute to and aid in the production of regional and Student Leadership Committee publications, including writing feature articles.
4. Regularly solicit articles from members and chapters in your region for official Student Leadership Committee publications.
5. Regularly participate in any and all official regional and Student Leadership Committee communications and activities.
6. Contact Regent, Associate Student Representative (ASR), and Student Leadership Committee at least once a month.
7. Be available for possible visits to other chapters within region.
8. Work closely with Regent in planning regional conferences or other activities.
9. Keep a record of all correspondence during tenure.
10. Send a note of welcome to new and reactivating chapters within region.
11. Delegate a reasonable number of duties to the region's ASR.
12. Assist in training and coaching the region's succeeding SR and ASR.

International Board Duties

1. Attend all necessary Board and committee meetings.
2. Serve on Student Leadership and two other committees as appointed by Society President.
3. Aid in the development and implementation of the Leadership Workshop.
4. Submit an annual report to the Board.
5. Represent concerns of students within region to the Board.

International Convention Duties

1. Attend international convention.
2. Moderate regional meetings and activities.
3. Host official Student Leadership Committee activities, including the Leadership Workshop, social events, and other activities as necessary.
4. Introduce, preside, and/or moderate sessions and activities as designated by the convention chair.

Student Representatives shall serve a term beginning upon their election at the international convention and ending on June 1st of the following year. Candidates for Student Representative must meet the requirements and adhere to the guidelines outlined on the application and the Sigma Tau Delta Website. Each new Student Representative shall be given a letter of welcome from his/her Regent, including all addresses and phone numbers at which the Student Representative may contact the Regent. SRs are required to attend Board meetings and the international convention. Travel expenses for these events are funded by the Board.

Associate Student Representative (ASR)

An Associate Student Representative (ASR) shall be a student elected by the student members of his/her region. An Associate Student Representative's role will be primarily concerned with assisting the Student Representative in regional duties. The ASR will:

Regional Duties

1. Regularly contribute to and aid in the production of regional and Student Leadership Committee publications, including writing feature articles.
2. Solicit feedback from members in the region.
3. Fulfill responsibilities delegated by the Student Representative, including but not limited to: aiding Student Representative and Regent in responding to concerns of students within region; collaborating with the Student Representative on official publications; working closely with Regent and Student Representative to plan and facilitate cooperative activities among chapters in the region.
4. Contact Regent, Student Representative, and Student Leadership Committee at least once a month.
5. Be available for possible visits to other chapters within region.
6. Keep a record of all correspondence during tenure.

International Board Duties

1. Submit an annual report to the Student Leadership Committee and the Central Office.
2. Advise the Student Leadership Committee and Student Representative on the submission of annual reports to the Board.
3. Contact the Student Representative and Regent to report concerns of students within the region to the Board.
4. Serve on Student Leadership Committee and other Board committees as appointed.

International Convention Duties

1. If attending, assist with registration, regional meetings, panels, and convention activities when possible and appropriate.

If, as assessed by the Regent, the Student Representative should not be able to complete his/her duties, the Associate Student Representative will take over the position, title, and duties as specified by the Sigma Tau Delta Constitution/organization. Because the Associate Student Representative's duties are primarily regional, those elected to the position cannot be Board-funded to attend Board meetings or the international convention; however, some regional funding may be available to assist ASRs with travel to the international convention.

Alumni Leadership Position Descriptions

Alumni Representative (AR)

Requirements

1. The AR shall be a member of the Alumni Epsilon Chapter for one year prior to election.
2. The AR shall be elected for up to two consecutive one-year terms by Alumni Epsilon members during the alumni caucus at the annual international convention.
3. Candidates not elected to the AR position are eligible to run for the Associate Alumni Representative (AAR) position.
4. The AR shall attend Board meetings in a non-voting capacity.
5. The AR shall serve on the Alumni/International Committee and other Board committees as appointed.

Alumni Duties

1. Promote Alumni Epsilon membership.
2. Create and solicit content for online publications including an alumni blog/newsletter and journal.
3. Contribute an article to each international newsletter with suggestions to alumni on how to stay involved.
4. Promote community among alumni including welcoming new Alumni Epsilon members and encouraging alumni to continue to participate via local chapters and online networking.
5. Contact the Chair of the Alumni/International Committee and Associate Alumni Representative at least once a month.
6. Represent concerns of alumni to the Board.
7. Submit an annual report to the Board.

International Convention Duties

1. Attend international convention.
2. Assist the Chair of the Alumni/International Committee with the alumni caucus and an alumni social event at the convention.
3. Introduce, preside, and/or moderate sessions and activities as designated by the Convention Chair.

Associate Alumni Representative (AAR)

Requirements

1. The AAR shall be a member of the Alumni Epsilon Chapter. (Applicants may join at the convention if not already a member.)
2. The AAR shall be elected for up to two consecutive one-year terms by Alumni Epsilon members during the alumni caucus at the annual international convention.
3. The AAR shall serve on the Alumni/International Committee.

Alumni Duties

1. Contribute to and aid in the production of online publications created by the Alumni Representative (AR), including an alumni blog/newsletter and journal.
2. Aid AR in promoting Alumni Epsilon membership and community among alumni.
3. Contact the Chair of the Alumni/International Committee and AR at least once a month.
4. Assist AR to contribute an article to each international newsletter with suggestions to alumni on how to stay involved.

International Convention Duties

1. If attending, assist with registration.
2. If attending, help AR organize and moderate the alumni caucus and an alumni social event at the convention.

If, as assessed by the Chair of the Alumni/International Committee, and affirmed by Board consensus, the Alumni Representative should not be able to complete his/her duties, the Associate Alumni Representative will take over the position, title, and duties as specified by Sigma Tau Delta.

Because the Associate Alumni Representative duties are primarily to assist the Alumni Representative, those elected to the position cannot be Board-funded to attend Board meetings; however, a modest stipend may be provided to an active AAR who wishes to attend the international convention. The AAR will receive recognition for duties performed by being listed in alumni publications and on the Society's website (www.english.org).

General Business Session and Regional Caucuses

ATTEND + VOTE = \$200

Don't miss this opportunity to participate on the regional and national levels of Sigma Tau Delta. The annual convention is where our chapters elect Sigma Tau Delta's next generation of leaders. Every chapter with an official voting student delegate present at

- ✓ the chapter's Informal Regional Caucus (Thursday),
- ✓ the General Business Session (Friday), and
- ✓ the chapter's Regional Caucus (Friday)

is eligible to receive a \$200 reimbursement (\$400 for chapters not in the continental U.S.A.).

WHY attend the General Business Session and Regional Caucuses?

In addition to the financial incentive, this is an opportunity for students, Faculty Sponsors, and alumni **to participate in the governance of and planning for Sigma Tau Delta.** Participants will gain firsthand information on the Society's operations, meet the Board of Directors (Officers, Regents, Student Advisors) and the Student Representatives, and help shape the Sigma Tau Delta's future.

WHO should attend?

ALL convention attendees are urged to attend the General Business Session on Friday and the Thursday and Friday Regional Caucuses to get the inside scoop on who's who and what's happening in Sigma Tau Delta.

Each chapter gets one vote and appoints a student member as its official voting delegate. S/he casts the chapter's vote in any elections and on any business decisions made during the General Business Session and the Regional Caucuses. All chapter members may confer on this vote.

WHAT happens at these sessions?

At the General Business Session an official roll-call of chapters is taken. Sigma Tau Delta Officers give various brief reports and make important announcements concerning the Society. The Society's Officers are elected at this meeting. **Chapter members confer on all votes and the chapter's official voting student delegate casts the chapter's vote.**

On Thursday after the Awards Ceremony and on Friday after the General Business Session, chapters meet in their respective Regional Caucuses with their current Regent, Student Representative, and Associate Student Representative. This is an opportunity for chapters to meet students and faculty from other schools in their region. Chapters make some important decisions about what they would like to do in the region and provide suggestions for how they can deepen and expand their resources. The Regents, Student Representatives, and Associate Student Representatives are elected at the Regional Caucuses. Again, all chapter members confer on each vote and the chapter's official voting student delegate casts the chapter's one vote.

WHEN are these sessions held?

The **Informal Regional Caucuses** are on **Thursday , March 1, at 5.20 p.m.**, following the Awards Ceremony, and the **General Business Session** is on **Friday , March 2 at 11:00 a.m.**, followed by the Regional Caucuses.

HOW does a chapter receive a reimbursement check?

The **official voting student delegate must complete a form provided at the Informal Regional Caucus on Thursday and return it at the Regional Caucus following the General Business Meeting on Friday.** The official voting delegate (a) must be a student member and (b) must attend and participate in 1) the chapter's Informal Regional Caucus (Thursday), 2) the General Business Session (Friday), and 3) the chapter's Regional Caucus (Friday).

The same student must attend all three events. Chapters should decide ahead of time whether or not the \$200/\$400 should be used by the chapter's student delegate for his/her expenses or whether the money should be returned to the chapter treasury. Checks will be sent from the Central Office shortly after the convention. It is customary for delegates to provide their home chapters with a report on the convention (the business, the sessions, etc.).

2011 Chapter Anniversaries

Five

Alfred University	(Alpha Xi Upsilon), Alfred, NY
Augustana College	(Alpha Xi Mu), Sioux Falls, SD
Catawba College	(Alpha Xi Delta), Salisbury, NC
Chestnut Hill College	(Alpha Xi Beta), Philadelphia, PA
Ferris State University	(Alpha Xi Kappa), Big Rapids, MI
Gonzaga University	(Alpha Xi Tau), Spokane, WA
Grand View College	(Alpha Nu Phi), Des Moines, IA
High Point University	(Alpha Xi Xi), High Point, NC
Nevada State College	(Alpha Xi Zeta), Henderson, NV
Northwestern Oklahoma State University	(Alpha Nu Psi), Alva, OK
Our Lady of Holy Cross College	(Alpha Xi Nu), New Orleans, LA
Randolph College	(Alpha Xi Sigma), Lynchburg, VA
Saint Mary's College	(Alpha Xi Eta), Notre Dame, IN
Southern Wesleyan University	(Alpha Xi Lambda), Central, SC
Southwest Baptist University	(Alpha Nu Omega), Bolivar, MO
SUNY, Fredonia	(Alpha Xi Omicron), Fredonia, NY
Tusculum College	(Alpha Xi Theta), Greeneville, TN
University of Dubuque	(Alpha Nu Chi), Dubuque, IA
University of Montenegro	(Alpha Xi Chi), Podgorica, Montenegro
University of North Dakota	(Alpha Xi Alpha), Grand Forks, ND
University of Science and Arts of Oklahoma	(Alpha Xi Iota), Chickasha, OK
University of South Florida, St. Petersburg	(Alpha Xi Phi), St. Petersburg, FL
Wabash College	(Alpha Xi Gamma), Crawfordsville, IN
West Virginia State University	(Alpha Xi Rho), Institute, WV
Western State College of Colorado	(Alpha Xi Pi), Gunnison, CO
Wittenberg University	(Alpha Xi Epsilon), Springfield, OH

Ten

Arcadia University	(Alpha Kappa Eta), Glenside, PA
Cedarville University	(Alpha Kappa Delta), Cedarville, OH
Fairleigh Dickinson University	(Alpha Kappa Theta), Madison, NJ
Marymount University	(Alpha Kappa Gamma), Arlington, VA
Montana State University, Bozeman	(Alpha Kappa Zeta), Bozeman, MT
SUNY, College at Old Westbury	(Alpha Kappa Beta), Old Westbury, NY
Wilmington College	(Alpha Kappa Iota), Wilmington, OH
Western State College of Colorado	(Alpha Xi Pi), Gunnison, CO
Wittenberg University	(Alpha Xi Epsilon), Springfield, OH

Fifteen

Assumption College	(Alpha Zeta Beta), Worcester, MA
Azusa Pacific University	(Alpha Epsilon Tau), Azusa, CA
Biola University	(Alpha Zeta Theta), La Mirada, CA
Carroll College, Helena	(Alpha Zeta Epsilon), Helena, MT
Chapman University	(Alpha Zeta Iota), Orange, CA
College of Charleston	(Alpha Epsilon Phi), Charleston, SC
Flagler College	(Alpha Epsilon Omega), St. Augustine, FL
Gannon University	(Alpha Epsilon Upsilon), Erie, PA
Lincoln University, Pennsylvania	(Alpha Zeta Delta), Lincoln University, PA
Marygrove College	(Alpha Zeta Zeta), Detroit, MI
Troy University Dothan	(Alpha Zeta Gamma), Dothan, AL
University of Montana - Western	(Alpha Epsilon Iota), Dillon, MT
University of Tennessee, Knoxville	(Alpha Epsilon Chi), Knoxville, TN
Westmont College	(Alpha Zeta Kappa), Santa Barbara, CA
William Paterson University of New Jersey	(Alpha Epsilon Psi), Wayne, NJ

Twenty

Brigham Young University, Hawaii	(Alpha Beta Delta), Laie, HI
Clark Atlanta University	(Alpha Beta Beta), Atlanta, GA
Hampton University	(Alpha Beta Zeta), Hampton, VA
Hastings College	(Alpha Alpha Psi), Hastings, NE
Lee University	(Alpha Beta Iota), Cleveland, TN
Mercy College	(Alpha Alpha Phi), Dobbs Ferry, NY
North Georgia College and State University	(Alpha Beta Epsilon), Dahlonega, GA
University of Georgia	(Alpha Alpha Omega), Athens, GA
University of Missouri, St. Louis	(Alpha Beta Alpha), St. Louis, MO
Wingate University	(Alpha Beta Gamma), Wingate, NC
Xavier University of Louisiana	(Alpha Beta Eta), New Orleans, LA

Twenty-Five

Albany State University	(Zeta Phi), Albany, GA
California Polytechnic State University	(Sigma Upsilon), San Luis Obispo, CA
College of Saint Rose	(Beta Phi), Albany, NY
Eastern Oregon University	(Lambda Phi), La Grande, OR
Erskine College	(Xi Phi), Due West, SC
Illinois College	(Rho Phi), Jacksonville, IL
Jacksonville University	(Iota Upsilon), Jacksonville, FL
Louisiana State University, Shreveport	(Lambda Upsilon), Shreveport, LA
Loyola University Maryland	(Rho Upsilon), Baltimore, MD

2011 Chapter Anniversaries, continued

Twenty-Five, continued

Loyola University, New Orleans	(Omega Upsilon), New Orleans, LA
Mercer University	(Tau Upsilon), Macon, GA
Mesa State College	(Tau Phi), Grand Junction, CO
Northern Michigan University	(Eta Phi), Marquette, MI
Rider University	(Nu Phi), Lawrenceville, NJ
Saint Joseph's University	(Omicron Phi), Philadelphia, PA
San Diego Christian College	(Alpha Phi), El Cajon, CA
Suffolk University	(Eta Upsilon), Boston, MA
SUNY, University at Albany	(Theta Phi), Albany, NY
Texas A&M University, Kingsville	(Gamma Phi), Kingsville, TX
University of Houston	(Epsilon Phi), Houston, TX
University of Mount Union	(Upsilon Upsilon), Alliance, OH
University of Southern Indiana	(Mu Phi), Evansville, IN
Ursinus College	(Phi Upsilon), Collegeville, PA
Valparaiso University	(Kappa Phi), Valparaiso, IN

Thirty

Albion College	(Nu Pi), Albion, MI
Alvernia University	(Kappa Pi), Reading, PA
Birmingham-Southern College	(Beta Pi), Birmingham, AL
California State University, Long Beach	(Iota Pi), Long Beach, CA
College of Mount St. Joseph	(Phi Omicron), Cincinnati, OH
East Central University	(Upsilon Pi), Ada, OK
Hartwick College	(Gamma Pi), Oneonta, NY
Kennesaw State University	(Eta Pi), Kennesaw, GA
Lenoir-Rhyne University	(Epsilon Pi), Hickory, NC
Manhattan College	(Beta Pi), Riverdale, NY
Millikin University	(Lambda Pi), Decatur, IL
Mount Marty College	(Delta Pi), Yankton, SD
Pace University, New York Campus	(Tau Pi), New York, NY
Pace University, Pleasantville	(Sigma Pi), Pleasantville, NY
Paine College	(Sigma Omicron), Augusta, GA
Spring Hill College	(Omicron Pi), Mobile, AL
St. John's University	(Upsilon Omicron), Queens, NY
The Citadel	(Rho Pi), Charleston, SC
University of Memphis	(Psi Omicron), Memphis, TN
University of San Francisco	(Zeta Pi), San Francisco, CA
University of South Alabama	(Pi Pi), Mobile, AL
University of West Alabama	(Chi Omicron), Livingston, AL
University of West Georgia	(Pi Omicron), Carrollton, GA

Thirty-Five

Angelo State University	(Pi Nu), San Angelo, TX
Benedict College	(Sigma Nu), Columbia, SC
Bowie State University	(Nu Nu), Bowie, MD
Lehigh University	(Chi Nu), Bethlehem, PA
Miami University	(Phi Nu), Oxford, OH
Midland University	(Mu Nu), Fremont, NE
Morehouse College	(Upsilon Nu), Atlanta, GA
Norfolk State University	(Xi Nu), Norfolk, VA
Wofford College	(Tau Nu), Spartanburg, SC

Forty

Central Methodist University	(Mu Lambda), Fayette, MO
Eureka College	(Theta Lambda), Eureka, IL
Frostburg State University	(Epsilon Lambda), Frostburg, MD
Houston Baptist University	(Delta Lambda), Houston, TX
Lyon College	(Eta Lambda), Batesville, AR
Savannah State University	(Kappa Lambda), Savannah, GA
St. Augustine's College	(Lambda Lambda), Raleigh, NC
SUNY, College at Geneseo	(Iota Lambda), Geneseo, NY

Forty-Five

Bloomsburg University	(Theta Kappa), Bloomsburg, PA
Campbellsville University	(Upsilon Kappa), Campbellsville, KY
Cedar Crest College	(Xi Kappa), Allentown, PA
Marian University	(Kappa Tau), Fond du Lac, WI
Radford University	(Eta Kappa), Radford, VA
University of Charleston	(Iota Kappa), Charleston, WV
University of Richmond	(Kappa Kappa), University of Richmond, VA

Fifty

East Carolina University	(Omicron Theta), Greenville, NC
--------------------------	---------------------------------

Fifty-Five

Athens State University	(Kappa Zeta), Athens, AL
Carthage College	(Epsilon Zeta), Kenosha, WI
Lipscomb University	(Mu Zeta), Nashville, TN
Long Island University, Brooklyn	(Omicron Zeta), Brooklyn, NY
McNeese State University	(Pi Zeta), Lake Charles, LA
Texas Wesleyan University	(Nu Zeta), Fort Worth, TX
University of Louisiana, Lafayette	(Lambda Zeta), Lafayette, LA
University of Tampa	(Rho Zeta), Tampa, FL
University of Wisconsin, Eau Claire	(Theta Zeta), Eau Claire, WI

2011 Chapter Anniversaries, continued

Sixty

Florida Southern College (Psi Epsilon), Lakeland, FL
McMurry University (Phi Epsilon), Abilene, TX
Mount Mary College (Chi Epsilon), Milwaukee, WI

Seventy

Oklahoma Baptist University (Chi Delta), Shawnee, OK
Waynesburg University (Upsilon Delta), Waynesburg, PA
Western Illinois University (Phi Delta), Macomb, IL

Seventy-Five

Bowling Green State University (Kappa Delta), Bowling Green, OH
Illinois State University (Lambda Delta), Normal, IL
McKendree University (Iota Delta), Lebanon, IL
University of North Alabama (Theta Delta), Florence, AL

Eighty

Coker College (Pi Gamma), Hartsville, SC
Louisiana Tech University (Rho Gamma), Ruston, LA
Minnesota State University, Moorhead (Mu Gamma), Moorhead, MN
North Dakota State University (Omicron Gamma), Fargo, ND
Northern State University (Xi Gamma), Aberdeen, SD
University of Nebraska, Omaha (Kappa Gamma), Omaha, NE

Eighty-Five

Muskingum University (Omega Alpha), New Concord, OH
Peru State College (Phi Alpha), Peru, NE
Texas Christian University (Chi Alpha), Fort Worth, TX
University of Redlands (Upsilon Alpha), Redlands, CA
Washington University (Psi Alpha), St. Louis, MO



Are you graduating soon?

Do you hate saying "good-bye" to all of your Sigma Tau Delta friends?

Stay in touch by joining the Sigma Tau Delta Alumni Epsilon Chapter.

Membership Benefits:

- Continuing Affiliation
- Alumni Epsilon Scholarship
- Leadership Opportunities
- Convention Participation
- Alumni Epsilon Journal Publication Opportunity
- Annual Literary Journal Subscription

For More Information Attend:

Informal Alumni Caucus

Thursday, March 1, 5:20 p.m.
(Acadia /Bissonet, 3rd Floor)

Formal Alumni Caucus

Friday, March 2, 4:45 p.m.
(Napoleon, 41st Floor)

2011 Sponsor Anniversaries

Five

Alexander, Andy	Wayne State College	Kraus, Joe	University of Scranton
Andrews, Carol	Armstrong Atlantic State University	Krishnamurthy, Aruna	Fitchburg State College
Andrews, Christopher	McMurry University	Kunz, Heidi	Randolph College
Azuah, Unoma	Lane College	Luna, Alina	Western State College of Colorado
Barz, Jonathan	University of Dubuque	Mahoney, S. Margaret	College of Notre Dame of Maryland
Beard, Elizabeth	Louisiana State University at Alexandria	Marotte, Mary	University of Central Arkansas
Berman, Jeffrey	SUNY, University at Albany	McCarthy Donahue, Cathryn	College of Mount Saint Vincent
Blue, Bennis	Virginia State University	McClellan, Ann	Plymouth State University
Bobo, Elizabeth	University of Louisiana, Lafayette	McDonald, Kathleen	Norwich University
Bouchelle III, Joseph	Southern Virginia University	Montenegro, Patricia	Cheyney University
Brehm, Victoria	Grand Valley State University	Morrison, Sara	William Jewell College
Brown, Kevin	Lee University	Muoneke, Fr. Romanus	University of St. Thomas, TX
Brown, Brenda	University of Science and Arts of Oklahoma	Myers, Jeffrey	Manhattan College
Burmester, Beth	Georgia State University	Nelson, Mary	Dallas Baptist University
Burns, Christy	Jacksonville State University	Nigro, Marie	Lincoln University, Pennsylvania
Card, Orson	Southern Virginia University	Okun, Peter	Davis & Elkins College
Champagne, Claudia	Our Lady of Holy Cross College	Osborne, Jeffrey	Murray State University
Chan, May Caroline	College of Saint Rose	Parkinson, Michelle	University of Wisconsin, River Falls
Clark, Emily	University of the Incarnate Word	Parrish, Da'Tarvia	Livingstone College
Davis, James	Troy University	Pearson, John	Southern Virginia University
del Gizzo, Suzanne	Chestnut Hill College	Persak, Christine	Ferris State University
Diala-Ogamba, Blessing	Coppin State University	Petree, Sandra	Northwestern Oklahoma State University
DiBiasio, Becky	Assumption College	Piacentino, Ed	High Point University
Easley, Rex	Thomas More College	Reed, Kimberly	Lipscomb University
Elliott, Winter	Brenau University	Rotunno, Laura	Penn State Altoona
Enchelmayer, Ernest	Arkansas Tech University	Ruud, Jay	University of Central Arkansas
Friedman, Paula	Cardinal Stritch University	Ryan, Brenda	Northwest Missouri State University
Fuller, Janice	Catawba College	Schleifer, Paul	Southern Wesleyan University
Genre, Chris	Southeastern Louisiana University	Schroeder, David	Catawba College
Goodman, Thomas	University of Miami	Sebastian, John	Loyola University, New Orleans,
Gray, Juliana	Alfred University	Seligmann Schumann, Nancy	Siena Heights University
Griffin, Eric	Millsaps College	Shields, Paul	Assumption College
Gussman, Deborah	Richard Stockton College of New Jersey	Siegel, Daniel	University of Alabama, Birmingham
Haigwood, Laura	Saint Mary's College	Smith-Spears, Rashell	Jackson State University
Hamill, Thomas	Wilkes University	Spencer, Bill	Western Carolina University
Harthorn, Steven	Williams Baptist College	Stackhouse, Amy	Iona College
Hathcock, Nelson	Saint Xavier University	Stodnick, Jackie	University of Texas, Arlington
Henry, Jonita	Livingstone College	Tegan, Mary Beth	Saint Xavier University
Hill-Stanford, Holly	Southwest Baptist University	Thayer, J. D.	Gonzaga University
Hinson, Scot	Wittenberg University	Thomas, Brenda	LaGrange College
Hrach, Susan	Columbus State University	Thompson, Becky	North Greenville University
Huse, Heidi	University of Tennessee, Martin	Toliver, Cliff	Missouri Southern State University, Joplin
Iglesias, Luis	University of Southern Mississippi, Hattiesburg	Travis, Molly	Tulane University
Jackson, Jennifer	North Central College	Vegter, Mark	Illinois State University
Jones, Keith	Northwestern College	Vonrosk, Nancy	Mount Saint Mary College
Jones-Jones, A. Giselle	Bennett College for Women	Weaver-Hightower, Rebecca	University of North Dakota
Khader, Jamil	Stetson University	Wilson, Lillie	Elizabeth City State University
Knepper, Marty	Morningside College	Wilson, David	West Virginia State University
Knezevic, Marija	University of Montenegro	Wright, Susan	Clark Atlanta University
Knotts, Rebecca	University of Montana - Western	Yermolenko, Galina	DeSales University

2011 Sponsor Anniversaries, continued

Ten

Anderson, Antje	Hastings College
Ayers, Carolyn	St. Mary's University, Minnesota
Brown, Sarah	University of Mary Hardin-Baylor
Burr, Sandra	Northern Michigan University
Carter, Steven	Georgetown College
Cassidy, Mary	South Carolina State University
Chatha, Diljit	Prairie View A&M University
Early, Julie	University of Alabama, Huntsville
Farnan, Christine	Siena College
Hudson, Julie	Huston-Tillotson University
Jackson, Jocelyn	Morehouse College
Keeling, Kara	Christopher Newport University
Lutz, Mary	Frostburg State University
McDowell Cook, Ruth	Milligan College
Morgan, Gwendolyn	Montana State University, Bozeman
Patton, Cynthia	Emporia State University
Ventre, Raymond	Northern Michigan University
Ware, Michele	North Carolina Central University
Wilfong, Peggy	Cedarville University
Wu, Yung-Hsing	University of Louisiana, Lafayette

Fifteen

Lonchar, Patricia	University of the Incarnate Word
Midkiff, Sheri	Williams Baptist College
Mundy-Shepard, Rosemarie	Albany State University
Neal, William	Campbellsville University
Stemmler, Kevin	Clarion University
Tackach, James	Roger Williams University
Walker, Victor	East Stroudsburg University
Woodard, Loretta	Marygrove College

Twenty

Bryson, Ralph	Alabama State University
Carlson, Kathleen	Franklin College
Moran, Michael	University of Georgia
Parry, Sally	Illinois State University
Purdon, Liam	Doane College
Scott, Alcyone	Midland University

Twenty-Five

Little, Joan	Erskine College
McKinley, Marlene	Suffolk University
Rosenstein, Roy	The American University of Paris
Walters, Doris	Missouri Southern State University

Thirty

DeMeo, Beth	Alvernia University
Rhodes, Jack	The Citadel

Thirty-Five

Sager, Nelson	Sul Ross State University
---------------	---------------------------

**Name Badge Pouches
Generously Contributed By**

**Steven Barclay
Agency**



www.barclayagency.com

Board of Directors, Student Leadership, and Central Office

Executive Committee

President: Sidney Watson

Oklahoma Baptist University (OK)

Vice President/President Elect: Sarah Dangelantonio

Franklin Pierce University (NH)

Immediate Past President: Robert Crafton

Slippery Rock University (PA)

Secretary/Treasurer: Shannin Schroeder

Southern Arkansas University (AR)

Historian: Carrie Fitzpatrick

Alvernia University (PA)

Editor of Publications: Karlyn Crowley

St. Norbert College (WI)

Executive Director: William C. Johnson (ex officio)

Director of National English Honor Society (NEHS):

Dave Wendelin (ex officio)

Regents

Eastern: Glen Brewster

Westfield State College (MA)

Far Western: Julianne Smith – Interim

Pepperdine University (CA)

High Plains: B. Lee Miller

Chadron State College (NE)

Midwestern: John Kerrigan

Rockhurst University (MO)

Southern: Roger Stanley

Union University (TN)

Southwestern: Victoria Gaydosik

Southwestern Oklahoma University (OK)

Student Advisors

Alexandra Reznik

Duquesne University (PA)

Kelsey Hixson-Bowles

Kansas State University (KS)

Alumni Representative/ Associate Alumni Representative

Deborah Dessaso (AR)

Alumna of University of the District of Columbia, Washington, DC

Lauren Brandeberry (AAR)

Alumna of University of Central Oklahoma (OK)

Student Representatives/ Associate Student Representatives

Eastern Region

Amy Woody (SR)

Westfield State University (MA)

Vacant (ASR)

Far Western Region

Sarah Faulkner (SR)

Chapman University (CA)

Joseph Asbury (ASR)

Utah State University (UT)

High Plains Region

Janine Brooks (SR)

University of Nebraska, Omaha (NE)

Nick Miller (ASR)

Chadron State College (NE)

Midwestern Region

Ashlyn Wells (SR)

University of Wisconsin, Eau Claire (WI)

Karisa Hernandez (ASR)

Rockhurst University (MO)

Southern Region

MeKoi Scott (SR)

Auburn University, Montgomery (AL)

Allie Martin (ASR)

Freed-Hardeman University (TN)

Southwestern Region

Jolie Hicks (SR)

Southwestern Oklahoma State University (OK)

Katherine Williams (ASR)

Arkansas Tech University (AR)

Central Office

Executive Director: William C. Johnson

Director of Communications and Chapter Development: Deb Seyler

Director of National English Honor Society (NEHS): Dave Wendelin

Office Manager: Karen Larsen

Web Facilitators: Elfi Gabriel and Josh Wilkin

Projects Coordinator: Lauren Brandeberry

Where to Eat in NOLA: Recommendations from the Board

Acme Oyster House

724 Iberville Street (3 blocks)

Recommended by: John Kerrigan, Midwestern Regent

What he ate: A New Orleans Medley dinner that included a sampling of gumbo, jambalaya, red beans & rice and grilled smoked sausage, for \$12.99.

Comments: www.acmeoyster.com

Cafe Du Monde

1039 Decatur Street (8 blocks)

Recommended by: John Kerrigan, Midwestern Regent

What he ate: About \$5-6 for coffee and three beignets (little pastries or donuts covered with powdered sugar).

Comments: "Great for breakfast or late night, but a world-famous place that always has a good crowd."

Recommended by: Allie Reznik, Student Advisor

What she ate: Beignets (\$3) and Iced Cafe Au Lait (\$3)

Comments: "Cafe Du Monde's French Market location is a traditional coffee shop open 24 hours. While their menu offers dark roasted coffee and chicory, coffee black, au lait or iced, white and chocolate milk and fresh squeezed orange juice, they are most famous for beignets. The square French-style doughnuts are lavishly covered in at least an inch of powdered sugar."

Central Grocery

923 Decatur Street (7 blocks)

Recommended by: John Kerrigan, Midwestern Regent

What he ate: A muffaletta sandwich at \$7 for a half sandwich, which was full-sized!

Comments: "This is where the muffaletta originated."

Court of Two Sisters

613 Royal St (6 blocks)

Recommended by: Allie Reznik, Student Advisor

What I ate: Shrimp and grits (\$32)

Comments: "Enjoy an exquisite, formal New Orleans Cajun dinner in a charming open air courtyard. The menu choices widely vary from chicken, beef to seafood options. Prices range from \$20 and up."

Crescent City Brewhouse

527 Decatur Street (5 blocks)

Recommended by: Shannin Schroeder, Convention Chair

What she ate: Spring rolls (\$9), ahi tuna on a green salad (\$14), and a fruit and chocolate mousse dessert (\$6)

Comments: "The only brew pub in town, Crescent City offers everything from sandwiches, salads, and beer samplers to baby-back ribs and seafood entrees. There was live music on Saturday night, and it's also very large, with an entire second level of seating. Our party of nine got in quickly, and everyone had very good things to say about the food and the service. With a price range from \$10-\$25, this restaurant offers excellent food for a number of budgets."

Fast food within one block:

**Arby's, Popeye's Chicken,
Starbucks**

...within two blocks:

McDonald's, Subway

...within three blocks:

**Quiznos, Domino's, IHOP,
Krystal**

Where to Eat in NOLA, continued

Mother's Restaurant

401 Poydras Street (6 blocks)

Recommended by: Janine Brooks, High Plains Region Student Representative

What she ate: Shrimp Dinner consisting of a hefty portion of small-sized fried shrimp (can be grilled), Red Beans & Rice (and it wasn't spicy!), and Potato Salad (Total Cost: \$15.00). Kept me full all through the afternoon and night.

Comments: "We were able to sit 8-9 of us around a table. Lots of room to accommodate its customers. A long-time family owned restaurant/sandwich shop famous for its baked ham used in many of its sandwiches and po'boys. You can also get breakfast such as a crawfish omelet or eggs/grits. If you want fried chicken there is a 25-minute wait. The line was long for placing an order; we had to wait a few minutes before being let in. But once inside, the line moved quickly and our orders were quickly taken by the cashier. Food was served hot and quick ~ and it was good!"

Recommended by: Deborah Dessao, Alumni Epsilon Representative

What she ate: The crawfish etouffee omelet

Comments: "Simply scrumptious!"

Napoleon House

500 Chartres Street (4 blocks)

Recommended by: Shannin Schroeder, Convention Chair

What she ate: Red beans and rice with smoked sausage (\$7) and shared a cheese and bread sampler (\$9)

Comments: "Napoleon House is rich in history, and both the building and the menu offer an authentically New Orleans experience, with menu items like muffalettas and jambalaya. We were seated in the courtyard, and our large group shared several appetizers because the menu prices were so reasonable. A local lead us to this one, and we weren't disappointed. The entrees run less than \$10."

Papa's Pizza

123 Chartes St., Phone #504-528-7300 (1 block)

Recommended by: Elfi Gabriel, Web Facilitator

What she ate: Sandwiches \$4.99 - \$7.99 (i.e., \$4.99 for a 6 inch sub and \$7.99 for a 12 inch sub), \$4.99 for a personal pizza (carryout only). Lasagna or Spaghetti meal with side salad and garlic bread is \$9.99.

Comments: "This pizza place sells pizza whole and by the slice, as well as subs, salads, and gyros. The owner will do a deal for multiple pizzas delivered to the New Orleans Marriott; ask the hotel management about this. Papa's Pizza has only a few places to sit, but it also offers take-out."

Pinkberry

300 Canal St. P (2 blocks)

Recommended by: Karlyn Crowley, Publications Editor

Comments: Link: www.pinkberry.com. "This location is open till 11:00 p.m. & 1:00 a.m. weekends."

Red Fish Grill

115 Bourbon Street (2 blocks)

Recommended by: Allie Reznik, Student Advisor

What she ate: Two course lunch with Alligator Sausage and Seafood Gumbo, Grilled Cobia (\$17), Double chocolate bread pudding (\$9)

Comments: "Red Fish Grill is an award-winning casual New Orleans seafood restaurant located at the gateway to the French Quarter, just one block off of Canal Street."

Stanley

547 Saint Ann St. (7 blocks)

Recommended by: Roger Stanley, Southern Regent

What he ate: Great breakfast fare.

Comments: "Located on Jackson Square in the French Quarter, this restaurant is named after Stanley Kowalski from *A Streetcar Named Desire*."

About New Orleans

Heads Up About New Orleans:

No other city in the world manages special events, crowd control and visitor safety as well as New Orleans.

New Orleans welcomes approximately eight million visitors per year and is known for the safe and successful management of major tourism events such as Mardi Gras, Jazz and Heritage Festival, cultural celebrations, professional and college football championship games and special sports events such as the NBA All Star Game. The world's most prominent corporations and associations select New Orleans for conferences and business events ranging from a 10-person corporate board meeting to large association city-wide conventions with tens of thousands of attendees from around the world.

Mardi Gras typically draws one million revelers to the streets of New Orleans every year. The 2010 French Quarter Festival in April 2010 had record attendance of 512,000 people and the 2010 Essence Music Festival had approximately 400,000 attendees over the three-day weekend.

Superintendent Ronal W. Serpas, Ph.D., took over leadership of the New Orleans Police Department in May 2010. Under his leadership, the NOPD has made significant changes in the popular tourist areas of New Orleans such as the French Quarter, Downtown/Central Business District, Uptown, Garden District, Magazine Street, Warehouse/Arts District, Convention Center Boulevard and Faubourg Marigny.

Visitors to New Orleans can expect:

New Orleans' popular tourist areas are among the most safe and walkable places for visitors of any city in America. Crime exists in all major cities. In New Orleans, the vast majority of violent crime is targeted criminal-on-criminal drug and retaliation acts which occur in inner-city neighborhoods. As with any destination, we recommend that vacationers and convention attendees practice common sense and do not wander into deserted, non-tourist areas of the city.

Reprinted from the New Orleans Convention & Visitors Bureau website, www.neworleanscvb.com

Rock 'n' Roll Marathon Series

The Rock 'n' Roll Marathon Series, a marathon and half-marathon, is scheduled to begin at 7.a.m. on Sunday, March 4. The course runs near the hotel. Please plan extra time for travelling to the airport.

Convention Twitter Contest

Make new friends and network with other convention attendees, get insider tips and tricks on the best convention events, and compete to win fabulous prizes!

Three easy steps!

1. Send an email with your name, chapter, email address, and twitter username to lbrandeberry@niu.edu. You must do this to enter.
2. Follow @EnglishCon on twitter to get news about convention and the twitter contest.
3. From now until Monday, March 5, include the keyword @EnglishCon in any tweet to enter it into the contest. Tell us about your convention experience. Follow other convention attendees, and share interesting things by retweeting. Make friends, make plans, have fun.

Prizes will be awarded to the most active and the most popular participants. Links to complete contest rules and a list of other contestants may be found at <http://twitter.com/EnglishCon>



Attend and Tweet About Popular Events

These perennial favorites, sponsored by Student Leadership, are sure to be the events with the most tweets!

Student Leadership Workshops

all workshops are held in Cardolet, 3rd floor

Workshop 1: “English Majors Beyond English”
Thursday, March 1, 9:30 a.m.

Workshop 2: “Graduate School How-To”
Friday, March 2, 9:30 a.m.

Workshop 3: “Officers Roundtable”
Friday, March 2, 4:45 p.m.

Workshop 4: “Building Interchapter Relations”
Saturday, March 3, 9:30 a.m.

Workshop 5: “Recruitment and Retention”
Saturday, March 3, 1:45 p.m.

Open Mic

Wednesday, February 29, 9:30-10:30 p.m.
Mardi Gras Ballroom, 3rd floor

Dry T-Shirt/Bad Poetry Contests

Thursday, March 1, 9:00-10:30 p.m.
Acadia/Bissonet, 3rd floor

Resume Writing Workshop

Hosted by Alumni Epsilon
Friday, March 2, 3:15-4:30
Carondelet, 3rd floor

Sigma Tau Delta Journals

The Sigma Tau Delta Review (founded in 2005) is an annual journal that publishes critical essays on literature, essays on rhetoric and composition, and essays devoted to pedagogical issues. Manuscripts should not exceed 3,000 words, but exceptions will be made for essays of stellar quality. Critical essays must follow the Modern Language Association style guidelines as defined in the *MLA Handbook for Writers of Research Papers* (latest edition).

The Sigma Tau Delta Rectangle (founded in 1931) is an annual journal that publishes literary non-fiction, fiction, and poetry. Submissions by a single author for each issue of the journal should not exceed three pieces of prose and six poems. Prose manuscripts should not exceed 2,500 words.



2013 Journal Submissions

Submissions for the 2013 journals will be accepted between April 9 and May 14, 2012.

For more information go to:

<http://www.english.org/sigmatd/publications/journals/>

***The Rectangle* and *The Review* Writing Award Winners for 2012**

Judson Q. Owen Award for Best Piece Overall

Wil Norton, Rho Mu Chapter, Oklahoma Christian University, OK

Frederic Fadner Critical Essay Award

Wil Norton, Rho Mu Chapter, Oklahoma Christian University, OK

Eleanor B. North Poetry Award

Ainsley Kelly, Phi Phi Chapter, Santa Clara University, CA

Herbert Hughes Short Story Award

Sarah Tarkany, Alpha Epsilon Phi Chapter, College of Charleston, SC

Elizabeth Holtze Creative Nonfiction Award

Margaret O'Brien, Alpha Alpha Pi Chapter, Alma College, MI

***The Rectangle* Reading**

Attend the readings of authors published in the 2012 edition of *The Rectangle*.

Wednesday, February 29

8:30-9:30 p.m.

Mardi Gras

Ballroom, 3rd floor

English Honor Societies

Sigma Tau Delta, the International English Honor Society, was established in 1924 to confer distinction upon students of the English language and literature in undergraduate, graduate, and professional studies. Through local chapters at colleges and universities in the United States, Europe, the Middle East, and the Caribbean, the Society provides cultural stimulation on campus and conducts community service projects that foster literacy and all aspects of the discipline of English, including literature, language, and writing. With more than 800 active chapters and more than 1,100 Faculty Sponsors, approximately 9,500 new members are inducted annually. Sigma Tau Delta is a member of the Association of College Honor Societies (ACHS), and the proud sponsor of the National English Honor Society (NEHS). www.english.org



Sigma Kappa Delta (SKD), the English Honor Society for two-year colleges, functions much like Sigma Tau Delta. Membership benefits include prestige of membership in a national honor society, eligibility to apply for scholarships and awards, leadership opportunities, and fellowship among members on a local, regional, and national level who share an interest in literature, the English language, and fine arts. Sigma Kappa Delta has 100 chapters, and annually partners with Sigma Tau Delta to plan and promote the international convention. www.english2.org



The National English Honor Society (NEHS), founded and sponsored by Sigma Tau Delta, is the only national organization exclusively for high school students and faculty who, in the field of English, merit special recognition for past and current accomplishments. Individual high schools are invited to petition for a local chapter, through which individuals may be inducted into Society membership. Immediate benefits of affiliation include national recognition, scholarship eligibility, and opportunities for national networking with others who share enthusiasm for, and accomplishment in, the language arts. Since its inception in 2005, NEHS has formed nearly 500 chapters and currently enrolls 11,000 members annually. www.nehs.org

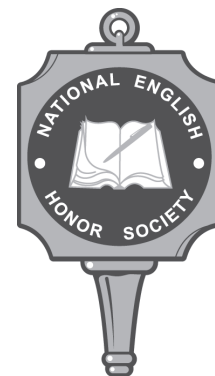

2013 Convention and Common Reader

OPEN BOOK

PORTLAND, OREGON

SIGMA TAU DELTA

2013 INTERNATIONAL CONVENTION

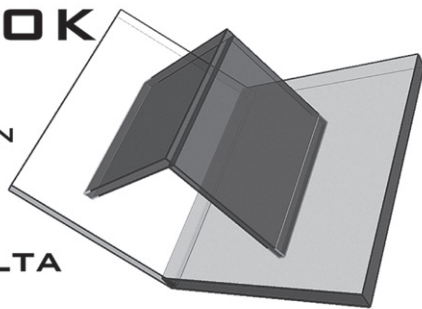

March 20 - 23, 2013

**Hilton Portland & Executive Tower
Portland, Oregon**

What do you see in the image above? An open book? A journal? A tablet? An e-book? Mountains and valleys? A dialogue between books? Open your imagination to consider the myriad of possibilities suggested by the image above and by the 2013 theme of *OPEN BOOK*. Those two words, *OPEN BOOK*, might be a command to read. Or are they a call to literacy? A description of an object? An assertion of transparent agendas? A statement against censorship? A promise of open minds?

Join us in Portland, Oregon, to think, talk, hear, and write about all of the topics raised by the above image and the theme of *OPEN BOOK*.

Gloria J. Hochstein
2013 Convention Chair.

Visual Image by Chen Zhang

2013 Common Reader

Ex Libris: Confessions of a Common Reader.
by Anne Fadiman

This delicious collection of essays offers a buffet of witty, thoughtful, learned, and profound essays about reading, literacy, words, books, and the people who savor language, literature, and books. With essays such as “The Literary Glutton,” “The Joy of Sesquipedalians,” and “Never Do That to a Book,” this collection has something entertaining and enlightening for every connoisseur of words and reading. Anne Fadiman will be a keynote speaker at the convention in Portland, Oregon, in 2013. Consider trying for one of the 2013 Convention awards for papers on the Common Reader. Pick up your copy now at the Better World Books table in the registration area.

Regents’ Common Reader Awards

Chapters can receive \$100 for organizing and hosting a local event or activity around the 2013 Common Reader: *Ex Libris: Confessions of a Common Reader Ex Libris* by Anne Fadiman. Chapter members do not need to attend the convention to apply for a Regents’ Common Reader Award. After the event, chapters simply apply for the award money, following the guidelines posted at www.english.org. Award applications should be emailed on or before March 6, 2013, to the appropriate Regent.

Convention Notes:

Convention Notes:

Convention Notes